

PFAFF

-900/56

-900/61

Service Manual

for 440-R, 1440, 420
and 1420
series machines

1	Safety	3
1.01	General notes on safety	3
1.02	Safety symbols	4
1.03	Important points for the user	4
1.04	Operating and specialist personnel	4
1.04.01	Operating personnel	4
1.04.02	Specialist personnel	5
1.05	Warning	5
2	Adjustment	6
2.01	Tools, gauges and other accessories	6
2.02	Notes on the adjustments	6
2.03	Abbreviations	6
2.04	Explanation of the symbols	6
3	Tension release trip	7
4	Solenoid bracket	8
4.01	Solenoid bracket on -900/56	8
4.02	Solenoid bracket on -900/61	9
5	Engaging lever pin	10
6	Eccentric pin of catcher control lever on -900/61 only	11
7	Control cam and locking bracket	12
7.01	Axial position of crank lever	12
7.02	Radial position of control cam	13
7.03	Locking bracket	14
8	Engaging solenoid	15
9	Stop lug	16
10	Catcher actuating lever	17
11	Catcher connecting rod (two-needle machines)	18
12	Catcher height	19
13	Thread catcher rest position	20
14	Knife height	21
15	Knife pressure	22
16	Bobbin thread trapper spring	23
17	Needle thread tension release	24
18	Synchronisizer	25
19	Manual trimming test	26

1 Safety

1.01 General notes on safety

- This machine may only be operated by adequately trained operators and only after having completely read and understood the Instruction Manual.
- All Notes on Safety and Instruction Manuals of the motor manufacturer are to be read before operating the machine!
- Pay attention to all warnings and safety instructions mounted on the machine!
- This machine may only be used for the purpose for which it is intended and may not be operated without its safety devices. All Safety Regulations relevant to its operation are to be adhered to.
- When exchanging sewing tools (e.g. needle, presser foot, needle plate, feed dog or bobbin), when threading the machine, when leaving the machine unattended and during maintenance work, the machine is to be separated from the power supply by switching off the On/Off switch or by removing the plug from the mains!
- Everyday maintenance work is only to be carried out by appropriately trained personnel!
- Repairs and special maintenance work may only be carried out by qualified service staff or appropriately trained personnel.
- When servicing or carrying out repairs on pneumatic devices, the machine is to be removed from the compressed air supply. The only exceptions to this are adjustments and function checks carried out by appropriately trained personnel!
- Work on electrical equipment may only be carried out by appropriately trained personnel!
- Work is not permitted on parts and equipment which are connected to the power supply. Exceptions to this are in accordance with the regulations EN 50110.
- Modifications and alterations to the machine may only be carried out under observance of all the relevant safety regulations!
- Only spare parts which have been approved by us are to be used for repairs!
We expressly point out that any replacement parts or accessories which are not supplied by us have not been tested and approved by us. The installation and / or use of any such products can lead to negative changes in the construction characteristics of the machine. We shall not be liable for any damage which may be caused by non-original parts.

1.02 Safety symbols



Danger!
Points to be observed.



Danger of injury for operating and specialist personnel!

1.03 Important points for the user

- This Instruction Manual is a component part of the machine and must be available to the operating personnel at all times.
The Instruction Manual must be read before operating the machine for the first time.
- The operating and specialist personnel is to be instructed as to the safety equipment of the machine and regarding safe work methods.
- It is the duty of the operator to only operate the machine in perfect running order.
- It is the obligation of the operator to ensure that none of the safety mechanisms are removed or deactivated.
- It is the obligation of the operator to ensure that only authorised persons operate and work on the machine.

Further information can be obtained at your PFAFF agent.

1.04 Operating and specialist personnel

1.04.01 Operating personnel

Operating personnel are persons responsible for the equipping, operating and cleaning of the machine as well as taking care of faults arising in the sewing area.

The operating personnel is obliged to observe the following points and must:

- always observe the Notes on Safety in the Instruction Manual!
- never use any working methods which could limit the level of safety in using the machine!
- not wear loosely fitting clothing or jewellery such as chains or rings!
- also ensure that only authorised persons have access to the potentially dangerous area around the machine!
- always immediately report to the person responsible any changes in the machine which may limit its safety!

1.04.02 Specialist personnel

Specialist personnel are persons with a specialist education in the fields of electrics, electronics and mechanics. They are responsible for the lubrication, maintenance, repair and adjustment of the machine.

The specialist personnel is obliged to observe the following points and must:

- always observe the Notes on Safety in the Instruction Manual!
- switch off the On/Off switch before carrying out adjustments or repairs and ensure that it cannot be switched on again unintentionally!
- never work on parts which are still connected to the power supply. Exceptions are contained in the regulations EN 50110.
- when servicing or carrying out repairs on pneumatic devices, remove the machine from the compressed air supply. The only exceptions to this are function checks.
- replace the protective coverings and close the electrical control box after all repairs or maintenance work!

1.05 Warning



While sewing keep your hands away from the needle area!
Danger of injury by the needle!



When making adjustments do not leave any objects on the tabletop or in the needle plate area! Objects could become clamped or slung away!
Danger of injury!



To adjust this unit the machine must be tipped to the back!
Use **both** hands when setting the machine upright! Danger of clamping between machine and tabletop!

2 Adjustment

Special attention should be paid to the following

This service manual is valid for the subclasses -900/56 and -900/61 for the PFAFF 440-R; 1440; 420 and 1420 series of machines.

The PFAFF 442-R two needle version is illustrated.

The text refers to the single needle version. Notice of additional adjustments for the two needle machines are marked as such in the corresponding sections. Deviations in the illustration have no influence on the adjustments.

2.01 Tools, gauges and other accessories

- Screwdrivers with blade width from 2 to 10 mm
- Wrenches from 7 to 14 mm (across flats)
- Hexagon keys, 1.5 to 6 mm
- Metal rule (Part No. 08-880 218-00)
- Continuity tester
- Sewing thread and test material
- Feeler gauge

2.02 Notes on the adjustments

All adjustments in this manual apply to the fully assembled machine. Machine covers which have to be removed and re-fitted for checks and adjustments are not mentioned in the text. Screws or nuts in brackets () must be loosened before an adjustment and tightened again afterwards.

2.03 Abbreviations

t.d.c. = top dead center

b.d.c. = bottom dead center

2.04 Explanation of the symbols



Note, information

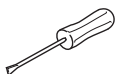

Servicing, adjustment

3 Tension release trip

Requirement

When the broadest part of trip 5 is aligned with tension trip 6, with the control cam in resting position and the presser foot lowered, there must be a clearance of roughly 1 mm between the left side of trip 5 and tension release trip 6.

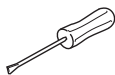
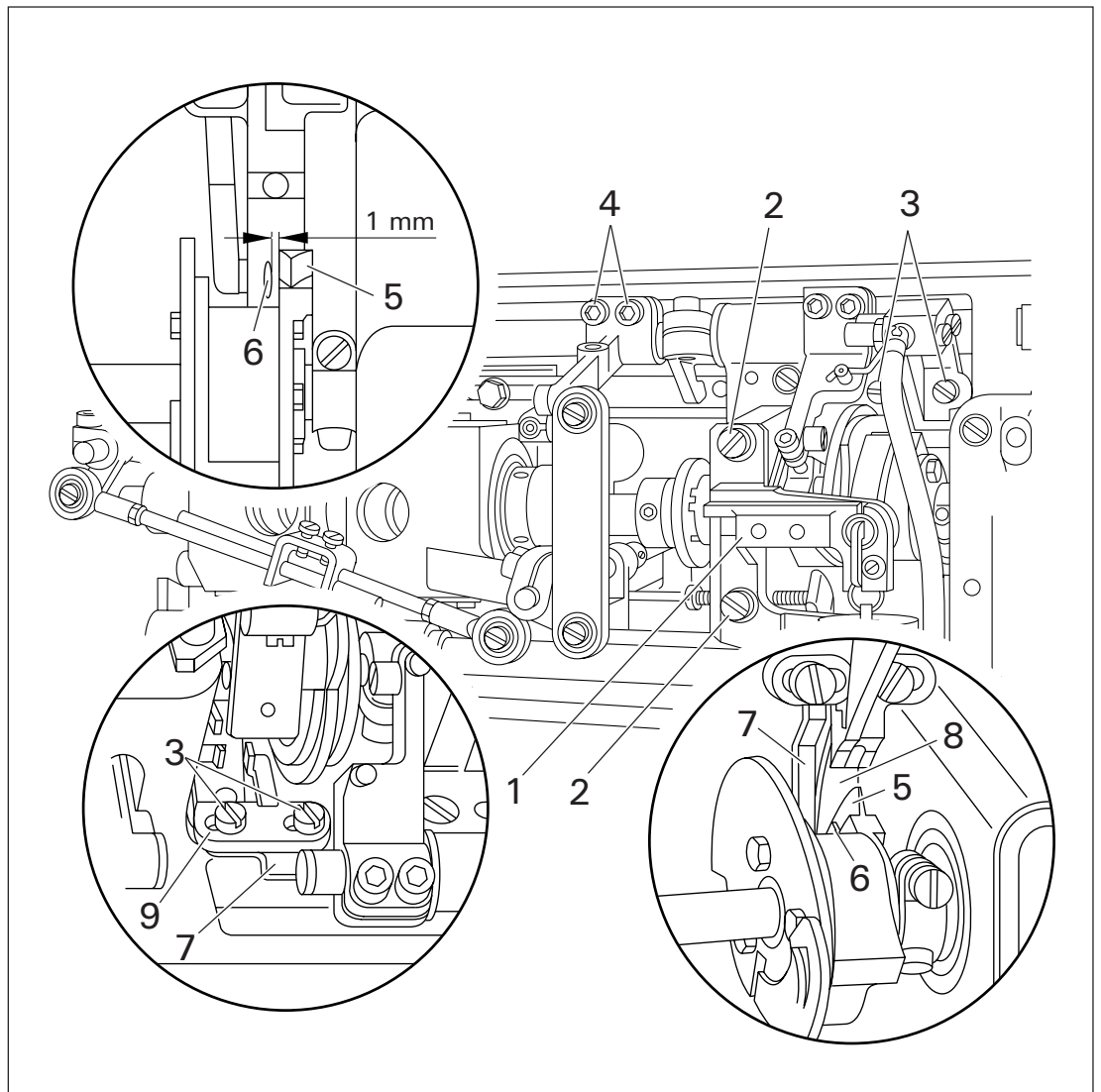

- Remove solenoid bracket 1 (screws 2)
- Loosen screws 3 and for more extensive adjustments, also screws 4.
- Turn balance wheel until the widest part of trip 5 is aligned with tension release trip 6.
- Adjust lateral position of stop finger 7 according to the requirement.
- In this position, make sure that stop finger 7 is in contact with bracket 8, move bracket 9 of release trip fully to left in elongated hole and tighten both screws 3.
- Check this adjustment according to the requirement.
- If more extensive adjustments are to be made, screws 4 should remain loose until the catcher actuating lever is adjusted.
- For adjusting the solenoid bracket 1 only lightly tighten screws 2 (chap. 4).

Adjustment

4 Solenoid bracket

4.01 Solenoid bracket on -900/56

Requirement

When the tip of trip 1 is aligned with control pin 2 and the engaging lever has been operated, there must be a clearance of roughly 0.5 mm between the left inside of control cam 7 and control pin 6.

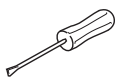
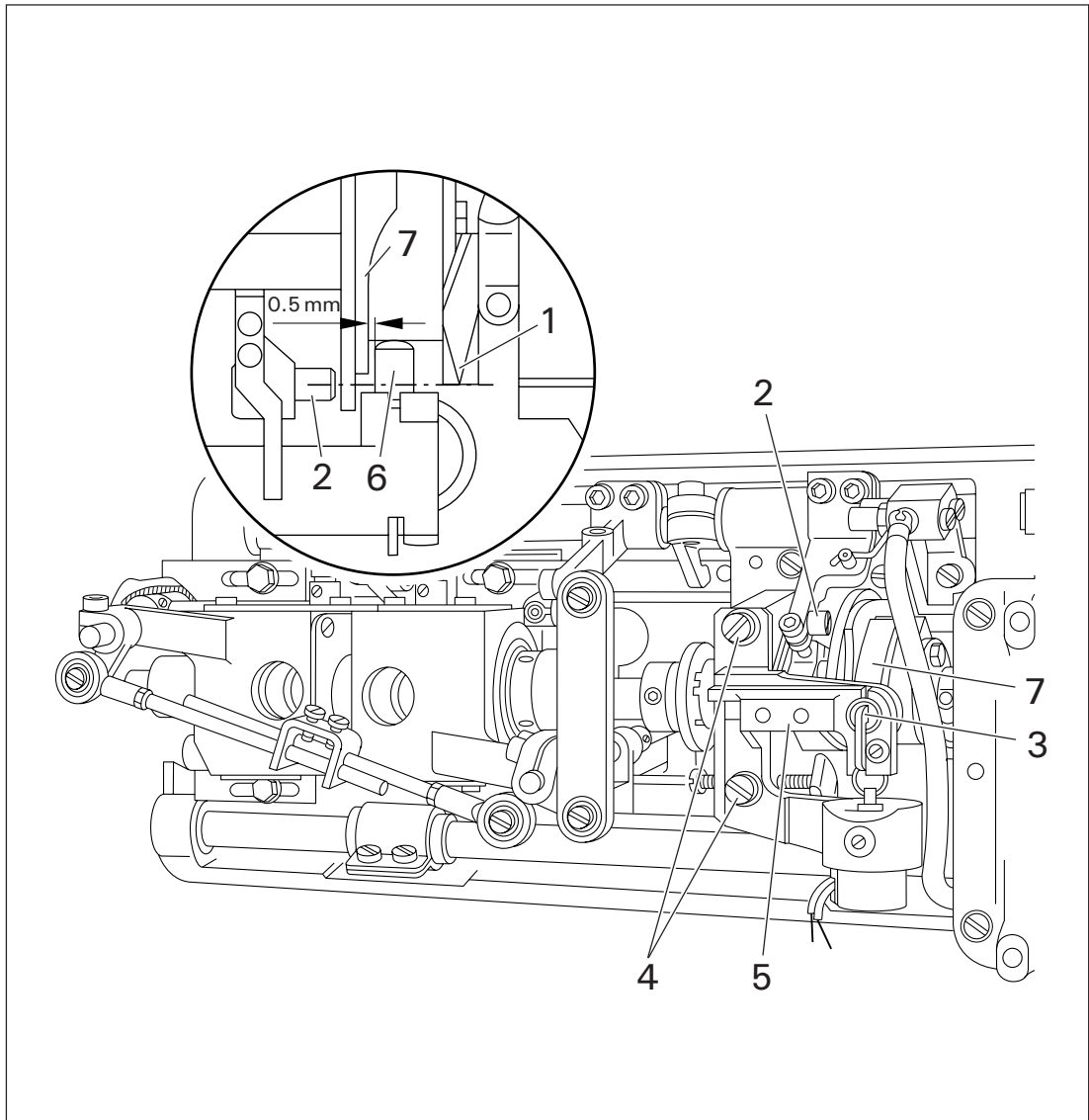

- Turn balance wheel until tip of trip 1 is aligned with control pin 2.
- Operate engaging lever 3.
- Loosen both screws 4.
- Adjust position of solenoid bracket 5 according to the requirement
- In this position, tighten screws 4.
- Check this adjustment according to the requirement.
- Turn balance wheel opposite feeding direction until control pin 6 is retained.

4.02 Solenoid bracket on -900/61

Requirement

With engaging lever 1 operated, and control pin 2 positioned beside return motion cam 3, there must be a clearance of 0.5 mm between control pin 2 and return motion cam 3.

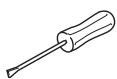
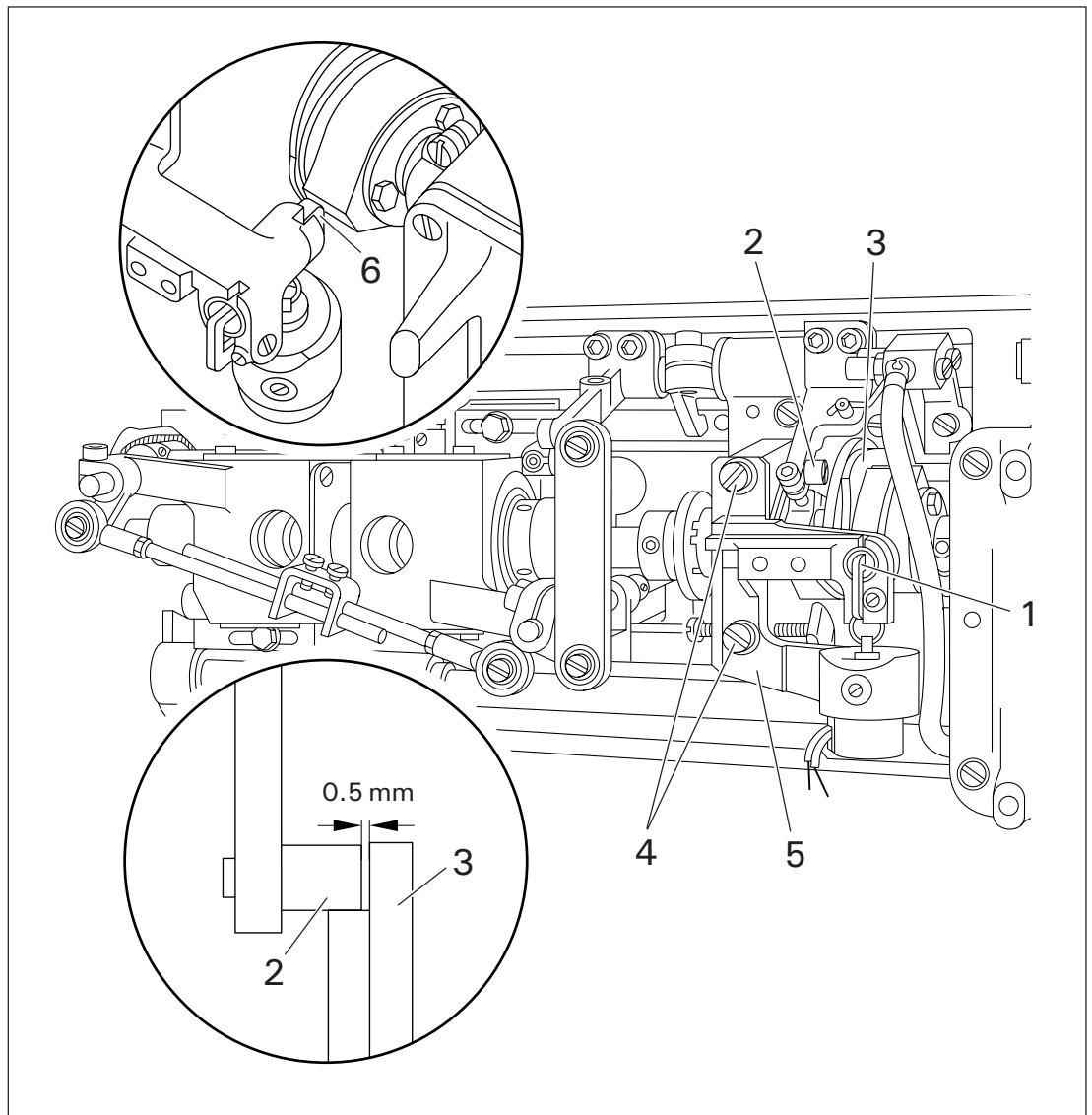

- Turn balance wheel in feeding direction until needle bar is positioned 10 mm before b.d.c.
- Operate engaging lever 1.
- Continue turning balance wheel until control pin 2 is positioned opposite return motion cam 3.
- Loosen screws 4.
- Adjust position of solenoid bracket 5 according to the requirement.
- In this position, tighten screws 4.
- Check this adjustment according to the requirement.
- Turn balance wheel opposite feeding direction until control pin 6 is retained.

5 Engaging lever pin

Requirement

When the trimming mechanism is at rest there must be a clearance of **0.1 mm** between the highest point of cam track 1 and control pin 2.

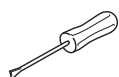
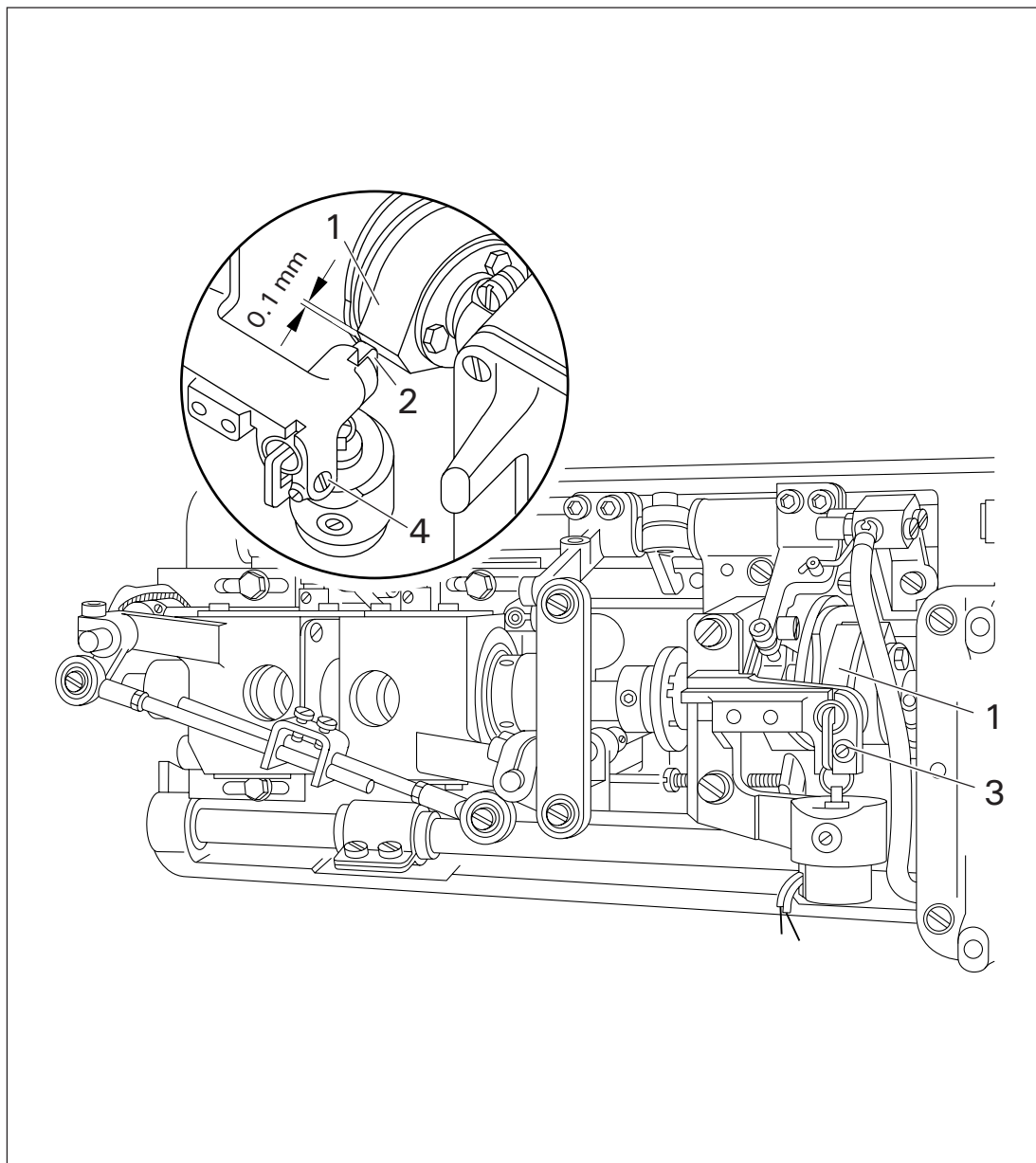

- Make sure control cam 1 is in its starting position. Then turn balance wheel until highest point of cam track 1 is aligned with control pin 2.
- Loosen screw 3.
- Turn eccentric stud 4 according to the requirement.
- In this position, tighten screw 3.
- Check this adjustment according to the requirement.

6 Eccentric pin of catcher control lever on -900/61 only

Requirement

Over the entire cam circumference the roller of eccentric pin 4 must be as close to control cam 3 as possible.

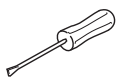
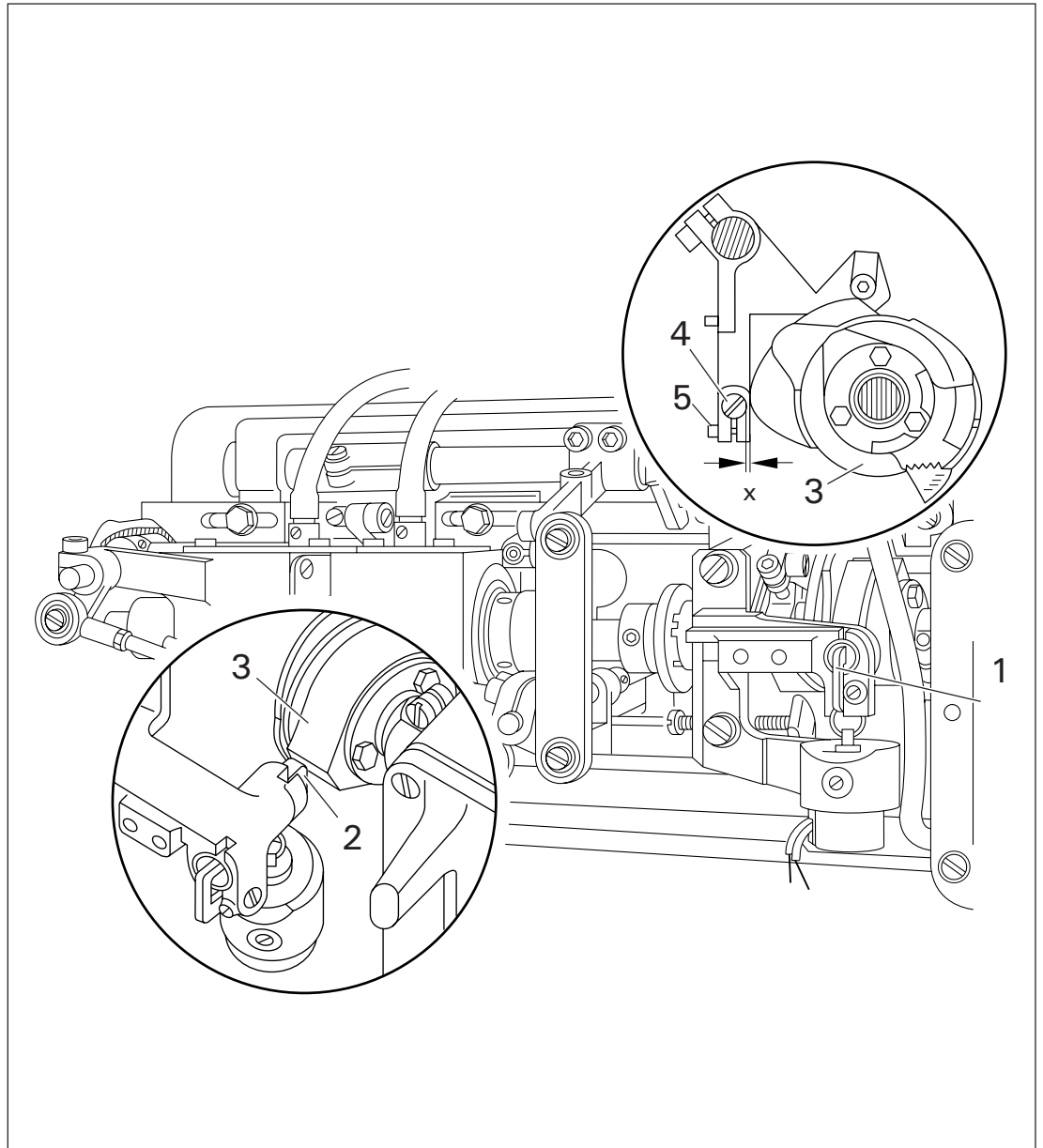

- Turn balance wheel in feeding direction until needle bar is positioned 10 mm before b.d.c.
- Operate engaging lever 1.
- Continue turning balance wheel until control pin 2 has moved control cam 3 to its left reversal point.
- Retaining this position, loosen screw 5 and turn eccentric pin 4 according to the requirement.
- In this position, tighten screw 5.
- Check this adjustment according to the requirement and repeat, if necessary.

7 Control cam and locking bracket

7.01 Axial position of crank lever

Requirement

Operate engaging lever 3 and turn the balance wheel to set control cam 5 at its far left position; there must then be a clearance of 0.2 mm between guide finger 8 and bottom of the control cam cutout (see below).

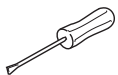
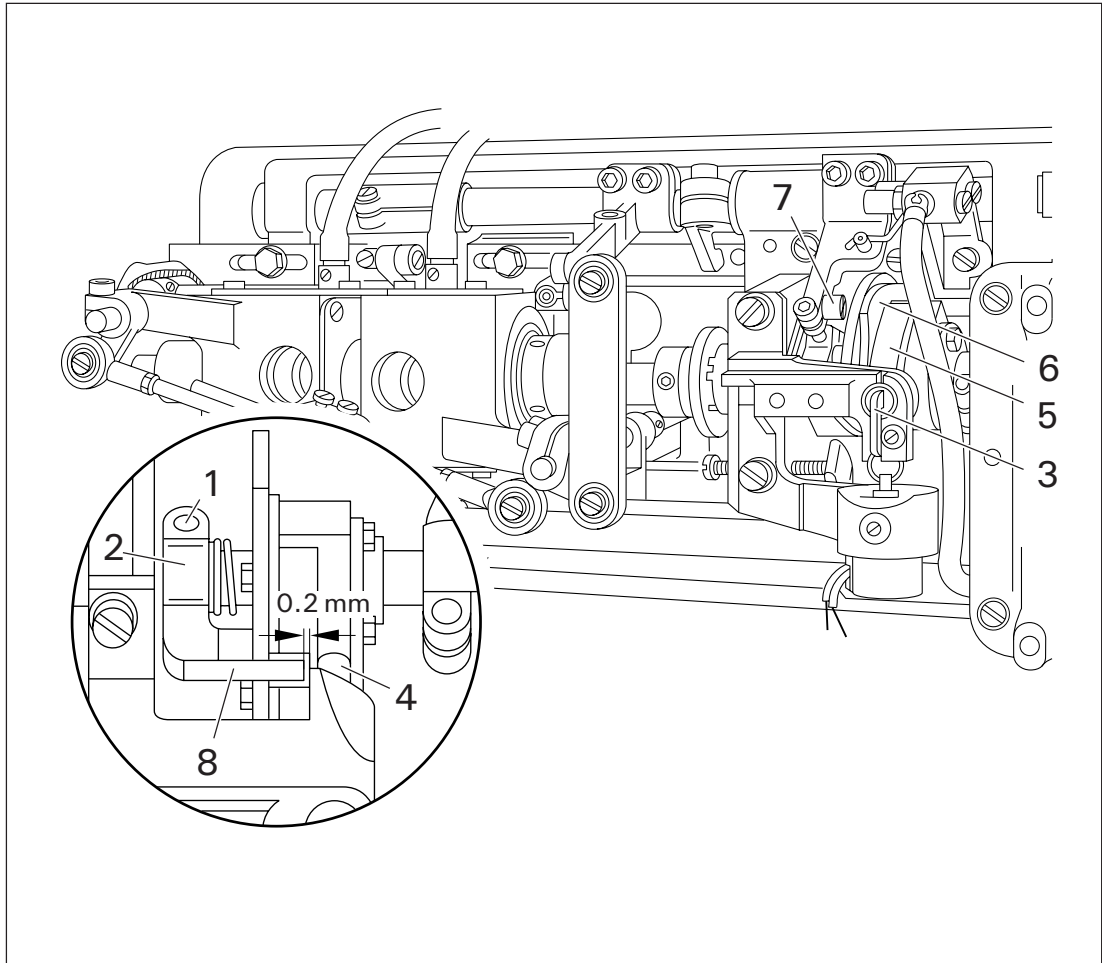

- Turn balance wheel in feeding direction until needle bar is positioned 10 mm before b.d.c.
 - Loosen screw 1 just sufficiently for crank lever 2 to be moved on its shaft against resistance.
 - Operate engaging lever 3.
 - Continue turning balance wheel until control pin 4 has set control cam 5 at its left point of reversal.
 - Retain this position, then move crank lever 2 laterally according to the requirement.
 - Turn balance wheel in feeding direction until needle bar is positioned 10 mm before b.d.c.
 - Tighten screw 1.
 - Make sure control cam 5 is just about to snap back to starting position, then push it all way to left. As you continue turning balance wheel, return motion cam 6 must freely pass stud 7.
- If required, repeat solenoid bracket adjustments (chap.4).

7.02 Radial position of control cam

Requirement

When the take-up lever is at t.d.c., the trimming action must be completed and control cam 3 must spring back to its starting position.

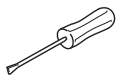
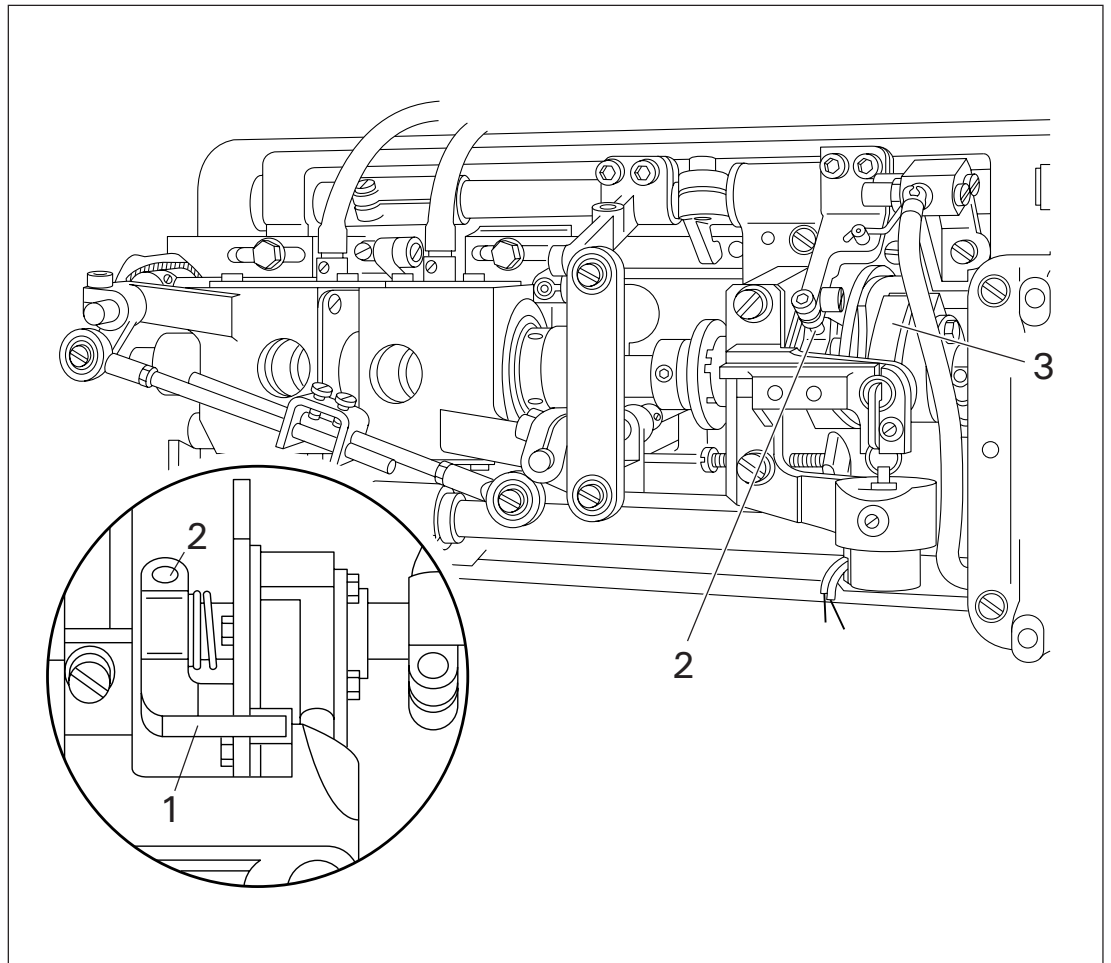

- Adjust guide finger 1 (screw 2) according to the requirement without moving it axially.

7.03 Locking bracket

Requirement

With control cam 4 guided to the left and pushed to the left by hand and the needle bar at t.d.c. there must be a clearance of **0.5 mm** between locking bracket 3 and control cam 4.

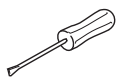
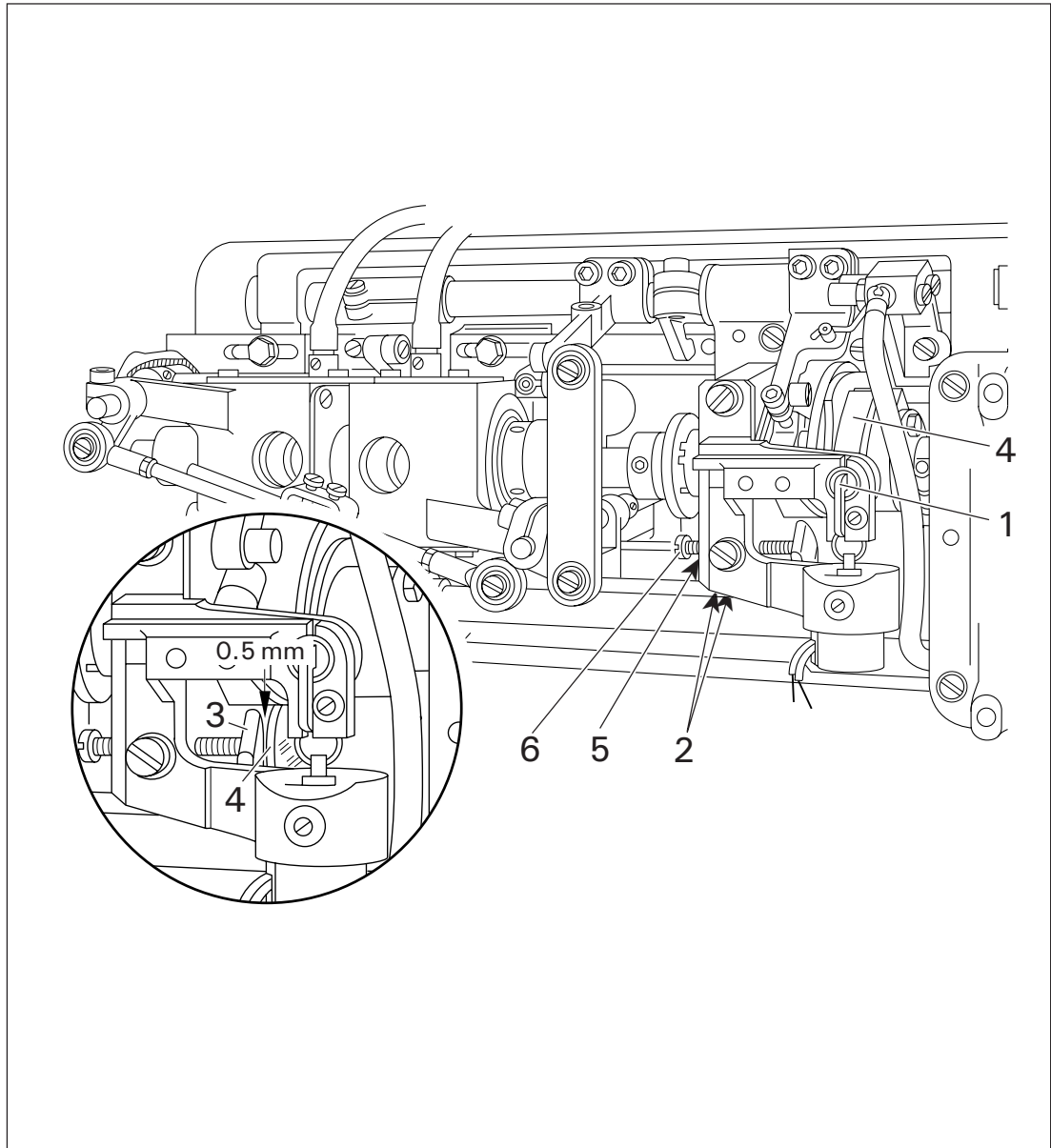

- Turn balance wheel in feeding direction until needle bar is positioned **10 mm** before b.d.c.
- Operate engaging lever 1.
- Continue turning balance wheel in feeding direction until needle bar is positioned at t.d.c.
- Loosen screws 2 on locking bracket 3.
- Push control cam 4 all way to left by hand.
- Retaining this position, set clearance between control cam 4 and locking bracket 3 according to the requirement.
- Tighten screws 2.
- Loosen nut 5 and bring screw 6 into contact with locking bracket 3.
- Tighten nut 5.
- Check this adjustment according to the requirement.

8 Engaging solenoid

Requirement

With the needle bar positioned 10 mm before b.d.c. and engaging lever 2 operated, core 4 of the engaging solenoid must have a play of 1 mm.

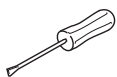
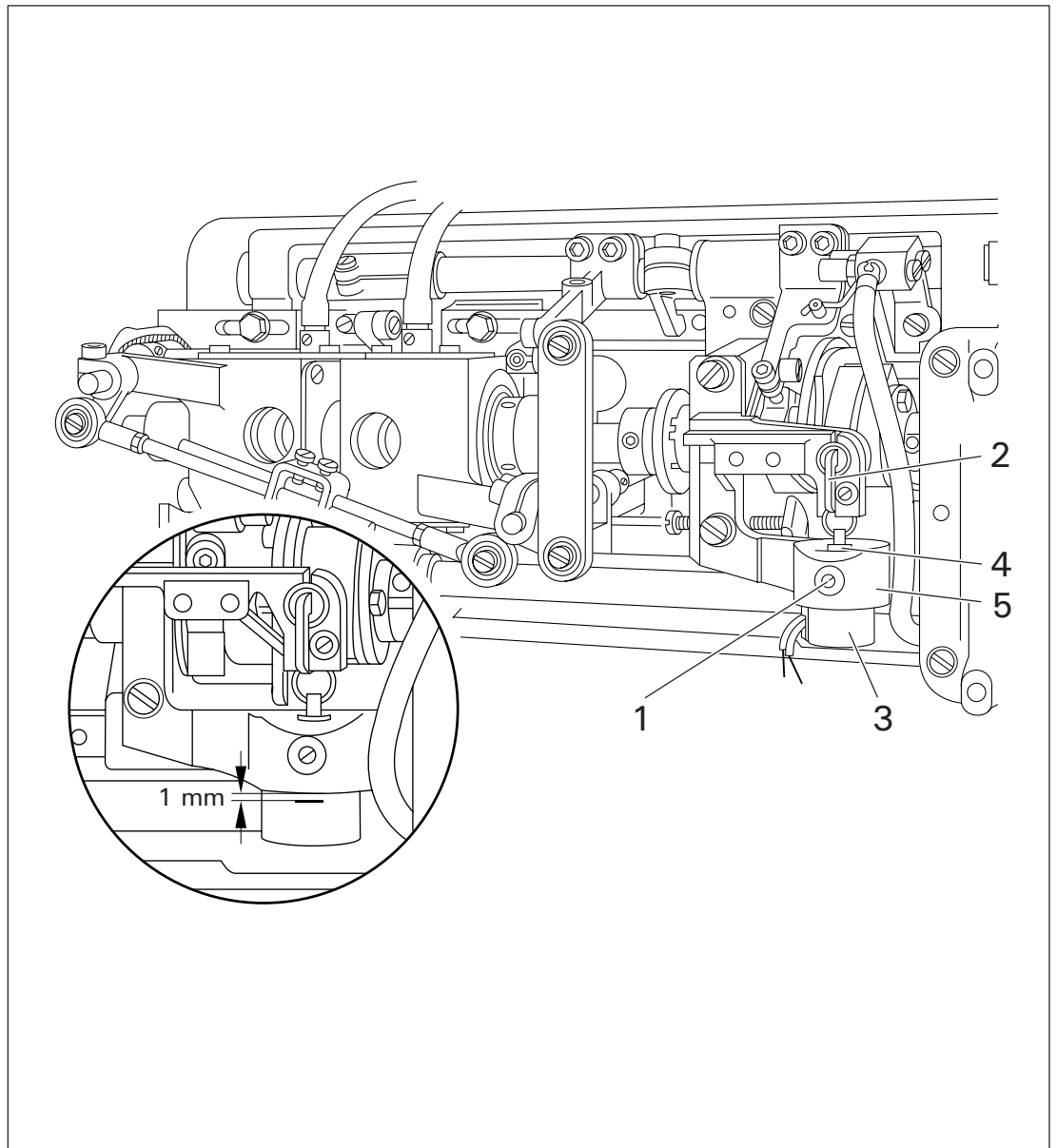

- Turn balance wheel in feeding direction until needle bar is positioned 10 mm before bottom dead centre.
- Loosen screw 1.
- Operate engaging lever 2.
- Push solenoid housing 3 upwards until solenoid core 4 is fully inside housing.
- In this position, make a mark on solenoid housing 3 immediately below solenoid bracket 5.
- Push solenoid housing 3 downwards by 1 mm and tighten screw 1.
- Check this adjustment according to the requirement.

9 Stop lug

Requirement

With stud 5 positioned at the highest point of disengaging cam 4 (take-up lever shortly before t.d.c.) there must be a clearance of 0.1 mm between stop lug 7 and the bedplate.

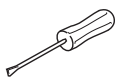
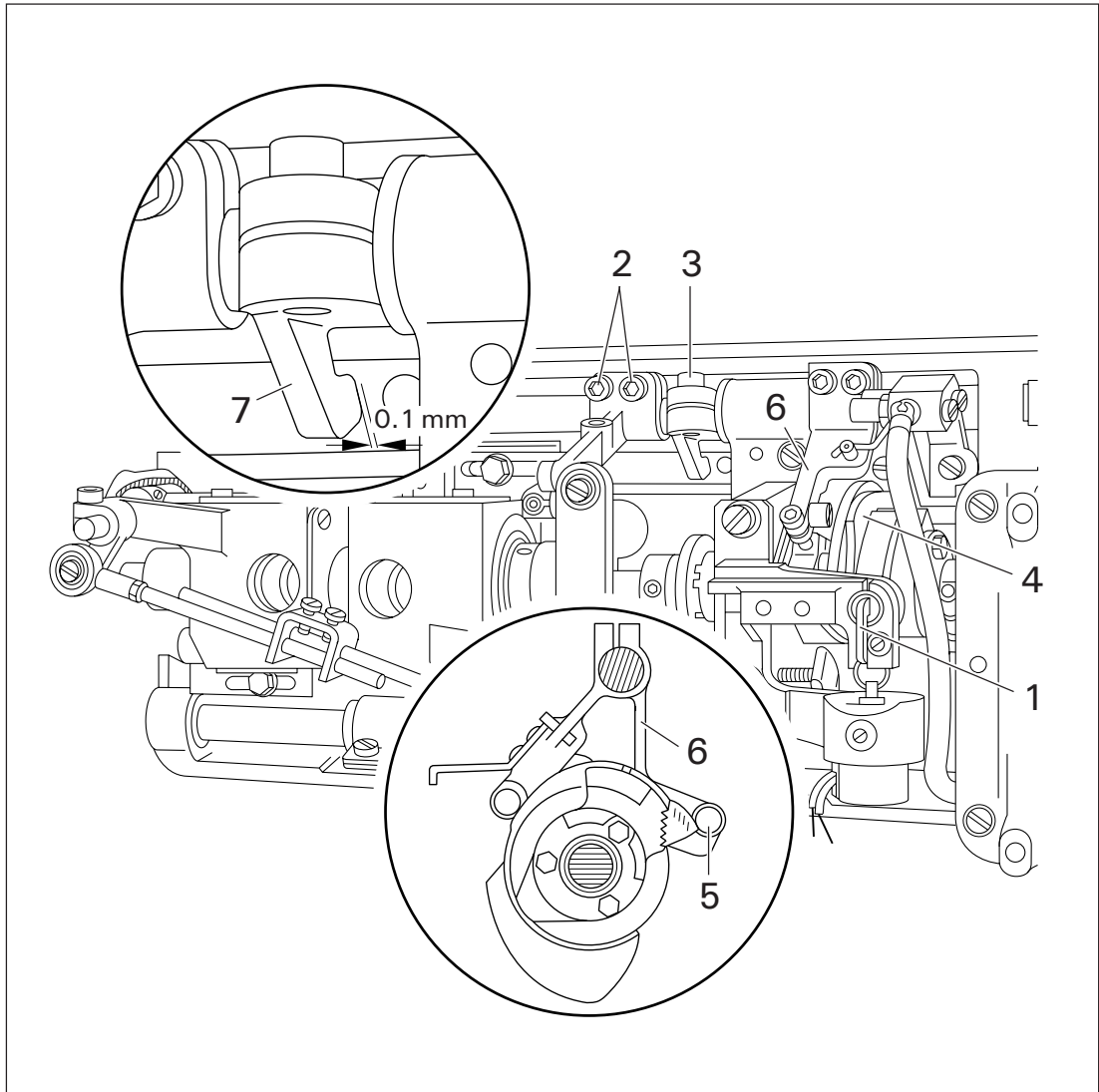

- Turn balance wheel in feeding direction to set needle bar 10 mm before b.d.c.
- Operate engaging lever 1.
- Loosen screws 2, then loosen screw 3.
- Turn balance wheel to position highest point of disengaging cam 4 under stud 5 of catcher control lever 6 (shortly before control cam returns to starting position).
- Maintaining this position, set stop 7 according to the requirement.
- Tighten screw 3.
- Check this adjustment according to the requirement.

10 Catcher actuating lever

Requirement

With the trimming mechanism at rest, ball-joint connecting link **2** must be at right angles to the edge of the bedplate. Also, there must be a clearance of **9 mm** between the left edge of ball-joint connecting link **2** and the centre of catcher driving shaft **7**.



When difficult threads are processed and the catcher does not take up the bobbin thread reliably, the stroke of the catcher can be increased or decreased through the elongated hole in crank **3**.

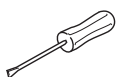
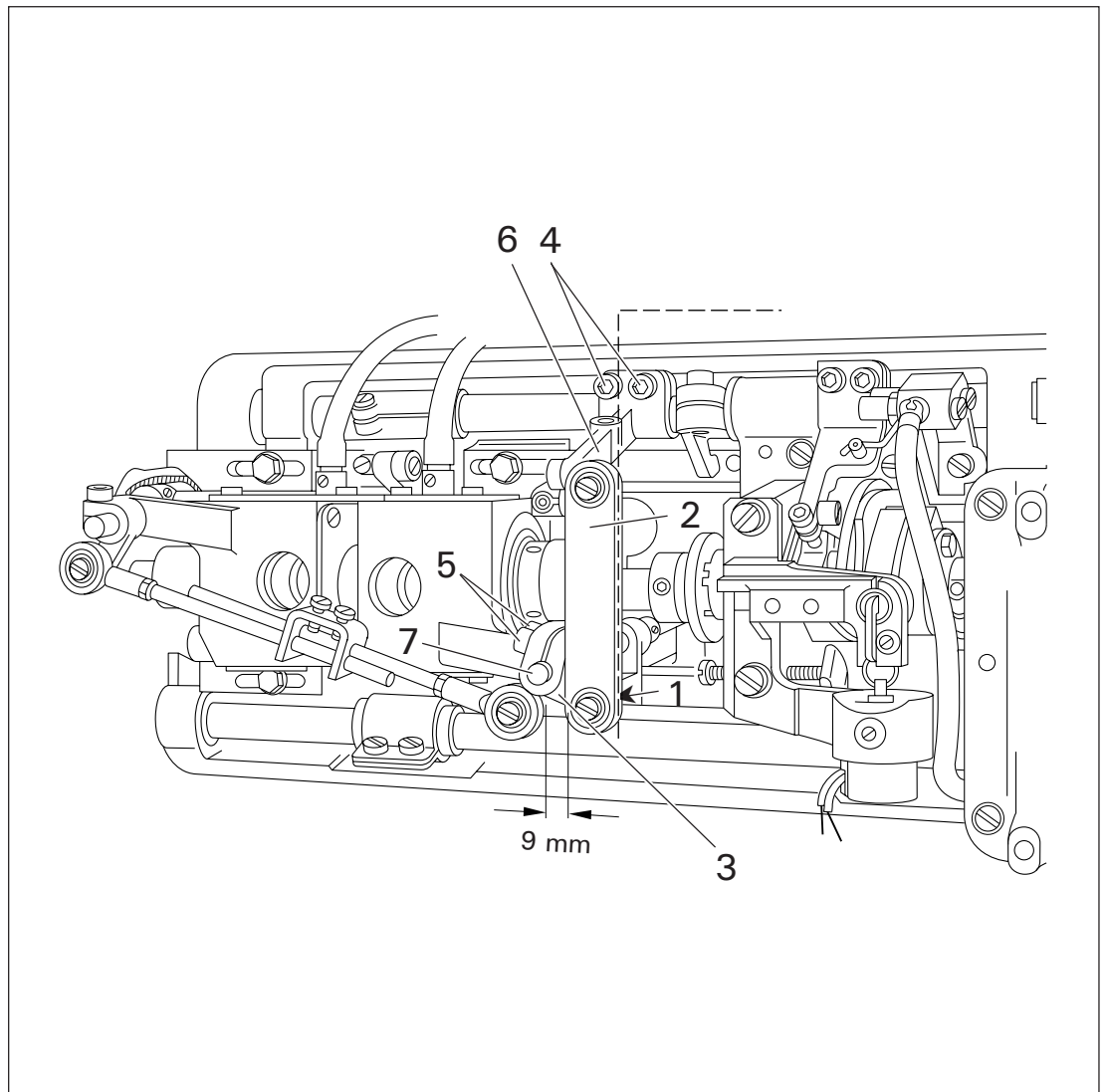

- Loosen nut **1**.
- Set ball-joint connecting link **2** in centre of elongated hole in crank **3**.
- Tighten nut **1**.
- Making sure trimming mechanism is at rest and screws **4** are still loose, loosen screws **5**.
- Adjust catcher actuating lever **6** both axially and radially according to the requirement.
- In this position, tighten screws **4**.
- Check this adjustment according to the requirement.
- Screws **5** are left loose for adjustment of thread catcher.

11 Catcher connecting rod (two-needle machines)

Requirement

The left bell-crank lever **4** must be parallel to the right bell-crank lever **5**.

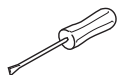
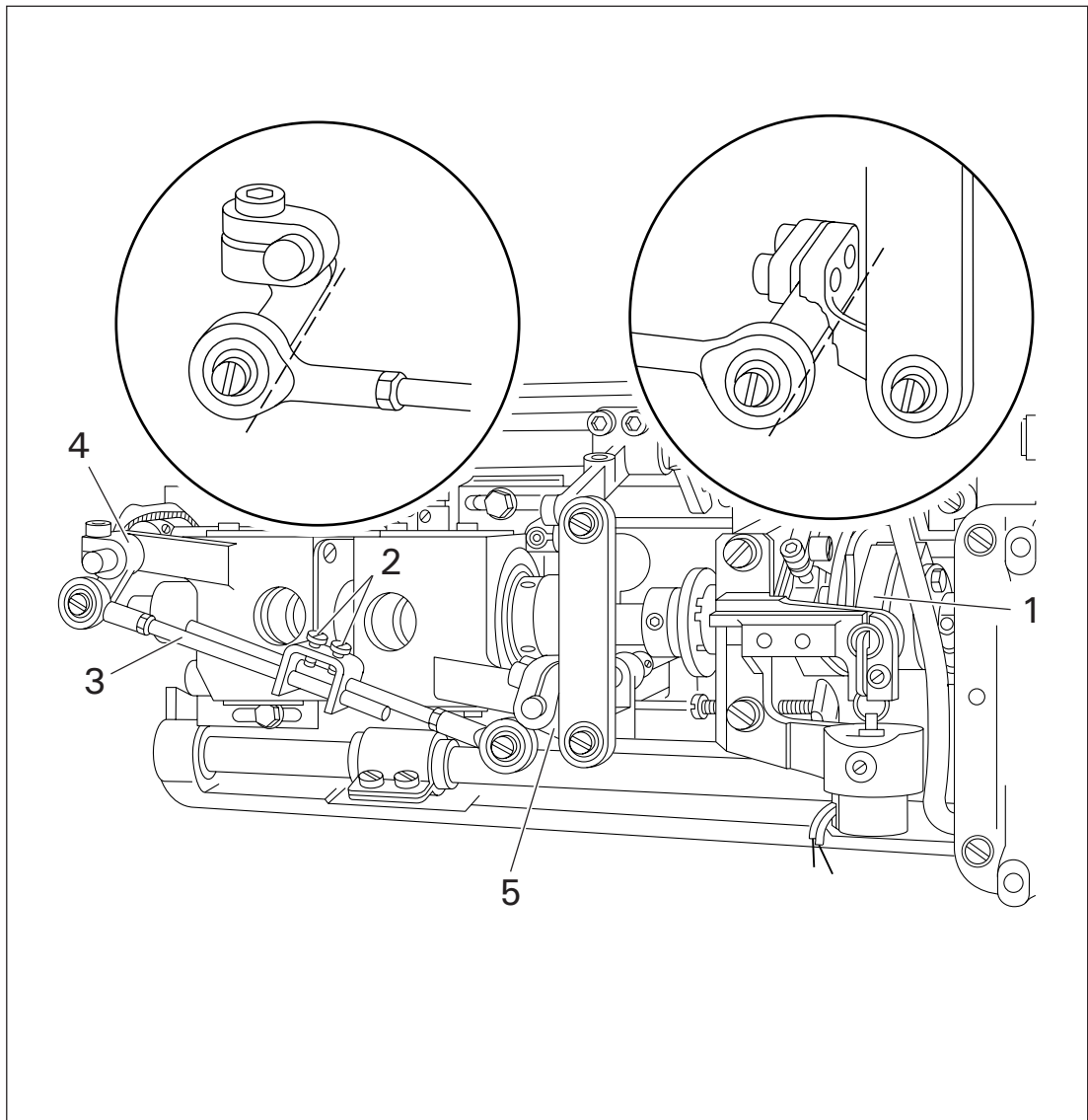

- Make sure control cam **1** is in starting position and loosen screws **2**.
- Adjust catcher connecting rod **3** according to the requirement.
- In this position, tighten screws **2**.

Catcher height

Requirement

Thread catcher 5 must pass 0.8 mm above bobbin case 6.



If during a manual trimming test (chap. 19) the end of the thread catcher pushes against the bobbin thread, change height setting.

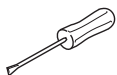
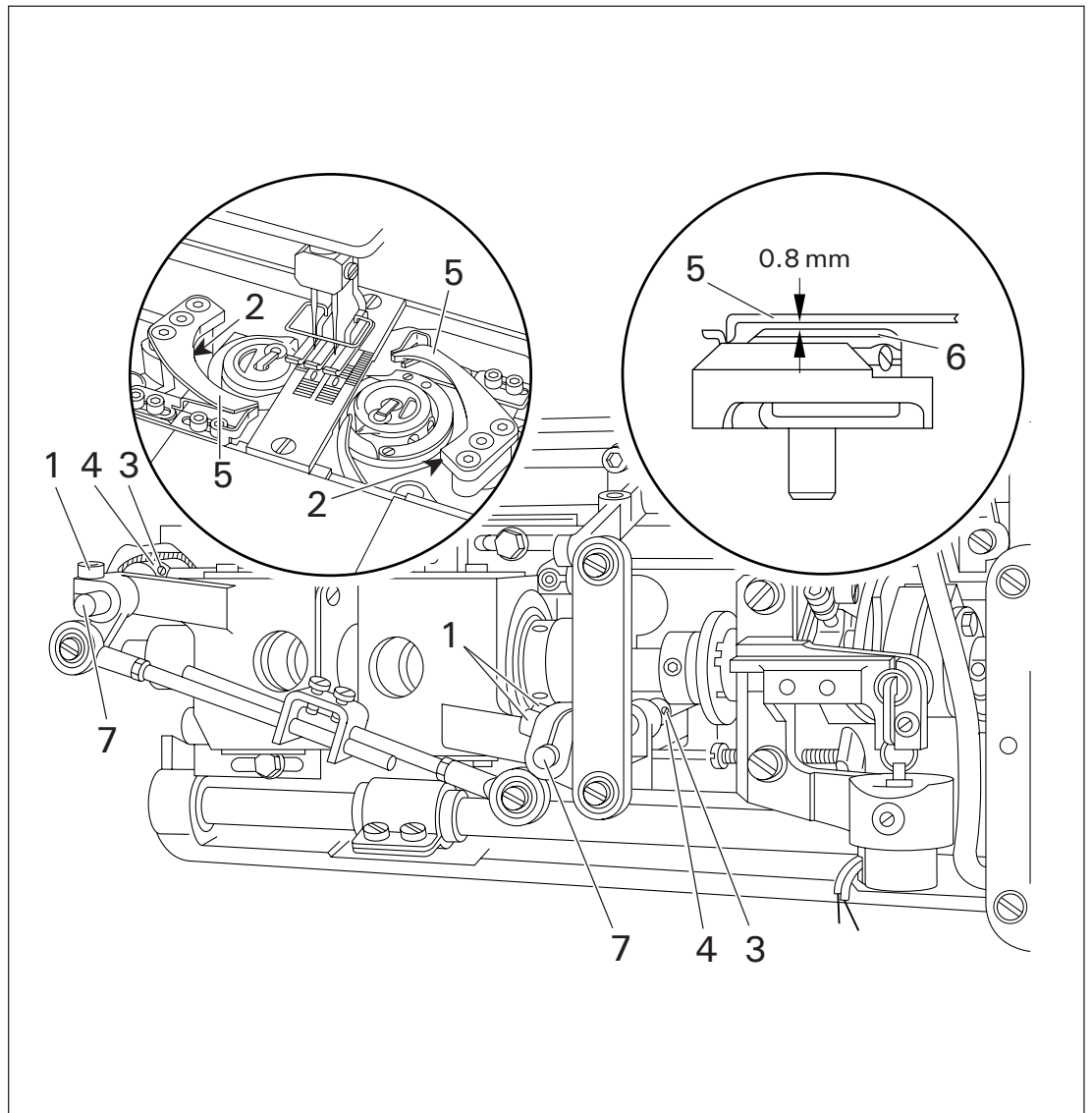

- Making sure that screws 1 are still loose, loosen screw 2.
- Loosen screws 3 in collar 4.
- Swing thread catcher 5 by hand to center it above bobbin case 6, and adjust it according to the requirement.
- In this position, tighten screw 2.
- Center vertical play of catcher driving lever 7, making sure catcher driving joint is not strained.
- Maintain position and making sure that collar 4 does not strike other parts, move fully downwards and tighten screw 3.
- Check this adjustment according to the requirement.
- On two-needle machines, make adjustment twice. Screws 1 are left loose.

Thread catcher rest position

Requirement

When the trimming mechanism is at rest, the triangular cutting tip of catcher 2 must be positioned 0.5 mm behind the cutting edge of knife 4.

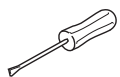
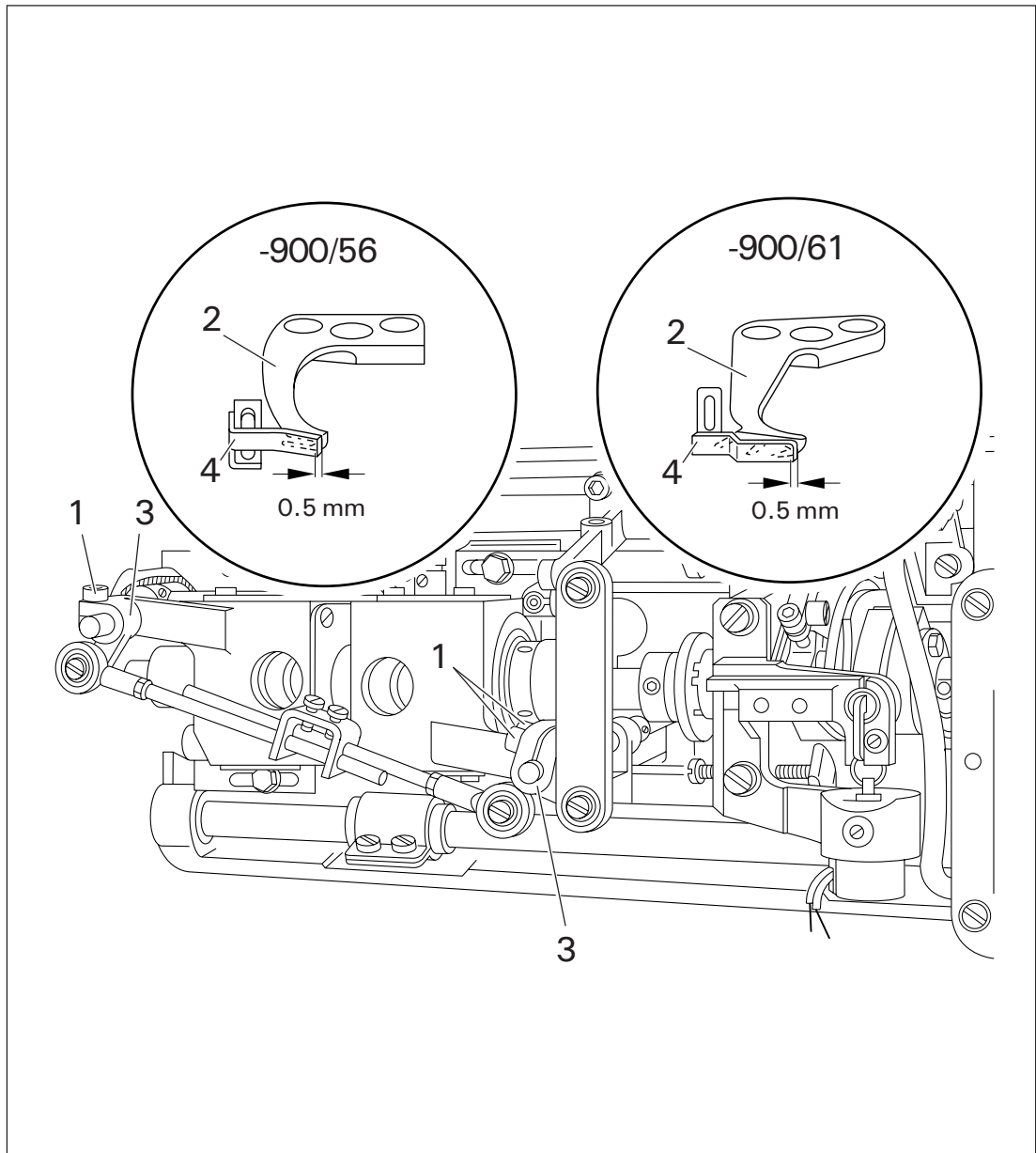

- Make sure trimming mechanism is in starting position and screws 1 are loose, then swing thread catcher 2 by hand according to the requirement.
- Maintain position while moving crank 3 against its stop and tighten screws 1.
- Check this adjustment according to the requirement.
- On two-needle machines, make adjustment twice.

14 Knife height

Requirement

With the thread trimmer in starting position the upper edge of knife 1 and catcher 2 should be of equal height.

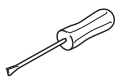
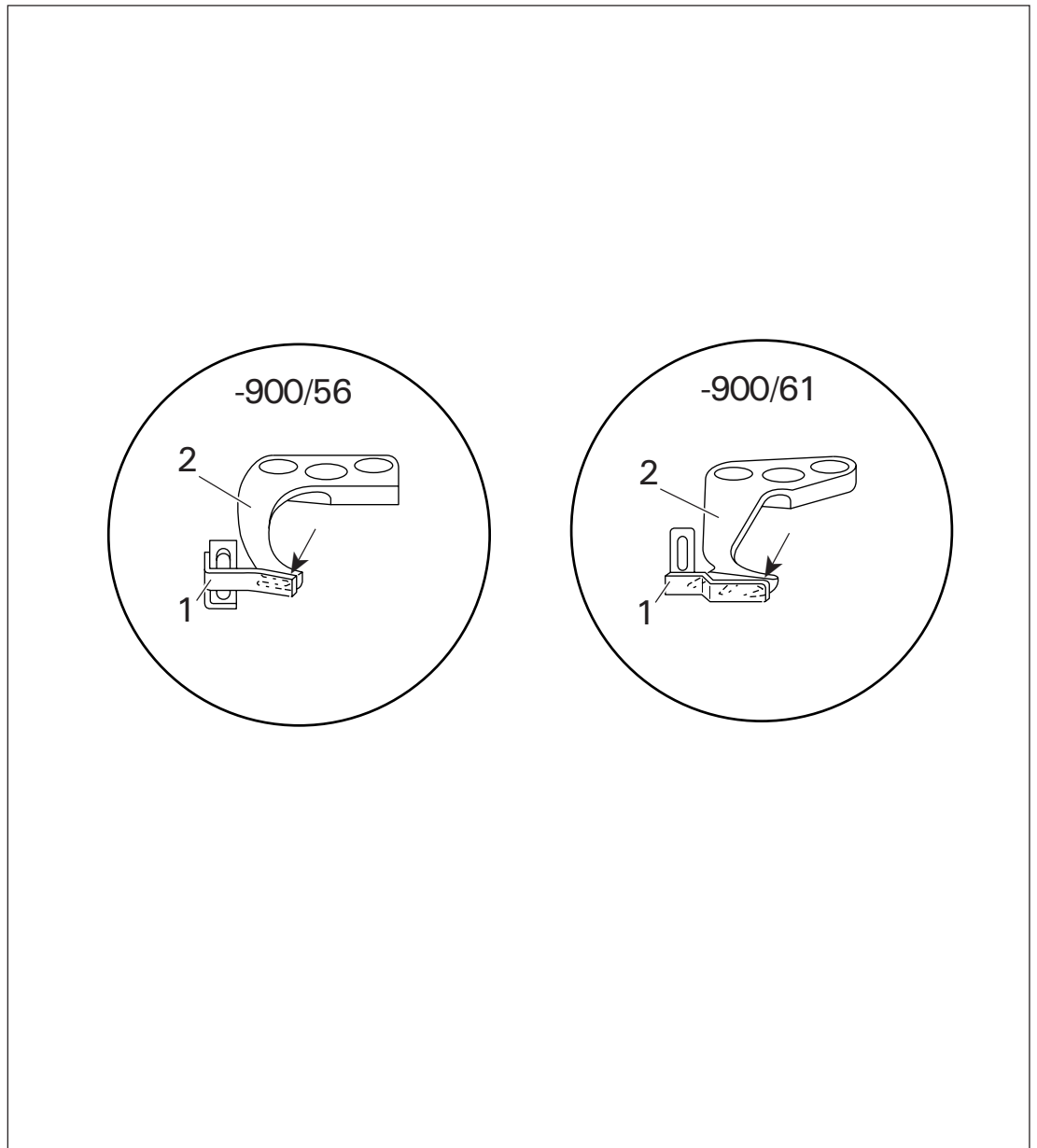

- The distance plates, part no. 91-141 402-05 (thickness 0.5 mm) should be placed under the knife 1 for to adjust the height.

15 Knife pressure

Requirement

When half of front edge of catcher 3 has passed the knife cutting edge, knife 4 should contact the edge of the thread catcher with light pressure.

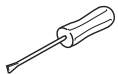
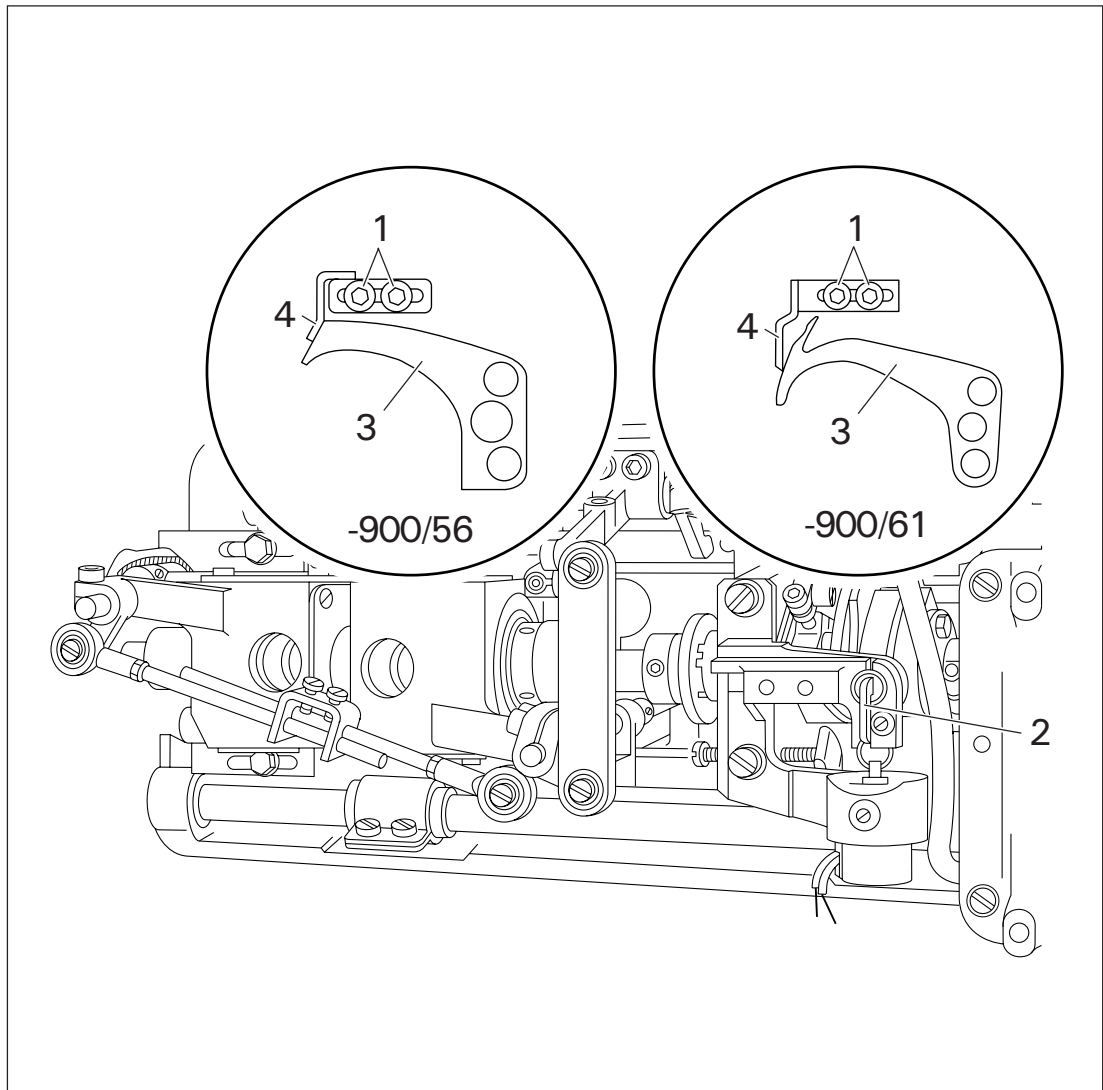

- Loosen screws 1 slightly.
- Turn balance wheel to set needle bar 10 mm before b.d.c.
- Operate engaging lever 2.
- Turn balance wheel until half of front edge of catcher 3 has passed cutting edge of knife 4.
- Maintain position and adjust position of knife 4 according to the requirement.
- In this position, tighten screws 1.
- For a cutting test, turn balance wheel to set catcher 3 at forward point of reversal.
- Place two threads into thread catcher hook and turn balance wheel until catcher 3 returns to starting position.
- Increase knife pressure, if necessary.
- Check this adjustment according to the requirement.
- On two-needle machines, make adjustment twice.

16 Bobbin thread trapper spring

Requirement

Thread trapper spring 4 must not be deflected during the catcher motion. After thread trimming, the bobbin thread must be trapped reliably. The bobbin case must be easy to remove from the sewing hook and easy to remove.

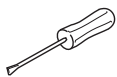
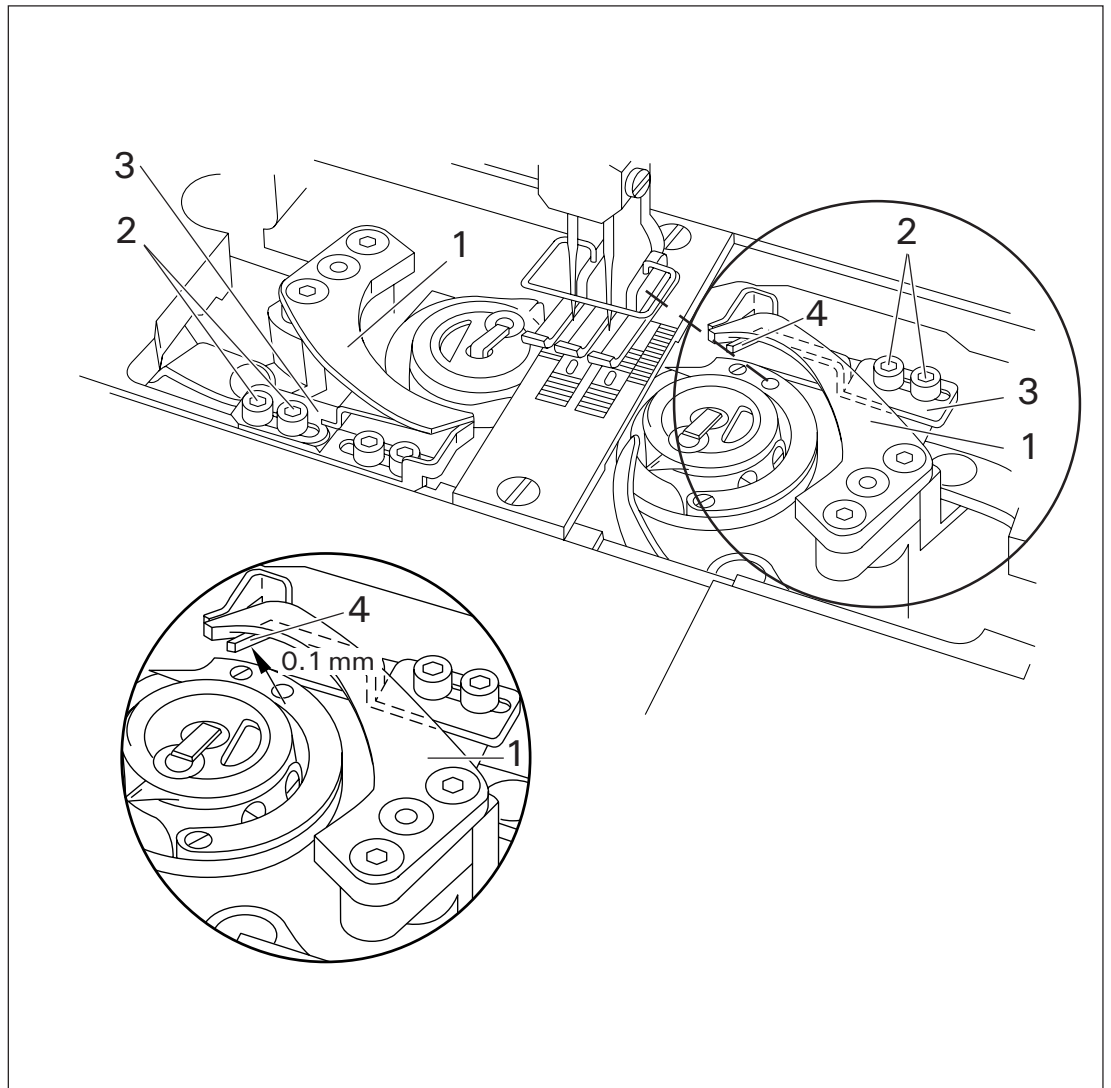

- Making sure catcher 1 is in starting position, loosen screws 2 slightly.
- Maintain position and adjust position of bracket 3 so that lip of trapper spring 4 is set as close as possible to inner wall of thread catcher 1 and is flush with front edge of catcher (see right Fig.).
- In this position, tighten screws 2.
- Adjust bracket 3 vertically so that there is a clearance of 0.1 mm between thread trapper spring 4 and underside of thread catcher 1 (see lower left Fig.).
- Check this adjustment according to the requirement.
- On two-needle machines, make adjustment twice.

17 Needle thread tension release

Requirement

When the presser foot is lowered onto the needle plate and dog 1 has actuated tension release trip 2 there must be a clearance of at least **0.5 mm** between both tension discs.

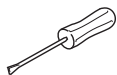
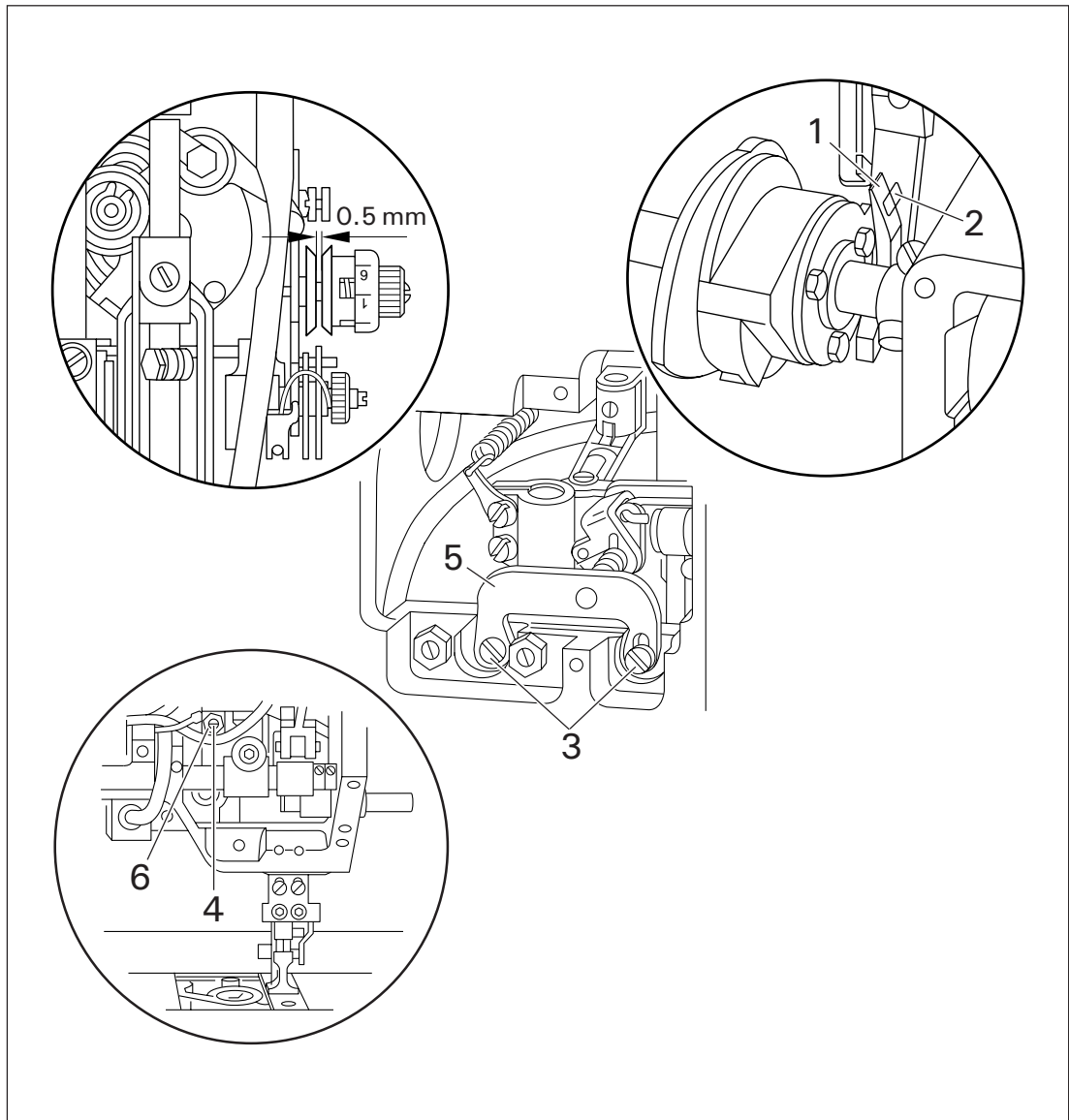

- Lower presser foot onto needle plate by operating presser bar lift.
- Set needle bar **10 mm** before b.d.c. and operate engaging lever.
- Turn balance wheel until dog 1 has actuated tension release trip 2.
- Loosen screws 3.
- Version without adjusting screw 4:
Move bracket 5 in elongated hole according to the requirement.
- In this position, tighten screws 3.
- Version with adjusting screw 4:
Position bracket 5 horizontally in elongated hole and tighten screws 3.
- Loosen nut 6 and turn screw 4 according to the requirement.
- In this position, lock screw 4 with nut 6.
- Check this adjustment according to the requirement.

18 Synchronizer

Requirement

When sewing is interrupted, the machine must stop with the needle bar at a position **10 mm** before b.d.c. After thread trimming the machine must stop with the take-up lever at t.d.c.

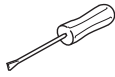

- See the service manual of the motor manufacturer.

19 Manual trimming test



To ensure that the thread will be properly caught on two needle machines and on machines with the hook to the left of the needle the feed and lifting motion of the feed mechanism should be set at **0.6 mm** before needle bar b.d.c.

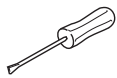
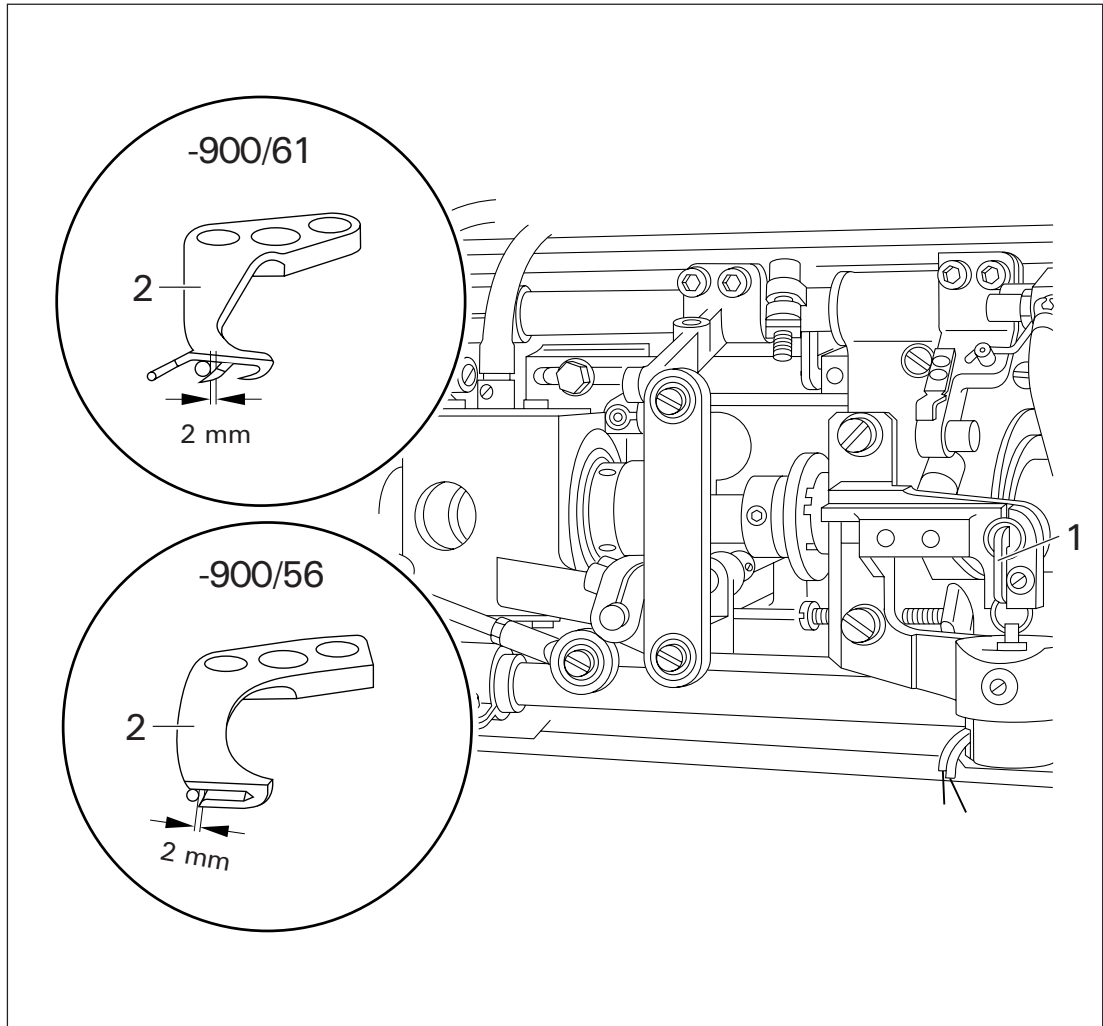

- Thread machine, place fabric under presser foot and turn balance wheel to sew a few stitches.
- Turn balance wheel in feeding direction until needle bar is **10 mm** before b.d.c.
- Operate engaging lever 1.
- Continue turning balance wheel slowly and watch catcher 2.
- During its forward movement catcher 2 must touch bobbin thread lightly, however, without pushing it. If necessary, re-adjust catcher height (chap. 12).
- When catcher 2 is at front point of reversal bobbin thread must be positioned behind end of catcher by at least **2 mm** (see Figs. at upper or lower left). If necessary, change setting of catcher stroke (chap. 10) (clearance between connecting link and centre of catcher driving shaft). Displacing connecting link in direction of catcher driving shaft increases catcher stroke, displacing it in opposite direction, decreases stroke. Afterwards check adjustment (chap. 13) (thread catcher rest position).
- After trimming action both needle and bobbin thread must be properly trimmed and bobbin thread trapped. Re-adjust height of bobbin in thread clamp spring, if necessary (chap. 16).

PFAFF

G.M. PFAFF
Aktiengesellschaft

Postfach 3020
D-67653 Kaiserslautern

Königstr. 154
D-67655 Kaiserslautern

Telefon: (0631) 200-0
Telefax: (0631) 172 02
Telex: 45753 PFAFF D

Gedruckt in der BRD
Printed in Germany
Imprimé en R.F.A.
Impreso en la R.F.A.
Stampato in R.F.G.
отпечатано ФРГ