

PFAFF

3117-957/02

Service manual

Instruction supplement to
PFAFF 3117
instruction manual

At the time of printing, all information and illustrations contained in this document were up to date.

Subject to alteration!

The reprinting, copying or translation of PFAFF Instruction Manuals, whether in whole or in part, is only permitted with our previous permission and with written reference to the source.

G.M. PFAFF
Aktiengesellschaft

Postfach 3020
D-67653 Kaiserslautern
Königstr. 154
D-67655 Kaiserslautern

Redaktion / Illustration
HAAS-Publikationen GmbH
D-53840 Troisdorf

	Contents	Chapter - Page
1	Elements of operation	1 - 1
1.01	Foot pedal	1 - 1
1.02	Knuckle switch for machine stop	1 - 1
2	Installation and commissioning	2 - 1
2.01	Adjusting the pedal	2 - 1
3	Adjustment	3 - 1
3.01	Notes on adjustment	3 - 1
3.02	Tools, gauges and other accessories	3 - 1
3.03	Detector lever	3 - 2
3.04	Locking dog	3 - 3
3.05	Driving pulleys	3 - 4
3.06	Manual switching-off	3 - 5
3.07	Catch lever	3 - 6
3.08	Stroke of the scissors	3 - 7
3.09	Engaging lever	3 - 8
3.10	Presser bar lifting lever	3 - 9
3.11	Lifting and starting lock	3 - 10
3.12	Mounting and dismounting the belts	3 - 11
3.13	Mounting the belt guard and aligning the belt catchers	3 - 12
3.14	Taking up belt slack	3 - 13

Elements of operation

1 Elements of operating

1.01 Foot pedal

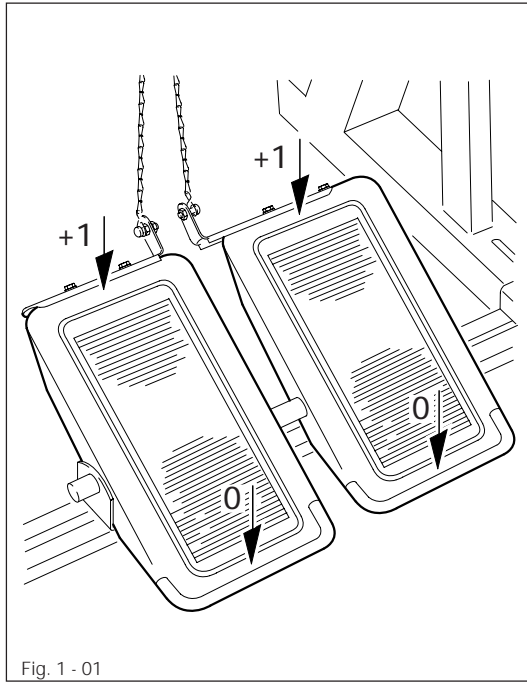

Right foot pedal 0 = resting position
Right foot pedal +1 = switch on machine
Left foot pedal 0 = resting position
Left foot pedal +1 = lift work clamp



Only one pedal is to be pressed at a time. If one pedal is pressed down, the other should be in resting position.

1.02 Knuckle switch for machine stop

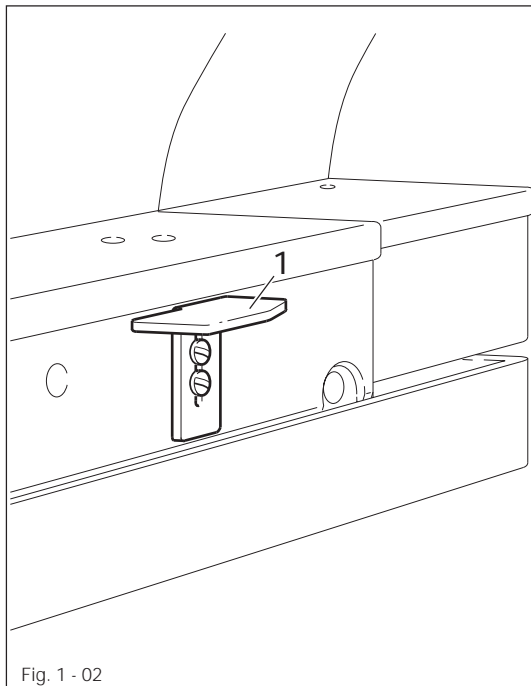

- By pressing the knuckle switch 1 down and pulling it back up, the machine can be brought to a halt.
- By turning the handwheel or pressing the right foot pedal the machine can be brought into the basic position.

2 Installation and commissioning

2.01 Adjusting the pedal

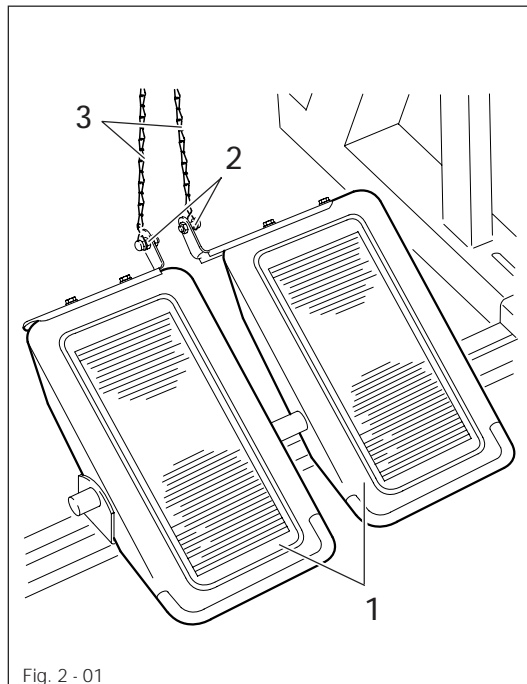

Adjust the inclination of the pedals 1 so that the angle is ergonomical and comfortable.

To do so:

- Bend the hooks 2 open and shorten or lengthen chain 3 accordingly.
- Bend the hooks 2 closed.

3 Adjustment

3.01 Notes on adjustment

All adjustments in this service manual apply to a fully assembled machine. Machine covers which have to be removed and replaced for checking and adjusting are not mentioned in the text!



This service manual is only valid in conjunction with the instruction manual for the PFAFF 3117. All safety regulations applicable to the PFAFF 3117 have to be observed!



Before all adjustment work unplug the machine from the power supply and ensure that cannot be switched on by accident!

3.02 Tools, gauges and other accessories

- Please see instruction manual for PFAFF 3117

3.03 Detector lever

Requirement

When the machine is switched on and in left purl-seam position, the distance between the projection of the detector lever 6 and the control cam 7 should be 0.3 mm.

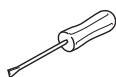
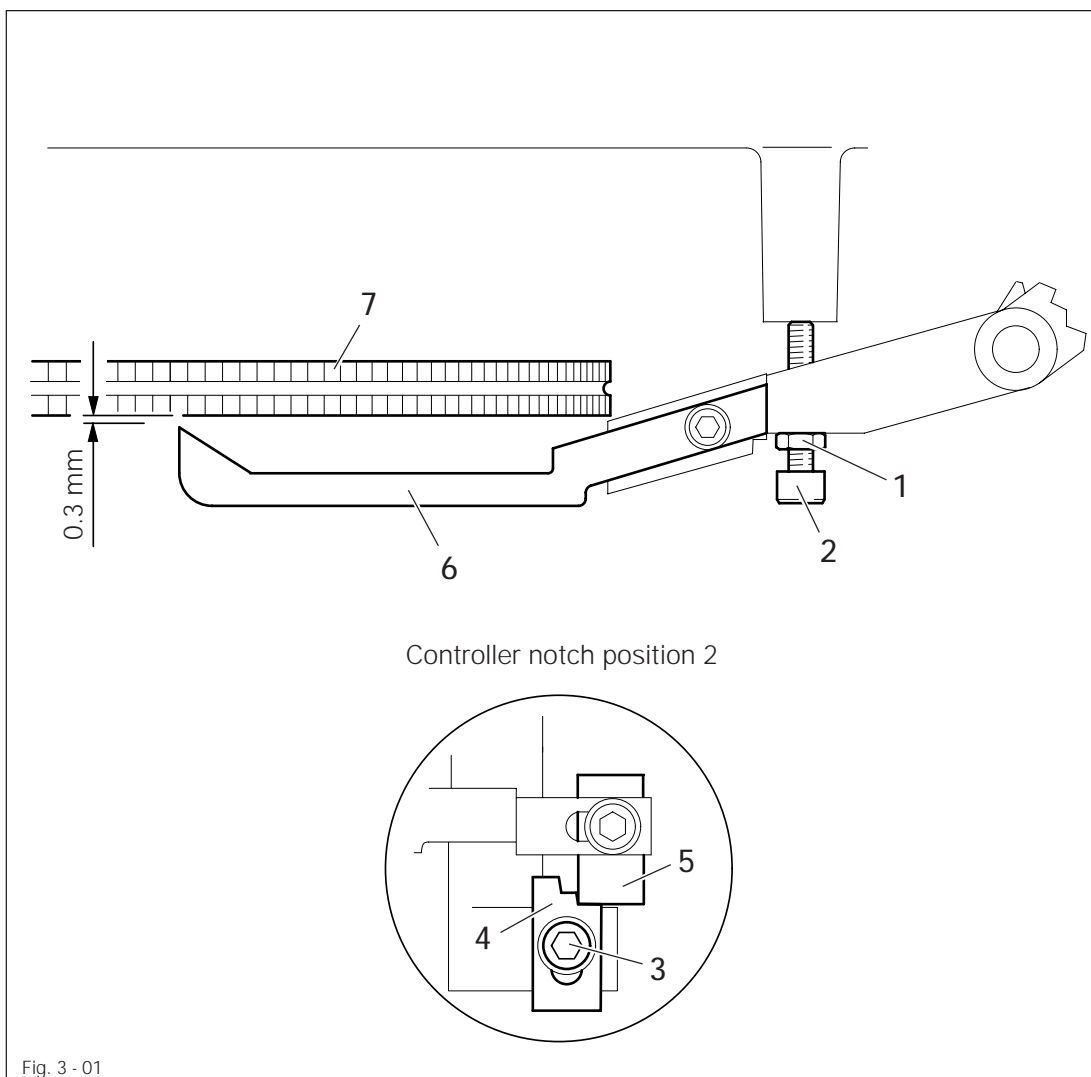

- Engage stop motion device (controller notch position 2).
- Loosen nut 1 and screw out screw 2 a few turns.
- Loosen screw 3.
- Screw screw 2 according to the requirement.
- Move dog 4 so that it touches dog 5.
- Tighten nut 1.



Screw 3 stays unscrewed for further adjustments.

3.04 Locking dog

Requirement

1. When the tip of the detector lever 2 is on the highest point of the trip 1, there should be a distance of 0.3 mm between dogs 3 and 5.
2. The stop link 8 should be 4 mm from the highest point of the cam 7.

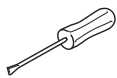
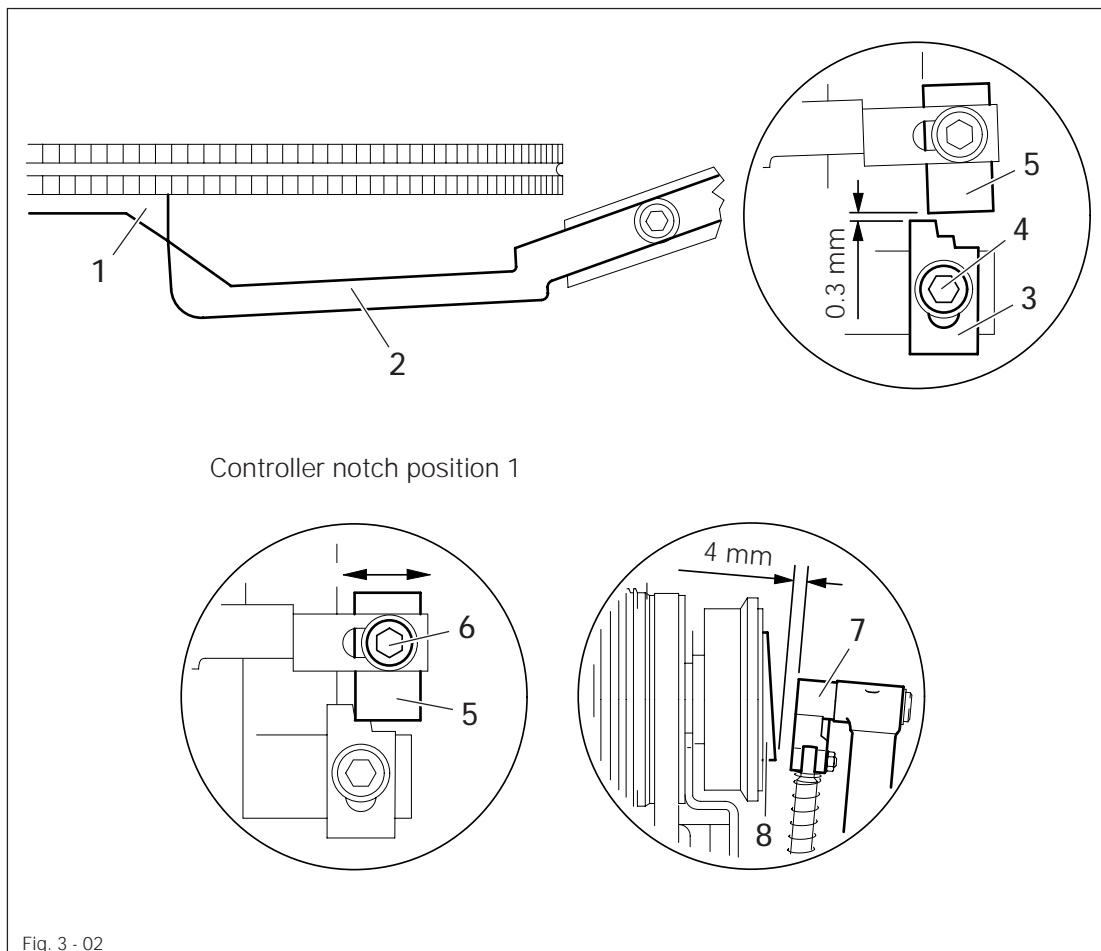

- Turn the control cam so that the highest point of the trip 1 is flush with the tip of the detector lever 2.
- Move dog 3 up or down in accordance with requirement 1.
- Tighten screw 4.
- Turn the control cam a little.
- Engage the stop motion device (controller notch 1).
- Loosen screw 6 and move trip 5 in direction of the arrow according to requirement 2.
- Tighten screw 6.

3.05 Driving pulleys

Requirement

1. When the stop motion device is engaged, both driving pulleys **6** and **12** must turn freely.
2. In **controller notch position 1** (reduced engine speed) driving pulley **6** must be engaged. Driving pulley **12** must rotate freely.
3. In **controller notch position 2** (operating speed) driving pulley **12** must be engaged and driving pulley **6** must rotate freely.

Controller notch position 1

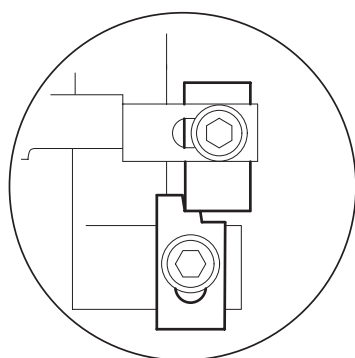

Controller notch position 2

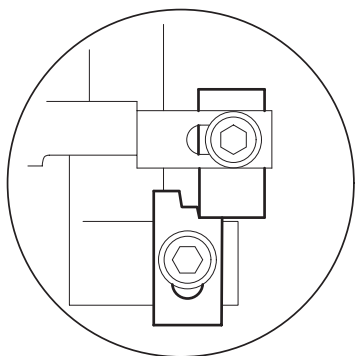
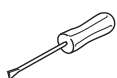

Fig. 3 - 03



- Engage the stop motion device.
- Undo screws **1** and **2** and remove eccentric pin **3**.
- Loosen nut **4**, screw screw **5** back a few turns and then screw it back until there is a clearance of **0.2-0.25 mm** between drive pulley **6** and the cork layer **7**.
- Tighten screw **1** and nut **4**.
- Position the stop motion device manually in **controller notch position 2**.
- Insert eccentric pin **3** and turn to the left until there is a clearance of **0.1 mm** between control plate **8** and roller **10**.
- Tighten screw **2**.
- Position the stop motion device in **controller notch position 1**.
- Check requirement **2**.



Roller **11** must be able to rotate.

Requirement

During a program sequence the machine should come to a halt immediately when knuckle switch 2 is pressed and lifted again.

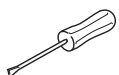
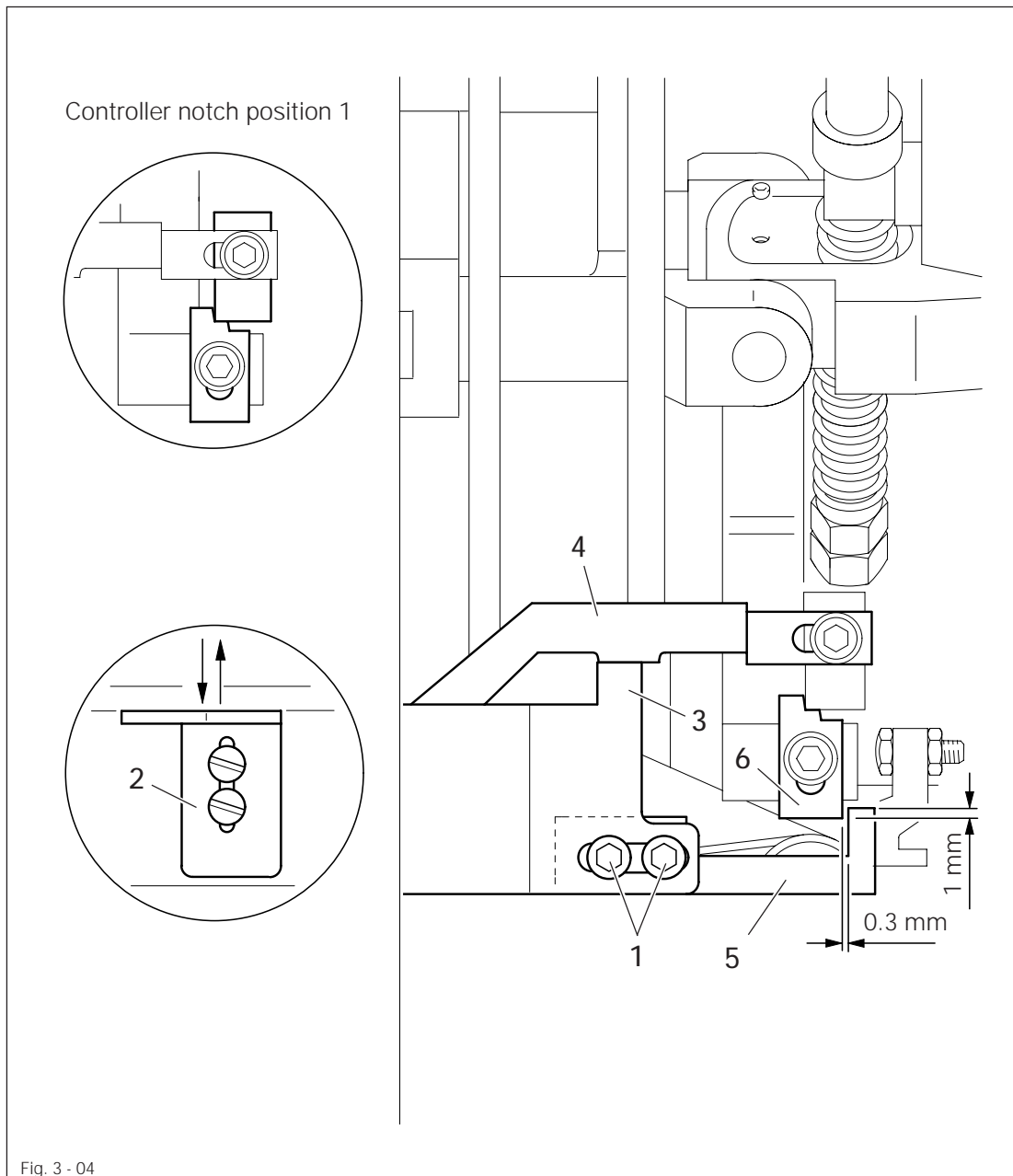

- Position the stop motion device in **controller notch position 1**.
- Loosen screws 1.
- Press down knuckle switch 2 so far that lever 3 and disengaging lever 4 are touching.
- Move interlock 5 so that the bottom edge of dog 6 is positioned approximately 1 mm below the top edge of interlock 5. At the same time interlock 5 and dog 6 must be 0.3 mm apart.
- Tighten screws 1.

3.07

Catch lever

Requirement

When the stop motion device is engaged, catch lever 1 must touch pin 2 of the knife pawl.

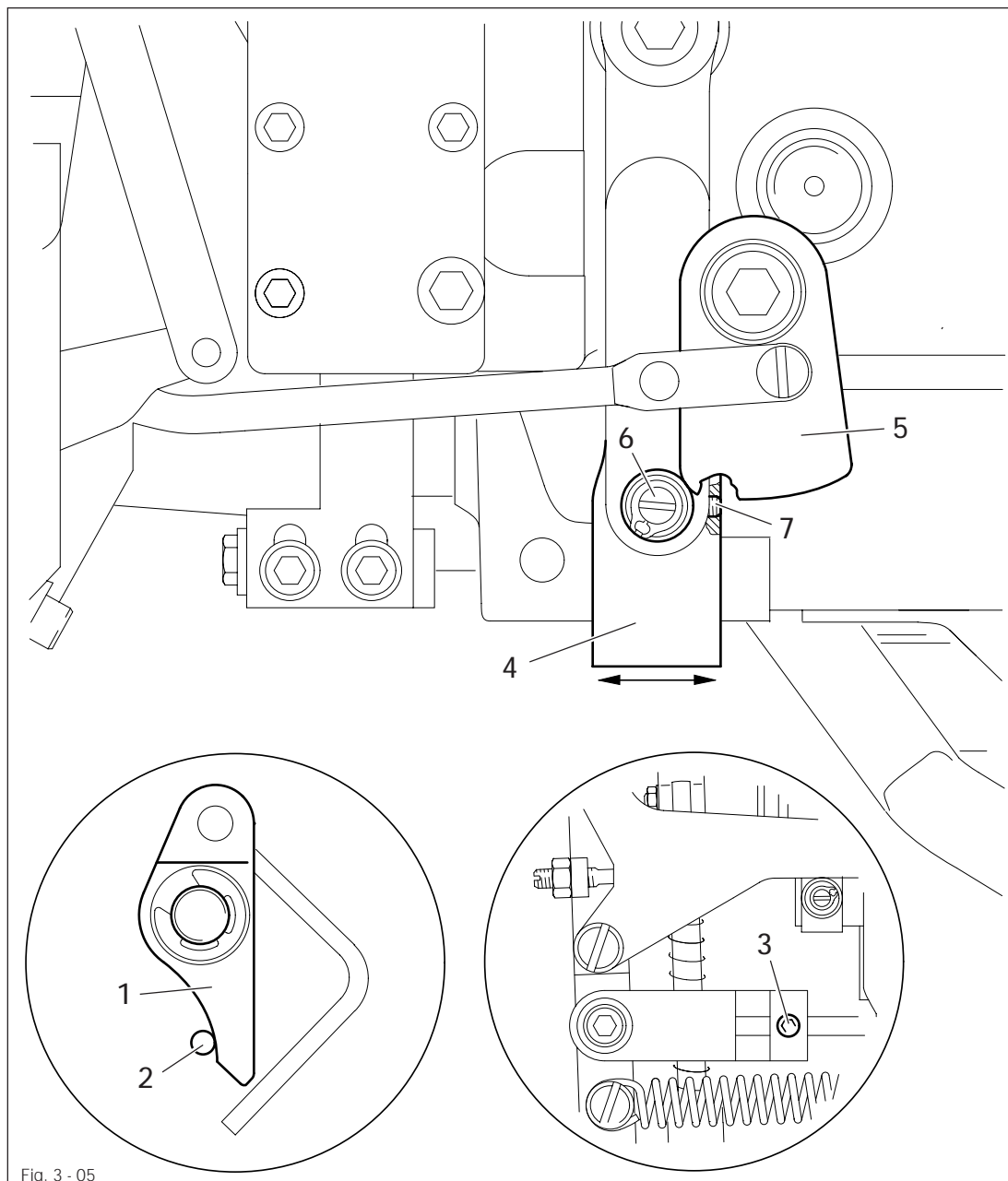
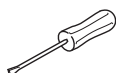

Fig. 3 - 05



- Engage the stop motion device.
- Loosen screws 3 and 7.
- Turn eccentric 6 so the the biggest eccentricity points to cam 5.
- Tighten screw 7.
- Move lever 4 in the direction of the arrow so that catch lever 1 touches pin 2 of the knife pawl.
- Put cam 5 against eccentric pin 6.
- Tighten screw 3.

Requirement

The stroke of the scissors between the switched-off machine (stop motion device engaged) and controller notch position 1 should be 4.5 mm.

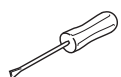
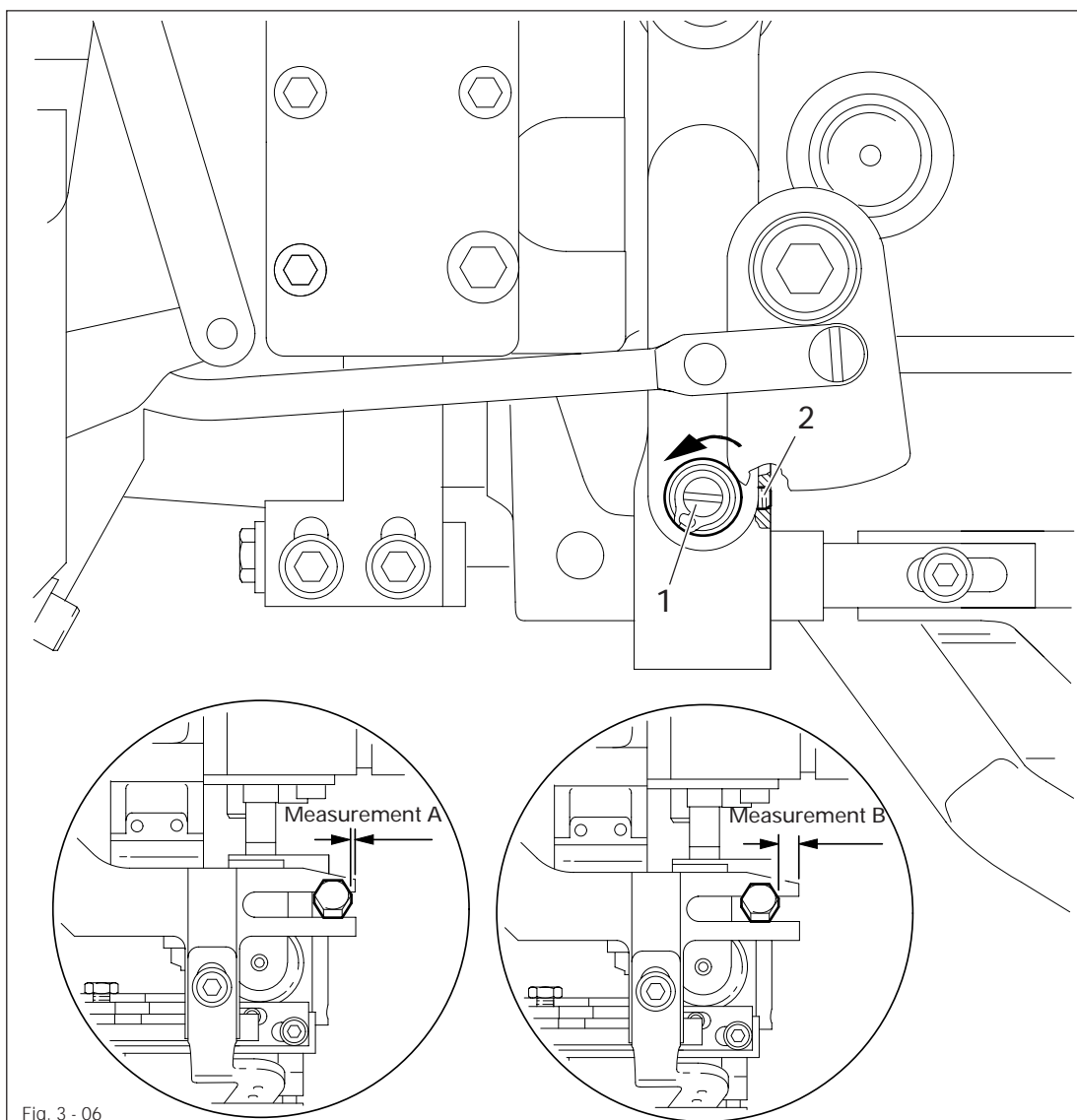

- Let the stop motion device fall into place and measure **measurement A**.
- Engage the stop motion device (**controller notch position 1**) and measure **measurement B**.
- Loosen screw **2**.
- Turn the eccentric pin until there is a difference of 4.5 mm between **measurement A** and **measurement B**.
- Tighten screw **2**.

3.09 Engaging lever

Requirement

1. When the stop motion device has fallen into place, screw 1 and lever 5 should be 0.5 mm apart.
2. When the right pedal is actuated (engaging lever 8 on stop 9), dogs 6 and 7 should be 0.5 mm apart.

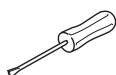
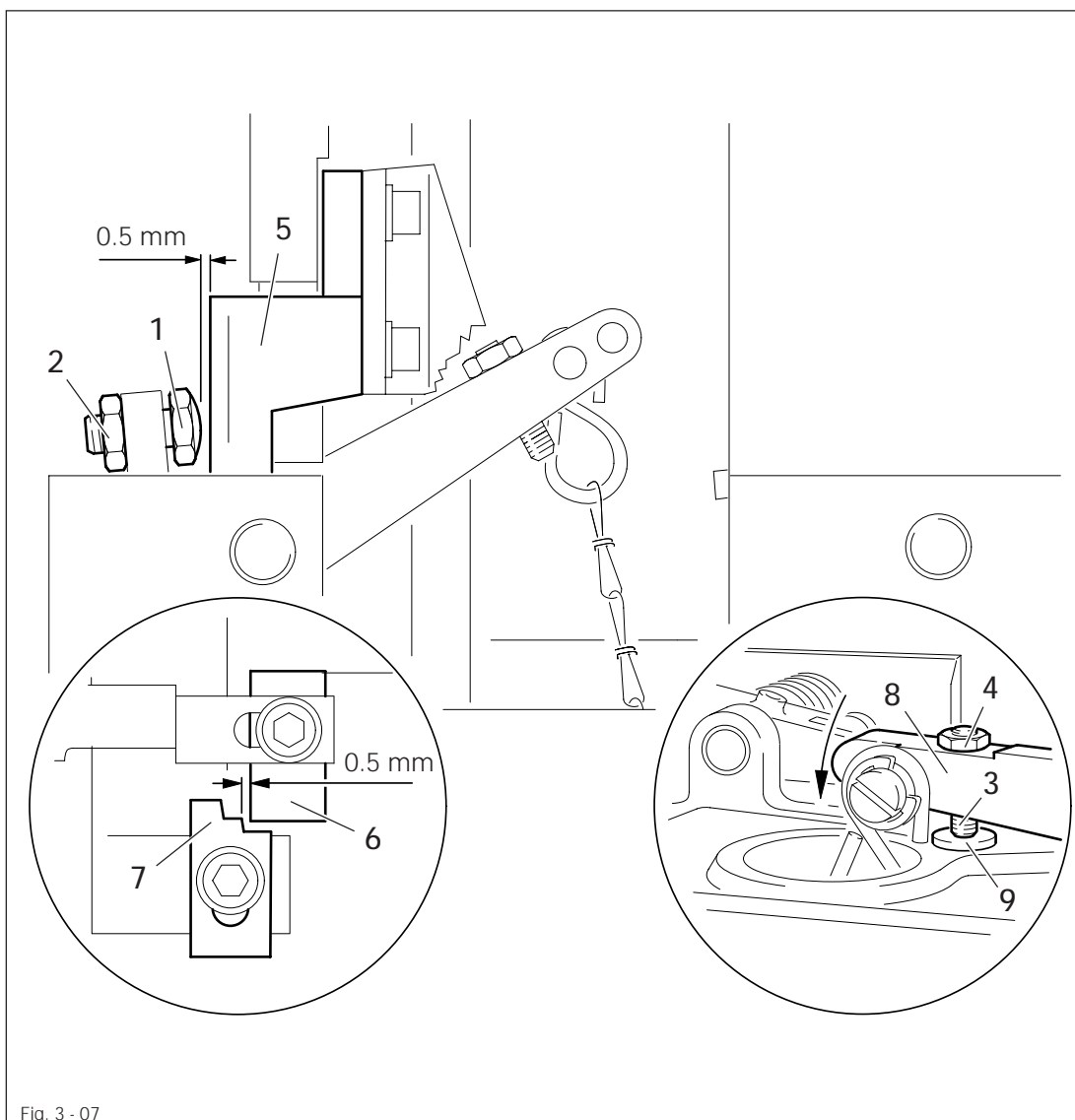

- Let the stop motion device fall into place.
- Loosen nut 2 and turn screw 1 according to **requirement 1**.
- Tighten nut 2.
- Bring engaging lever 8 to stop 9 by actuating the right pedal.
- Lie the sewing head on its back.
- Loosen nut 4 and turn screw 3 according to **requirement 2**.
- Tighten nut 4 and set the sewing head upright.



Use both hands when setting the sewing head upright.
Danger of crushing between the sewing head and the trough!

3.10 Presser bar lifting lever

Requirement

1. When the left pedal is in resting position, presser roller 3 and pressure area of lever 4 must be spaced at a distance of 0.5 mm.
2. When the left pedal is completely pressed down, the work clamp should rise 12.5 mm above the feeder.

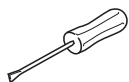
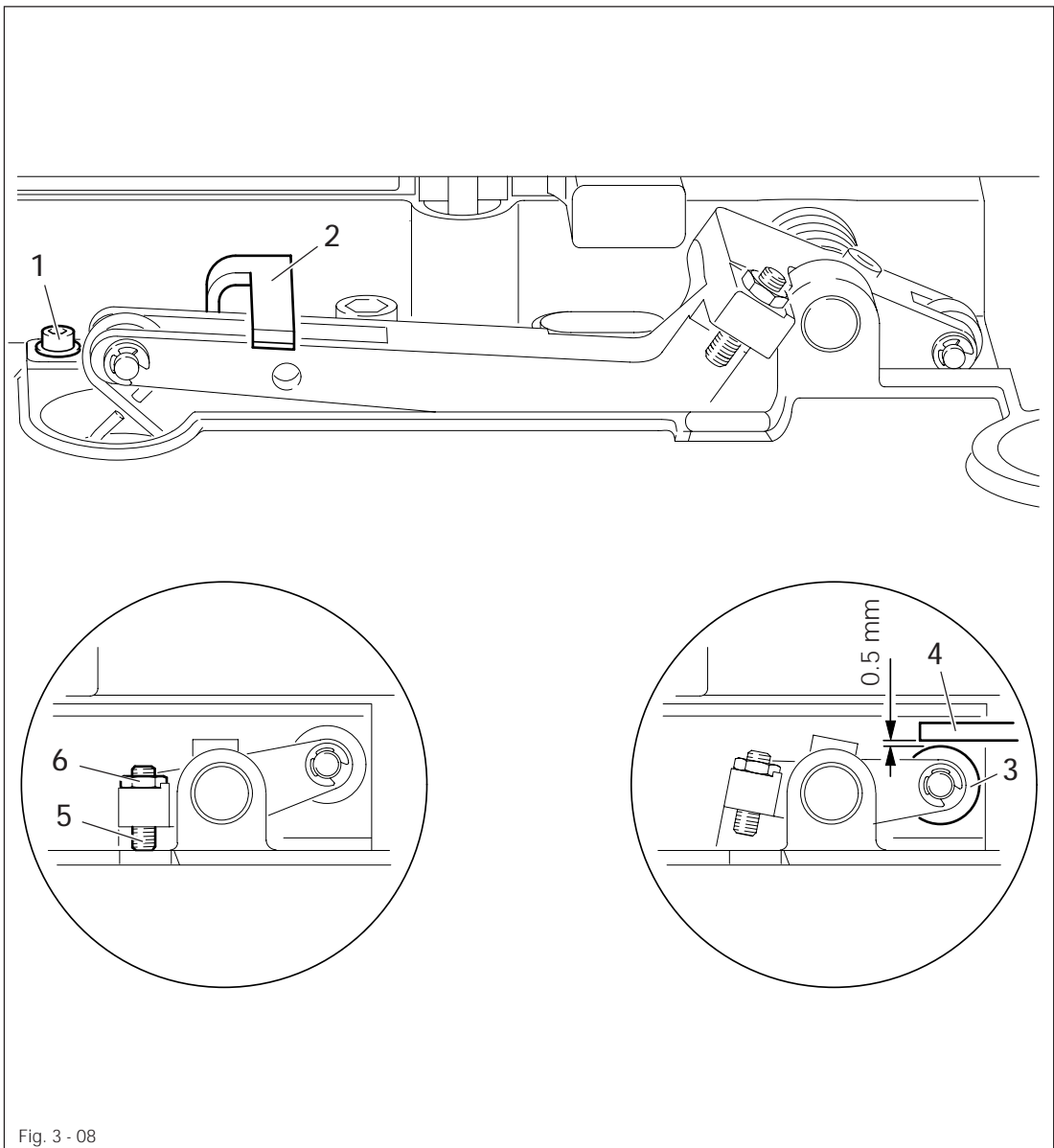

- Lie the sewing head on its back.
- Loosen screw 1 and move bracket 2 according to requirement 1.
- Tighten screw 1.
- Loosen nut 6 and turn screw 5 according to requirement 2.
- Tighten nut 6 and set the sewing head upright.



Use both hands when setting sewing head upright.
Danger of crushing between the sewing head and the trough!

3.11 Lifting and starting lock

Requirement

1. When the stop motion device has fallen into place, the lifting and starting lock 2 and the lifting device 1 should be 0.3 mm apart.
2. When the machine is engaged in controller notch position 2, the lifting and starting lock 2 and the lifting device 1 should be 0.3 mm apart.

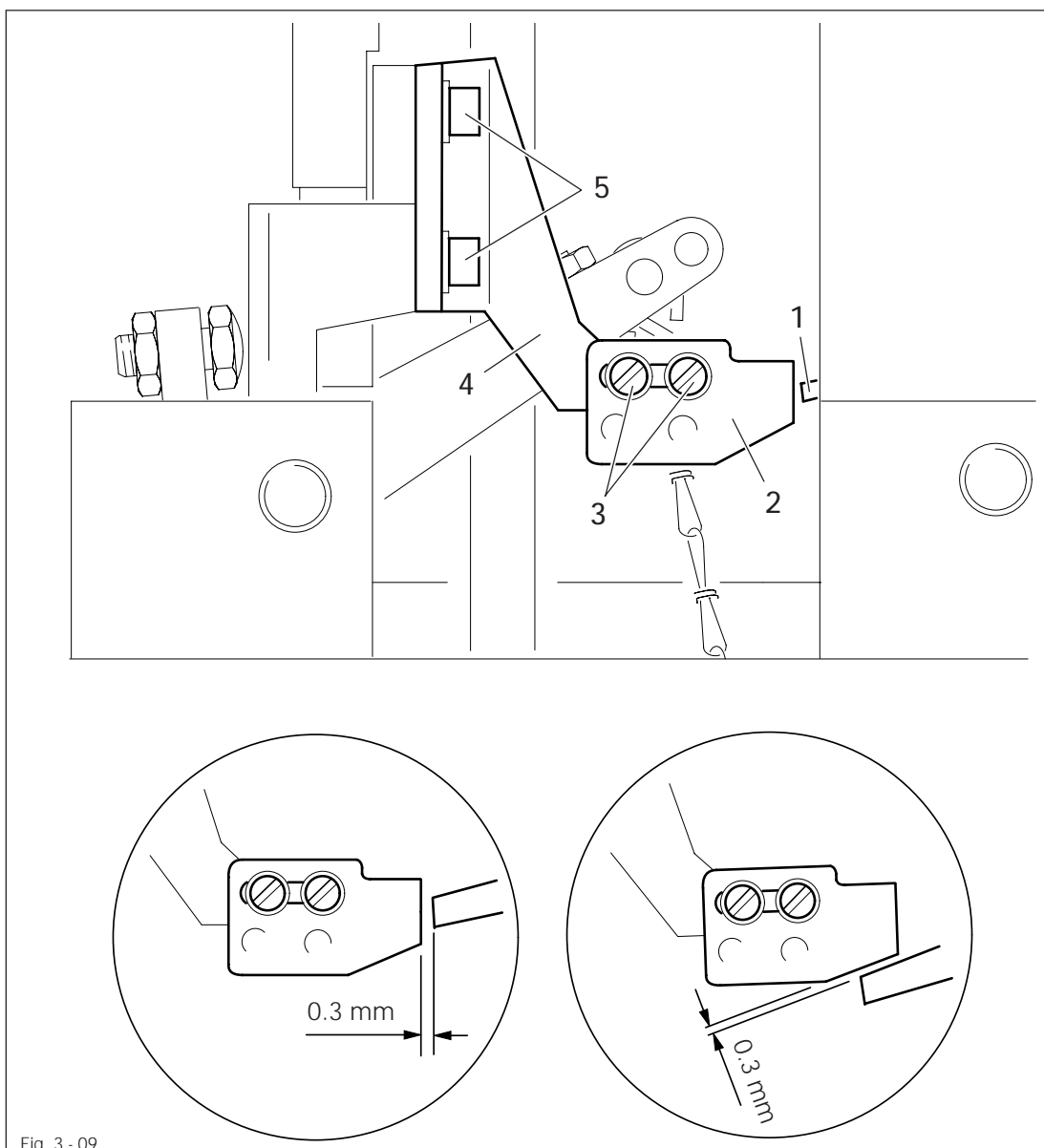
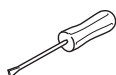

Fig. 3 - 09



- Press the left pedal until the lifting device 1 is centred with respect to the lifting and starting lock 2.
- Loosen screws 3.
- Move lifting and starting lock 2 according to requirement 1.
- Tighten screws 3.
- Engage stop motion device.
- Loosen screws 5 and move holding device 4 according to requirement 2.
- Tighten screws 5.

3.12 Mounting and dismounting the belts

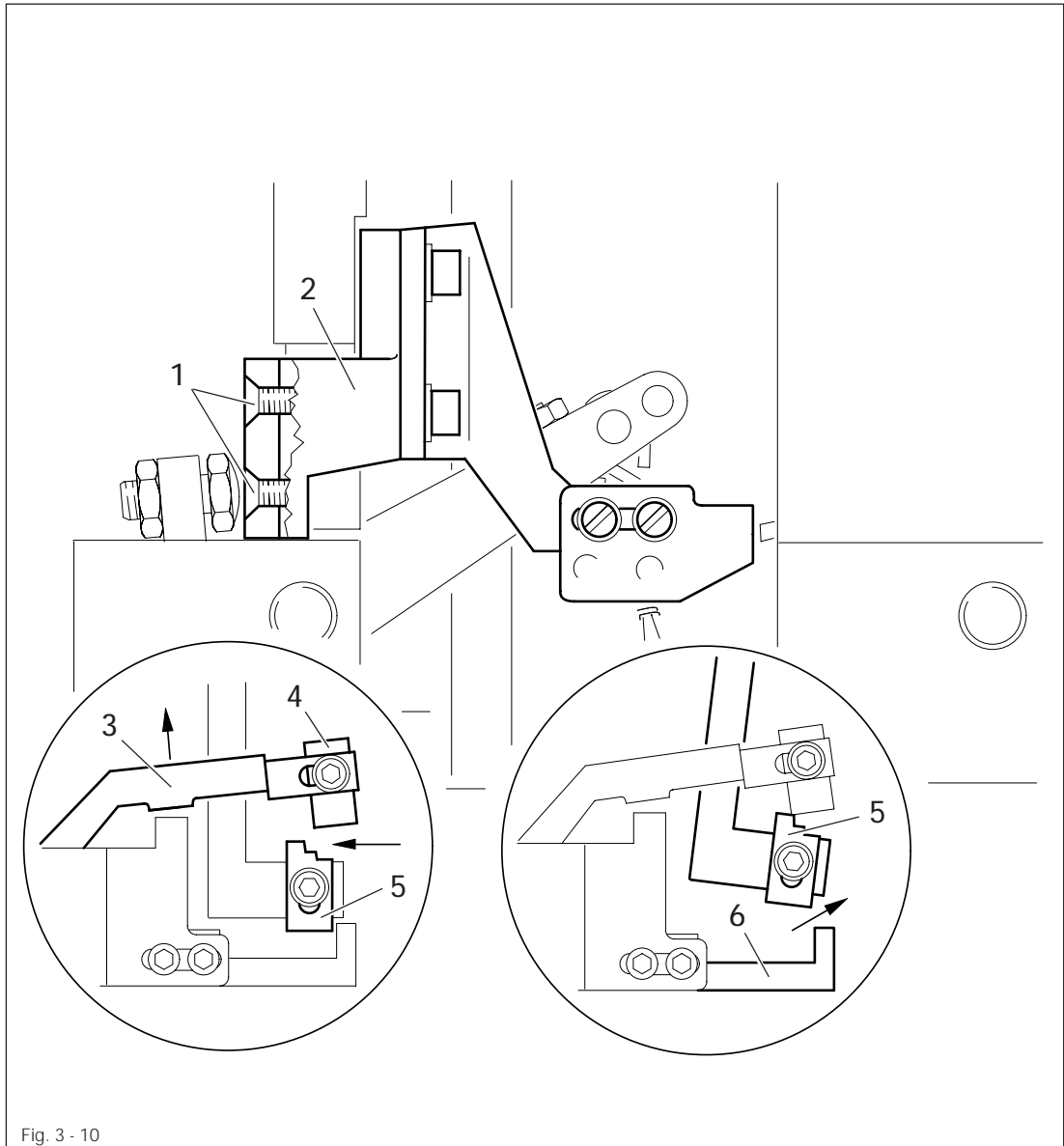
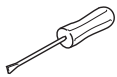

Fig. 3 - 10



- In order to dismount the belts, loosen screws 1 and dismount the lifting and starting lock 2.
- Lie the sewing head on its back.
- Take the long belt off the pulleys.
- Disengage the stop motion device by lifting the disengaging lever 3 and pull the belt through the gap between dogs 4 and 5.
- Engage stop motion device and pull belt through the gap between dog 5 and interlock 6.
- Use the same procedure for the short belt.
- To mount the belts, carry out the above steps in reverse order.
- Mount lifting and starting lock 2 and secure it by tightening screws 1.



Use both hands when setting sewing head upright.
Danger of crushing between the sewing head and the trough!

3.13

Mounting the belt guard and aligning the belt catchers

Requirement

1. The belt guard 5 should be mounted in such a way that the distance between the belt guard and the table top 4 is 10 mm.
2. Belt catchers 1 and 2 should be mounted in such a way that the distance between the driving belt 6 and belt catchers 1 and 2 is approx. 5 mm.

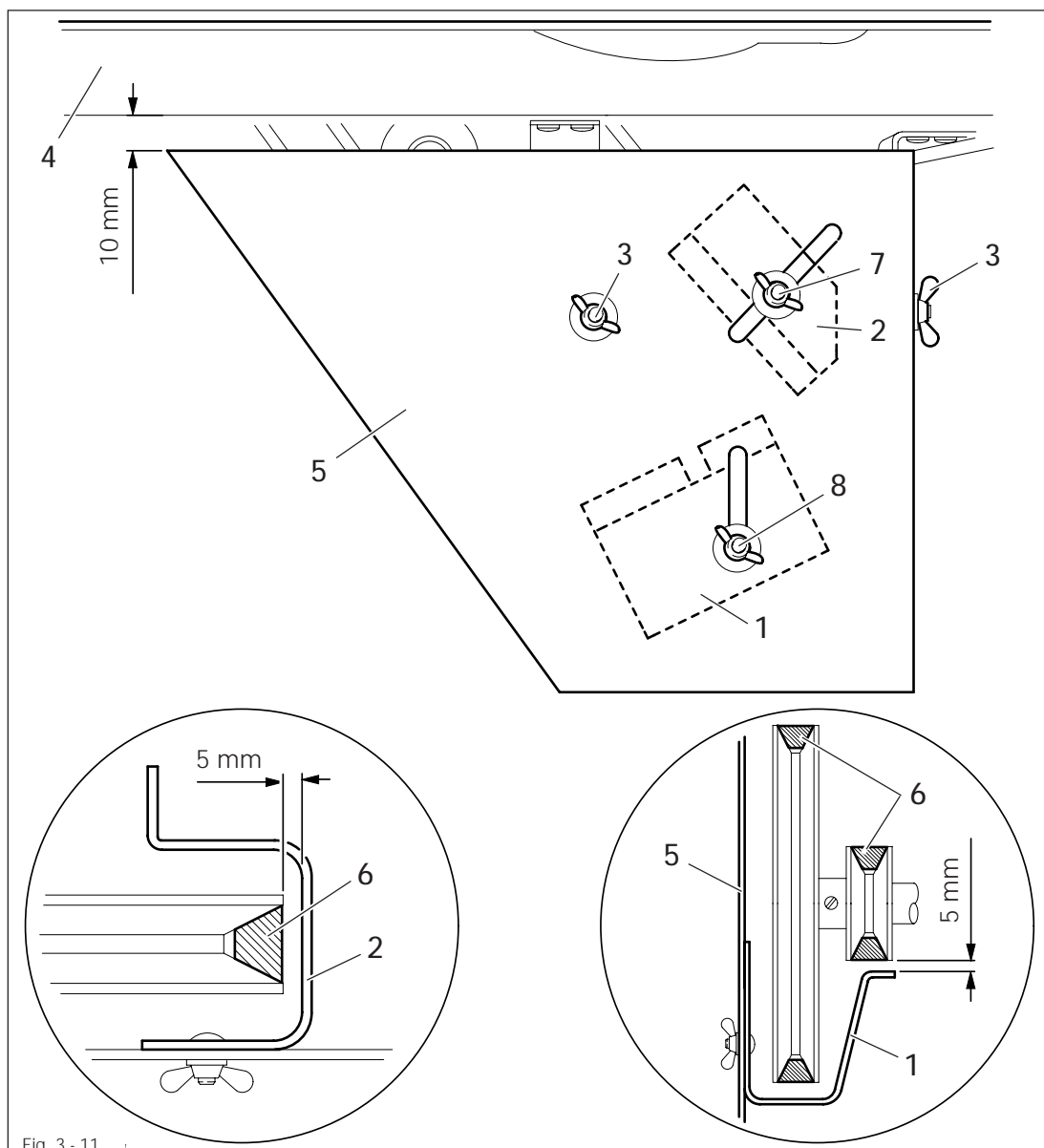
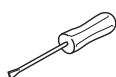

Fig. 3 - 11



- Align belt guard 5 according to requirement 1 and tighten screws 3.
- Loosen screws 7 and 8.
- Move belt catchers 1 and 2 according to requirement 2.
- Tighten screws 7 and 8.



The belts must not fall off the pulley when lying the sewing head on its back.

3.14 Taking up belt slack

Requirement

The tension of the belts should be such that they can be pressed together **approx. 4 cm** in the middle.

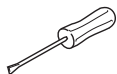
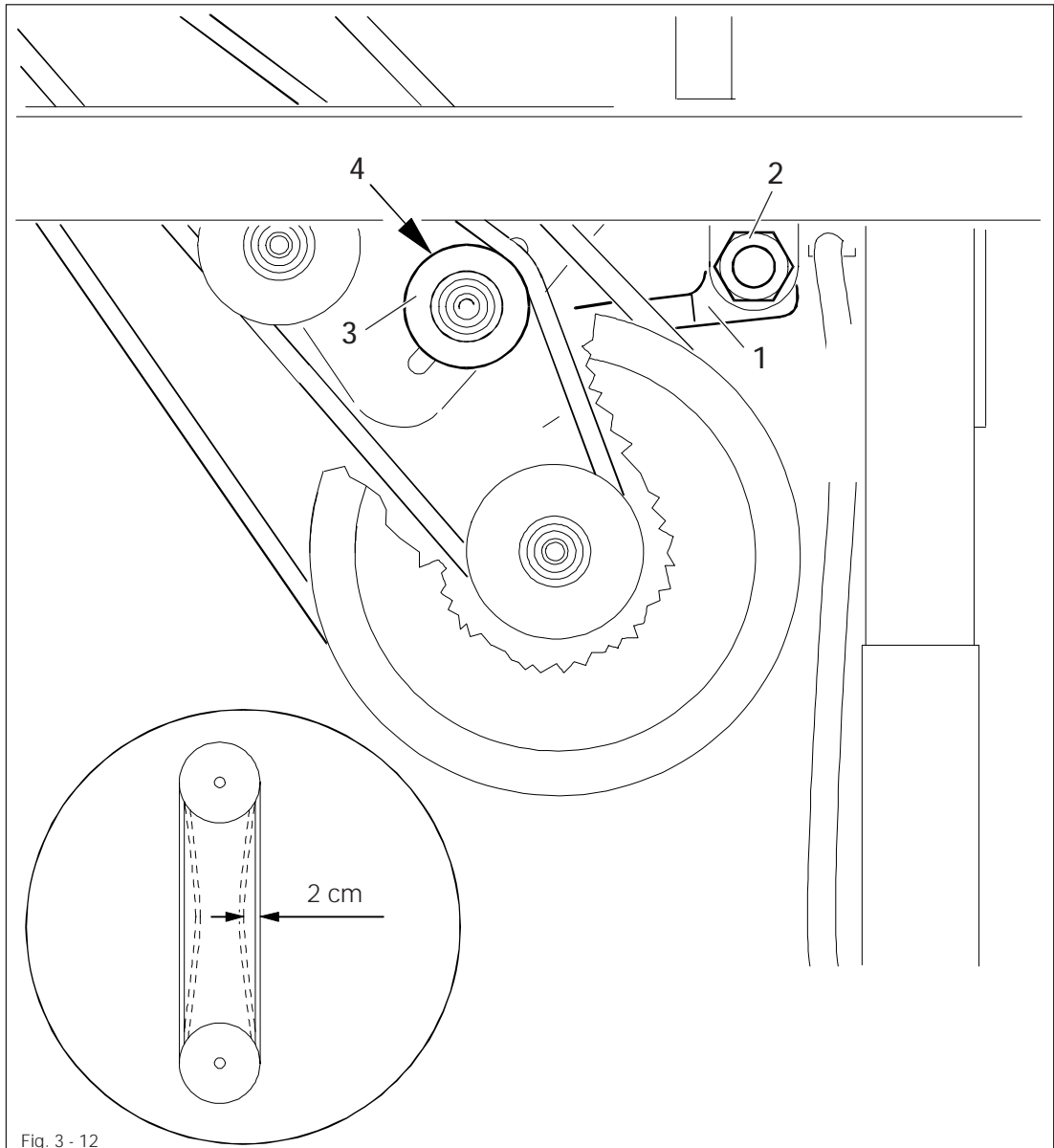

To adjust the tension of the long belt:

- Loosen nut 2, swivel belt take-up hanger according to the **requirement** and tighten nut 2.

To adjust the tension of the short belt:

- Loosen screw 4, move pulley 3 according to the **requirement** in the elongated hole and tighten screw 4.



Excessive tension of the belts has a negative influence on the functioning of the driving pulleys.

PFAFF

**G.M. PFAFF
Aktiengesellschaft**

Postfach 3020
D-67653 Kaiserslautern

Königstr. 154
D-67655 Kaiserslautern

Telefon: (0631) 200-0
Telefax: (0631) 172 02
Telex: 45753 PFAFF D

Gedruckt in der BRD
Printed in Germany
Imprimé en R.F.A.
Impreso en la R.F.A.
Stampato in R.F.G.
отпечатано ФРГ