

# PFAFF

5704

5714

Instruction Manual

5716

5742

This instruction manual applies to machines from the following serial numbers onwards:

# 6001 000 →



This Instruction Manual is valid for all models and subclasses listed in the chapter " Specifications ".

The reprinting, copying or translation of PFAFF Instruction Manuals, whether in whole or in part, is only permitted with our previous authorization and with written reference to the source.

## **PFAFF Industrie Maschinen AG**

Postfach 3020

D-67653 Kaiserslautern

Königstr. 154

D-67655 Kaiserslautern

Contents .....		Chapter - Page
<b>1</b>	<b>Safety .....</b>	<b>1 - 1</b>
1.01	Regulations .....	1 - 1
1.02	General notes on safety .....	1 - 1
1.03	Safety symbols .....	1 - 2
1.04	Important notes for the user .....	1 - 2
1.05	Notes for operating and technical staff .....	1 - 3
1.05.01	Operating staff .....	1 - 3
1.05.02	Technical staff .....	1 - 3
1.06	Danger warnings .....	1 - 4
<b>2</b>	<b>Proper use .....</b>	<b>2 - 1</b>
<b>3</b>	<b>Specifications .....</b>	<b>3 - 1</b>
3.01	General specifications .....	3 - 1
3.02	Specifications of the PFAFF 5704 .....	3 - 2
3.03	Specifications of the PFAFF 5714 .....	3 - 2
3.04	Specifications of the PFAFF 5716 .....	3 - 3
3.05	Specifications of the PFAFF 5742 .....	3 - 3
<b>4</b>	<b>Disposal of the machine .....</b>	<b>4 - 1</b>
<b>5</b>	<b>Transport, packaging and storage .....</b>	<b>5 - 1</b>
5.01	Transport to the customer .....	5 - 1
5.02	Transport within the customer's premises .....	5 - 1
5.03	Disposal of the packaging .....	5 - 1
5.04	Storage .....	5 - 1
<b>6</b>	<b>Explanation of the symbols .....</b>	<b>6 - 1</b>
<b>7</b>	<b>Control elements .....</b>	<b>7 - 1</b>
7.01	Main switch .....	7 - 1
7.02	Pedal .....	7 - 1
7.03	Balance wheel .....	7 - 2
7.04	Sewing foot retracting lever .....	7 - 2
7.05	Cloth plate stop lever .....	7 - 3
7.06	Stop button for stitch length adjustment .....	7 - 3
7.07	Lever for setting the fullness .....	7 - 4
<b>8</b>	<b>Mounting and commissioning the machine .....</b>	<b>8 - 1</b>
8.01	Installation .....	8 - 1
8.01.01	Adjusting the table height .....	8 - 1
8.01.02	Table top drill hole plans (for mid-height assembly) .....	8 - 2
8.01.03	Table top cut-out (for mid-height assembly) .....	8 - 3
8.01.04	Sewing head support plate (for mid-height assembly) .....	8 - 4
8.01.05	Table top drill hole plans (for assembly level with the table top) .....	8 - 5
8.01.06	Table top cut-out (for assembly level with the table top) .....	8 - 6

	Contents .....	Chapter - Page
8.01.07	Mounting the table top .....	8 - 7
8.01.08	Tightening the V-belt .....	8 - 8
8.01.09	Fitting the top belt guard .....	8 - 8
8.01.10	Fitting the bottom belt guard .....	8 - 9
8.01.11	Chain for securing the pedal .....	8 - 9
8.01.12	Mounting the reel stand .....	8 - 10
8.02	Commissioning .....	8 - 11
8.03	Switching the machine on/off .....	8 - 11
<b>9</b>	<b>Preparation .....</b>	<b>9 - 1</b>
9.01	Inserting the needle .....	9 - 1
9.02	Threading the needle thread .....	9 - 1
9.02.01	Threading diagram for the PFAFF 5704 .....	9 - 2
9.02.02	Threading diagram for the PFAFF 5714 .....	9 - 2
9.02.03	Threading diagram for the PFAFF 5716 .....	9 - 3
9.02.04	Threading diagram for the PFAFF 5742 .....	9 - 3
9.03	Adjusting the stitch length .....	9 - 4
9.04	Adjusting the fullness .....	9 - 4
9.05	Adjusting the sewing foot pressure .....	9 - 5
<b>10</b>	<b>Care and maintenance .....</b>	<b>10 - 1</b>
10.01	Maintenance intervals .....	10 - 1
10.02	Cleaning the machine .....	10 - 1
10.03	Cleaning the hook compartment .....	10 - 2
10.04	Checking the oil level .....	10 - 2
10.05	Changing the oil .....	10 - 3
10.06	Oiling the thread lubrication .....	10 - 4
10.07	Oiling the machine .....	10 - 5
10.08	Changing the knife .....	10 - 6
<b>11</b>	<b>Adjustment .....</b>	<b>11 - 1</b>
11.01	Notes on adjustment .....	11 - 1
11.02	Tools, gauges and other accessories .....	11 - 1
11.03	Settings on the PFAFF 5704 .....	11 - 1
11.04	Settings on the PFAFF 5714 .....	11 - 2
11.05	Settings on the PFAFF 5716 .....	11 - 2
11.06	Settings on the PFAFF 5742 .....	11 - 2
<b>12</b>	<b>Wearing parts .....</b>	<b>12 - 1</b>

## 1 Safety

### 1.01 Regulations

This machine is constructed in accordance with the European regulations indicated in the conformity and manufacturer's declarations.

In addition to this instruction manual, please also observe all generally accepted, statutory and other legal requirements, including those of the user's country, and the applicable pollution control regulations!

The valid regulations of the regional social insurance society for occupational accidents or other supervisory authorities are to be strictly adhered to!

### 1.02 General notes on safety

- The machine must only be operated by adequately trained operators and only when the instruction manual has been fully read and understood!
- All notices on safety and the instruction manual of the motor manufacturer are to be read before the machine is put into operation!
- All notes on the machine concerning danger and safety must be observed!
- The machine must be used for the purpose for which it is intended and must not be operated without its safety devices; all regulations relevant to safety must be adhered to.
- When part sets are changed (e.g. needle, presser foot, needle plate or feed dog), during threading, when the workplace is left unattended and during maintenance work, the machine must be disconnected from the power supply by turning off the on/off switch or removing the plug from the mains!
- Daily maintenance work must only be carried out by appropriately trained persons!
- Repairs and special maintenance work must only be carried out by qualified technical staff or persons with appropriate training!
- During maintenance or repairs on the pneumatic system the machine must be disconnected from the compressed air supply! The only exception to this is when adjustments or function checks are carried out by appropriately trained technical staff!
- Work on the electrical equipment must only be carried out by technical staff who are qualified to do so!
- Work on parts or equipment connected to the power supply is not permitted! The only exceptions to this are specified in regulations EN 50110.
- Conversion or modification of the machine must only be carried out under observation of all relevant safety regulations!

- Only spare parts which have been approved by us are to be used for repairs! We draw special attention to the fact that spare parts and accessories not supplied by us have not been subjected to testing nor approval by us. Fitting and/or use of any such parts may cause negative changes to the design characteristics of the machine. We shall not accept any liability for damage caused by the use of non-original parts.

## 1.03 Safety symbols



Danger!  
Special points to observe.



Danger of injury to operating or technical staff!



### Caution

Do not operate without finger guard and safety devices. Before threading, changing needle, cleaning etc. switch off main switch.

## 1.04 Important notes for the user

- This instruction manual belongs to the equipment of the machine and must be available to the operating staff at all times.  
This instruction manual must be read before the machine is operated for the first time.
- Both operating and technical staff must be instructed on the safety devices of the machine and on safe working methods.
- It is the duty of the user to operate the machine in perfect running order only.
- The user must ensure that none of the safety devices are removed nor put out of working order.
- The user must ensure that only authorized persons operate and work on the machine.

For further information please refer to your PFAFF agency.

## 1.05 Notes for operating and technical staff

### 1.05.01 Operating staff

Operating staff are the persons responsible for setting up, operating and cleaning the machine and for removing any disturbances in the sewing area.

The operating staff are obliged to observe the following points, and must:

- always observe the notes on safety in this instruction manual!
- avoid using any working methods which adversely effect the safety of the machine!
- avoid wearing loose-fitting clothing or jewelry such as necklaces or rings!
- also ensure that only authorized persons are allowed near the danger area of the machine!
- immediately report to the user any changes to the machine that may affect its safety!

### 1.05.02 Technical staff

Technical staff are persons who have been trained in electrical engineering, electronics, pneumatics and mechanical engineering. They are responsible for lubricating, servicing, repairing and adjusting the machine.

The technical staff are obliged to observe the following points, and must:

- always observe the notes on safety in this instruction manual!
- switch off the on/off switch before carrying out adjustment and repair work and ensure it cannot be switched on again unintentionally!
- never work on parts or equipment still connected to the power supply! Exceptions to this are only permissible according to regulations EN 50110;
- disconnected the machine from the compressed air supply when carrying out maintenance or repair work on pneumatic equipment!  
Exceptions to this are only permissible for function checks;
- replace all safety covers after carrying out maintenance or repair work!

## 1.06

### Danger warnings



A working area of 1 m must be kept free both in front of and behind the machine, so that easy access is possible at all times.



Never put your hands in the sewing area during sewing!  
Danger of injury by the needle!



While setting or adjusting the machine do not leave any objects on the table nor in the needle plate area! Objects may be trapped or slung out of the machine!

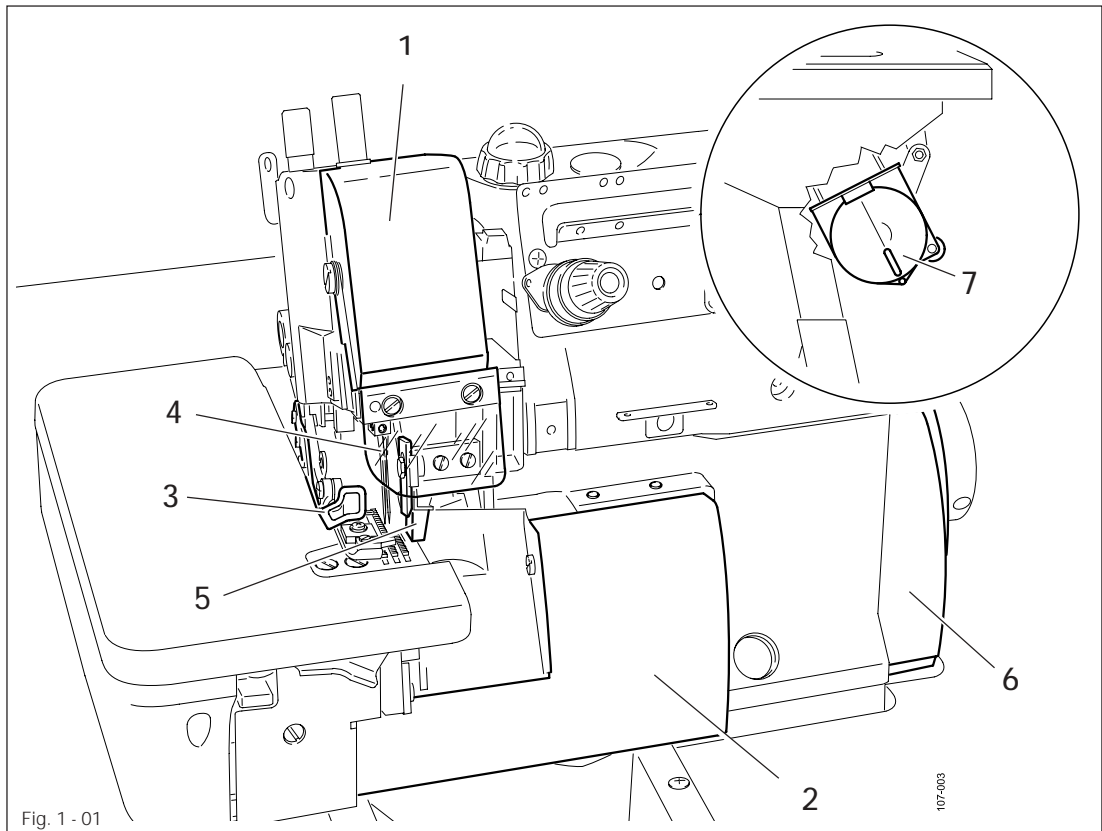

Fig. 1 - 01

107-003



Only operate the machine with covers 1 and 2 closed!  
Danger of injury from moving machine parts!



Do not operate the machine without finger guard 3!  
Danger of injury from the needle!



Do not operate the machine without eye shield 4!  
Danger of injury from needle fragments which might fly out!



Do not place hands in the knife area 5! Danger of injury from the knife!



Do not operate the machine without belt covers 6 and 7!  
Danger of injury from the drive belts!



2

**Proper use**

The PFAFF 5704 is a single needle, overlock sewing machine with differential bottom feed and is used for sewing closing and serging seams.

The PFAFF 5714 is a two needle, overlock sewing machine with differential bottom feed and is used for sewing closing and serging seams.

The PFAFF 5716 is a two needle, safety-stitch machine with differential bottom feed and is used for sewing closing seams.

The PFAFF 5742 is a two needle, two-thread chainstitch sewing machine with differential bottom feed and is used for binding pocket pouches etc.



Any and all uses of this machine which have not been approved of by the manufacturer are considered to be inappropriate! The manufacturer cannot be held liable for any damage caused by the inappropriate use of the machine! The appropriate use of the machine includes the observance of all operational, adjustment, maintenance and repair measures required by the manufacturer!

## 3 Specifications

### 3.01 General specifications <sup>▲</sup>

Stitch type: ..... see table  
Needle system: ..... DCx27  
Needle size: ..... 65 – 130 Nm (#9-21)

Power supply: ..... 220 V ± 10%, 50/60 Hz, single phase  
Power consumption: ..... min. 0.37 kVA  
Electrical power rating: ..... see motor identification plate  
Fuse protection: ..... see motor identification plate

Noise data:  
Noise emission level at workplace  
At a speed of 4800 spm: .....  $L_{pa} = 74.5 \text{ dB(A)}$  <sup>■</sup>  
(Noise measurement in accordance with DIN 45 635-48-B-1, ISO 11204, ISO 3744, ISO 4871)

Sewing head dimensions:  
Length: ..... approx. 300 mm  
Width: ..... approx. 370 mm  
Height: ..... approx. 250 mm

Standard base dimensions:  
Length: ..... approx. 1060 mm  
Width: ..... approx. 600 mm  
Height: ..... approx. 820 mm

Packaging dimensions (sewing head only):  
Length: ..... approx. 478 mm  
Width: ..... approx. 400 mm  
Height: ..... approx. 355 mm

Gross weight of sewing head (with packaging): ..... approx. 45 kilos

<sup>▲</sup> Subject to alterations

<sup>■</sup>  $K_{pA} = 2,5 \text{ dB}$

3.02 Specifications of the PFAFF 5704 ▲

Sub-class	Number of needles	Number of threads	Needle gauge (mm)	Seam width (mm)	Stitch length (mm)	Material clearance (mm)	Max. sewing speed (spm)	Stitch type
5704-01	1	3	-	4	0,5 - 3,8	5,5	7.000	505
5704-16S2	1	3	-	1,5	0,5 - 3,8	5,5	6.500	504
5704-17A	1	3	-	4	0,5 - 3,8	5,5	7.000	504
5704-180	1	3	-	4	0,5 - 3,8	3,5	7.000	504

▲ Subject to alterations

3.03 Specifications of the PFAFF 5714 ▲

Sub-class	Number of needles	Number of threads	Needle gauge (mm)	Seam width (mm)	Stitch length (mm)	Material clearance (mm)	Max. sewing speed (spm)	Stitch type
5714-13A	2	4	2	6	0,5 - 3,8	5,5	6.500	514
5714-13H	2	4	2	8	0,5 - 3,8	5,5	6.500	514
5714-181	2	4	2	6	0,5 - 3,8	5,5	6.500	514

▲ Subject to alterations

# Specifications

## 3.04 Specifications of the PFAFF 5716 ▲

Sub-class	Number of needles	Number of threads	Needle gauge (mm)	Seam width (mm)	Stitch length (mm)	Material clearance (mm)	Max. sewing speed (spm)	Stitch type
5716-38A	2	5	3	4	0,5 - 3,8	5,5	6.500	516
5716-70A	2	5	5	5	0,5 - 3,8	5,5	6.500	516
5716-86A	2	5	5	6	0,6 - 5,3	5,5	5.500	516

▲ Subject to alterations

## 3.05 Specifications of the PFAFF 5742 ▲

Sub-class	Number of needles	Number of threads	Needle gauge (mm)	Seam width (mm)	Stitch length (mm)	Material clearance (mm)	Max. sewing speed (spm)	Stitch type
5742-02-250	2	4	5	-	0,5 - 3,8	3,5	6.000	2x401

▲ Subject to alterations

### 4 Disposal of machine

- The proper disposal of the machine is the responsibility of the customer.
- The materials used in the machines are steel, aluminium, brass and various plastics. The electrical equipment consists of plastics and copper.
- The machine is to be disposed of in accordance with the locally valid environmental protection regulations. If necessary, a specialist is to be commissioned.



Special care is to be taken that parts soiled with lubricants are separately disposed of in accordance with the locally valid pollution control regulations!

### 5 Transport, packaging and storage

#### 5.01 Transport to the customer's premises

The machines are delivered completely packed.

#### 5.02 Transport within the customer's premises

The manufacturer bears no liability for transport within the customer's premises or to the individual locations of use. Make sure that the machines are always transported upright.

#### 5.03 Disposal of the packaging

The packaging of these machines consists of paper, cardboard and VCE fiber. The proper disposal of the packaging is the responsibility of the customer.

#### 5.04 Storage

The machine can be stored for up to 6 months if not in use. During this time it should be protected from dust and moisture.

For longer storage the individual parts of the machine, especially the moving parts, must be protected from corrosion, e.g. by a film of oil.

### 6 Explanation of the symbols

In the following section of this Instruction Manual, certain tasks or important pieces of information are accentuated by symbols.

The symbols used have the following meanings:



Note, information



Cleaning, care



Lubrication, greasing

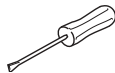

Servicing, repairing, adjustment, maintenance  
(only to be carried out by specialist personnel)

# Control elements

## 7 Control elements

### 7.01 Main switch

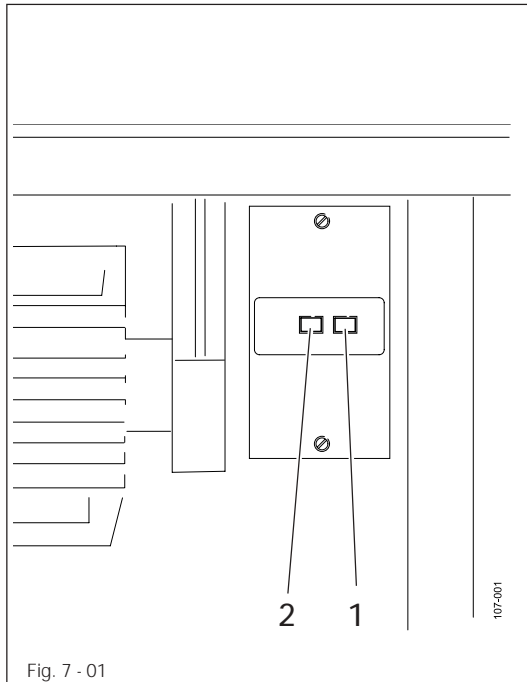

- The machine is switched on by pressing key 1 and switched off again by pressing key 2.

### 7.02 Pedal

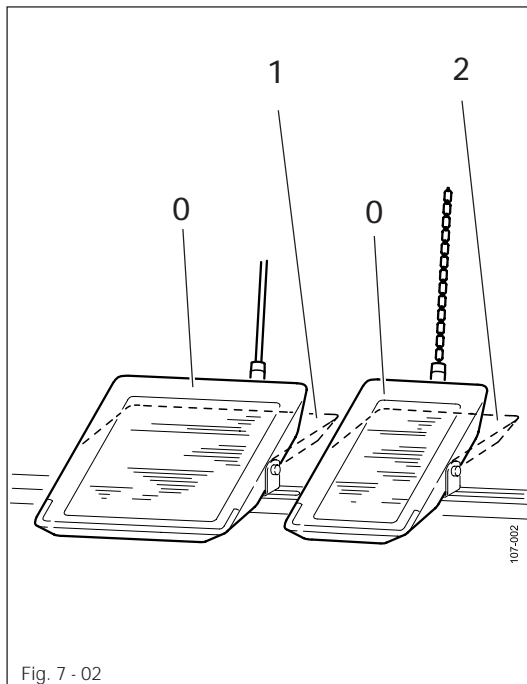

- 0 = Neutral position
- 1 = Sewing
- 2 = Raise sewing foot



7.03 Balance wheel

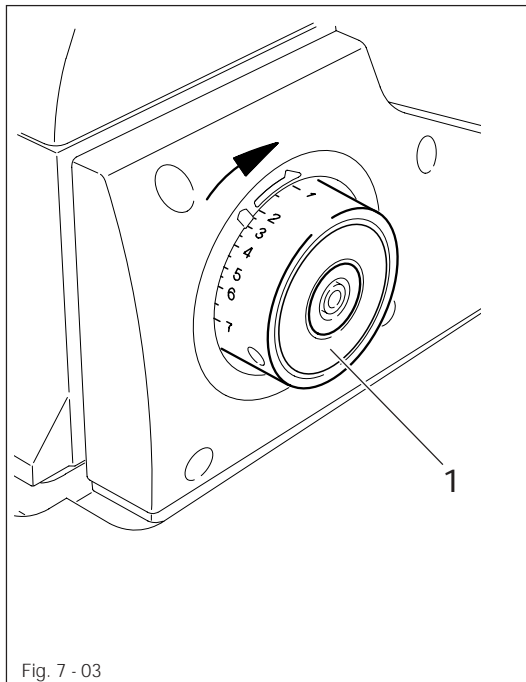

Fig. 7 - 03

- The needle bar is adjusted manually by turning the balance wheel 1 in the direction of the arrow.
- If the stop button for stitch length adjustment is pressed at the same time, by turning balance wheel 1 the stitch length is altered, see also Chapter 7.06 Stop button for stitch length adjustment and Chapter 9.03 Adjusting the stitch length.

7.04 Sewing foot retracting lever

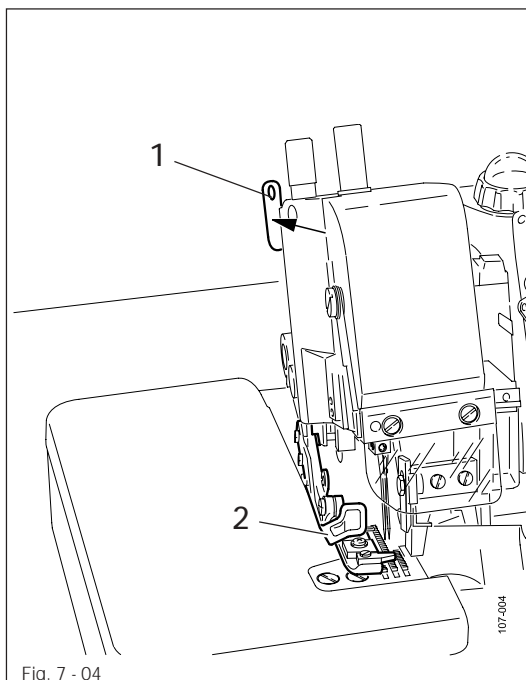

Fig. 7 - 04

- After pressing lever 1, the sewing foot 2 can be retracted.



Before retracting the sewing foot, raise the needle bar to its highest position by turning the balance wheel.

### 7.05 Cloth plate stop lever

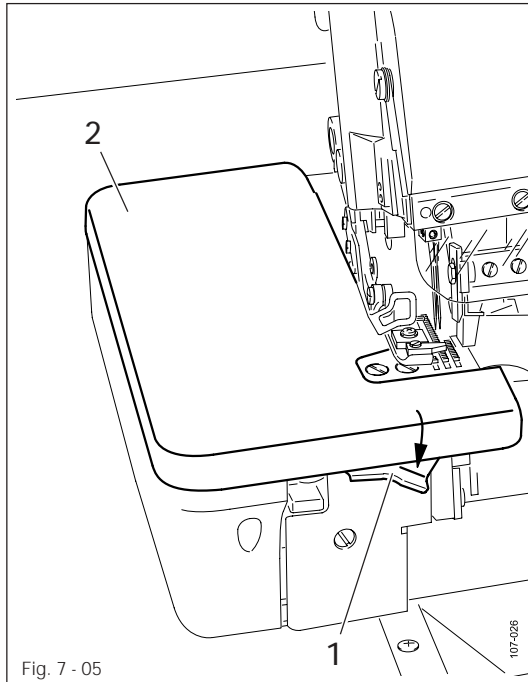

- After pressing lever 1, the cloth plate 2 can be retracted.

### 7.06 Stop button for stitch length adjustment

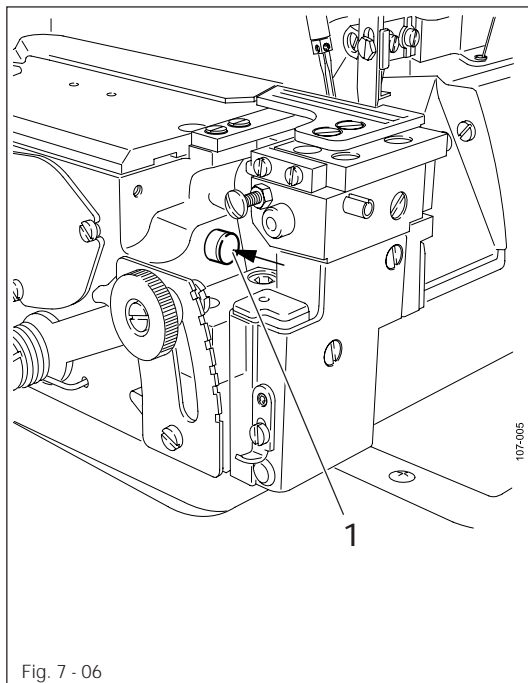

- To adjust the stitch length, press stop button 1 and turn the balance wheel at the same time, also see **Chapter 7.03 Balance wheel** and **Chapter 9.03 Adjusting the stitch length**.

7.07 Lever for setting the fullness

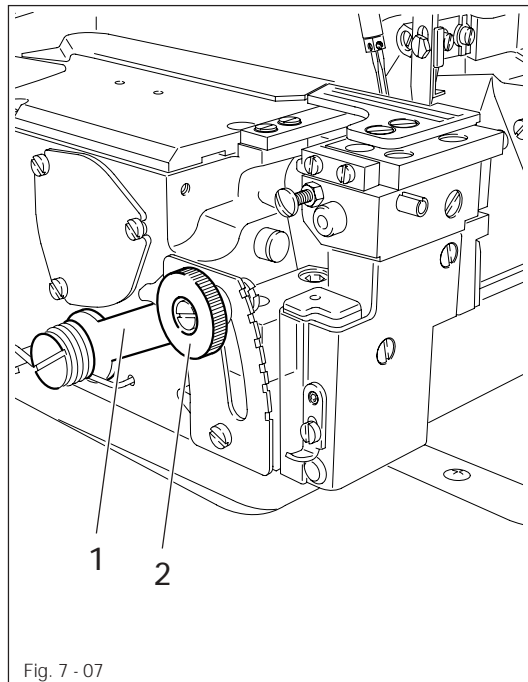

- To set the fullness, adjust lever 1. For the setting, nut 2 must be loosened and retightened afterwards (also see **Chapter 9.04 Setting the fullness**).

## 8 Mounting and commissioning the machine



The machine must only be mounted and commissioned by qualified personnel!  
All relevant safety regulations are to be observed!

If the machine is delivered without a table, be sure that the frame and the table top which you intend to use can hold the weight of the machine and the motor. It must be ensured that the supporting structure is sufficiently sturdy, even during sewing operations.

### 8.01 Installation

The site where the machine is installed must be provided with suitable connections for the electric current, see **Chapter 3 Specifications**.

It must also be ensured that the standing surface of the machine site is firm and horizontal, and that sufficient lighting is provided.



For packing reasons the table top is in the lowered position. The table height is adjusted as described below.

#### 8.01.01 Adjusting the table height

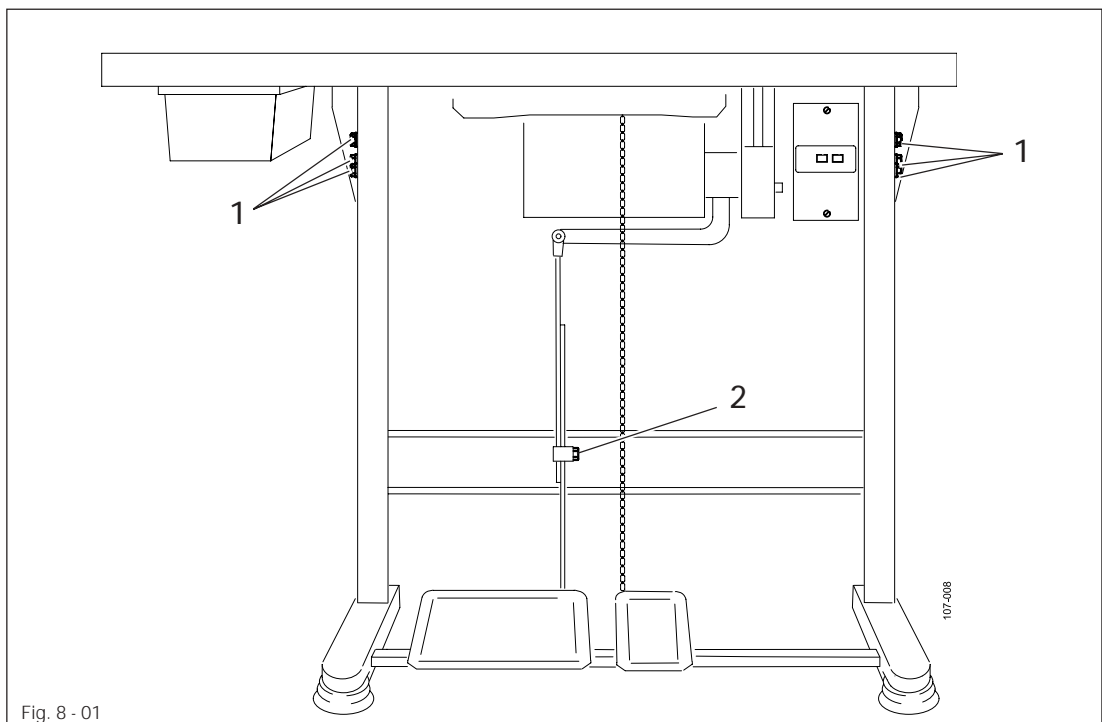

Fig. 8 - 01

- Loosen screws 1 and 2 and set the table height as required.
- Firmly tighten screw 1.
- Set the required pedal position and tighten screws 2.



# Mounting and commissioning the machine

8.01.03 Table top cut-out (for mid-height assembly)

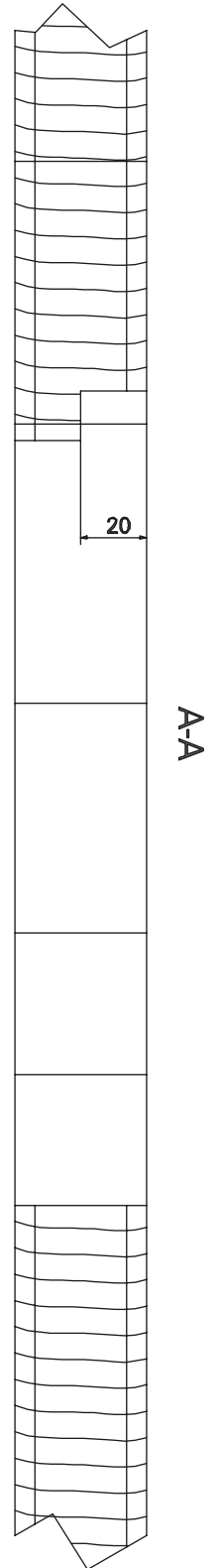
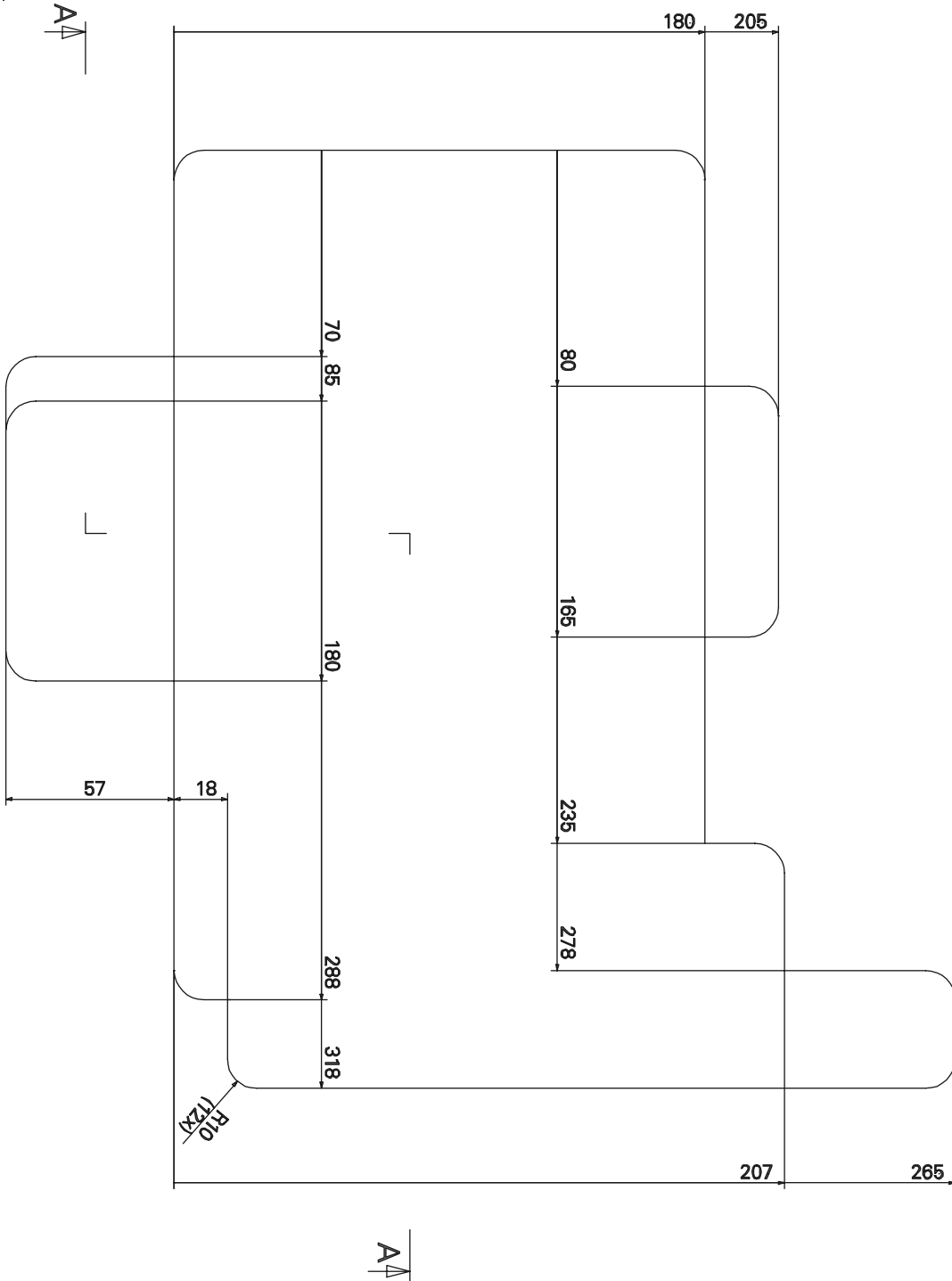



# Mounting and commissioning the machine

8.01.05 Table top drill hole plans (for assembly level with the table top)

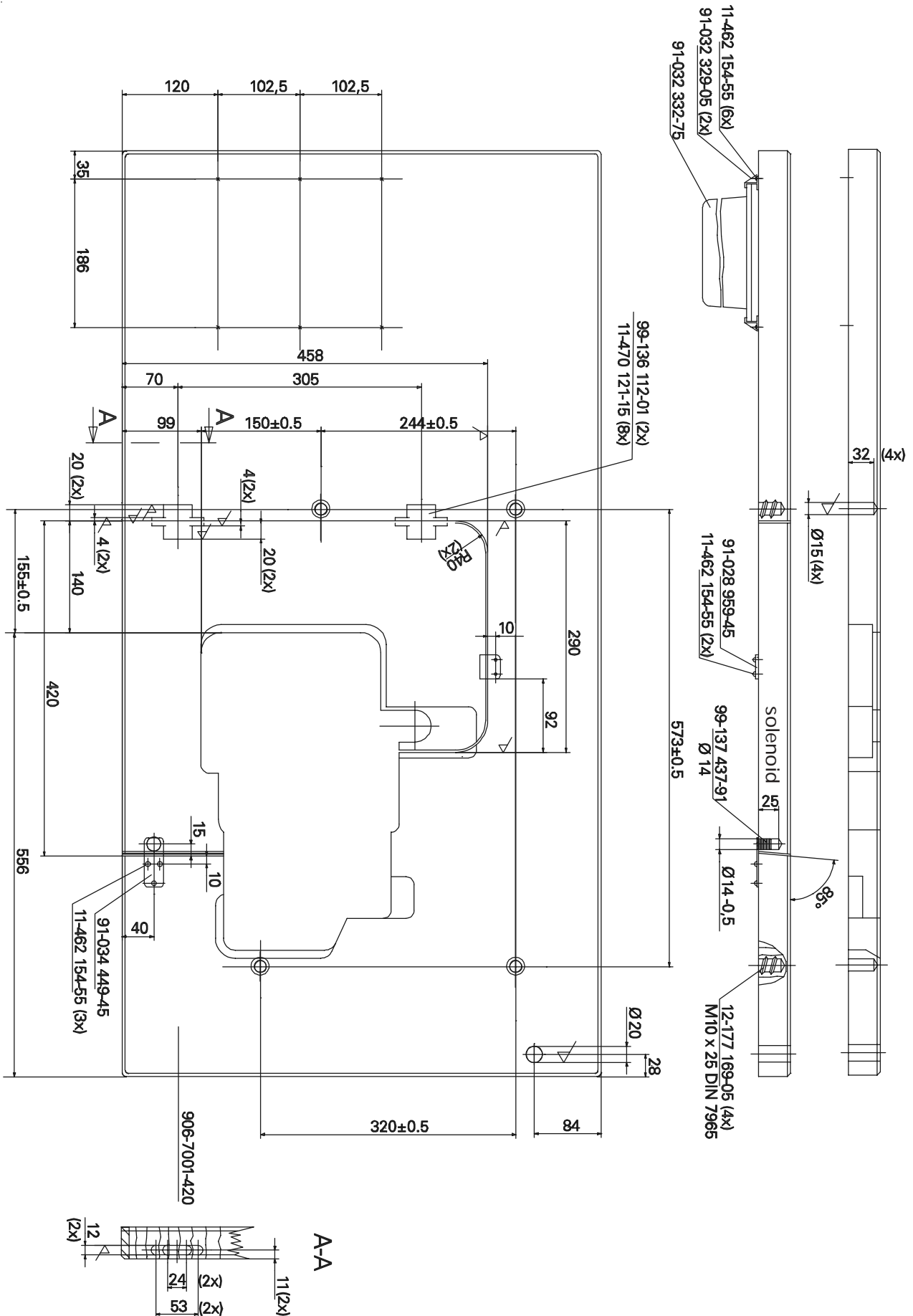



8.01.06 Table top cut-out (for assembly level with the table top)

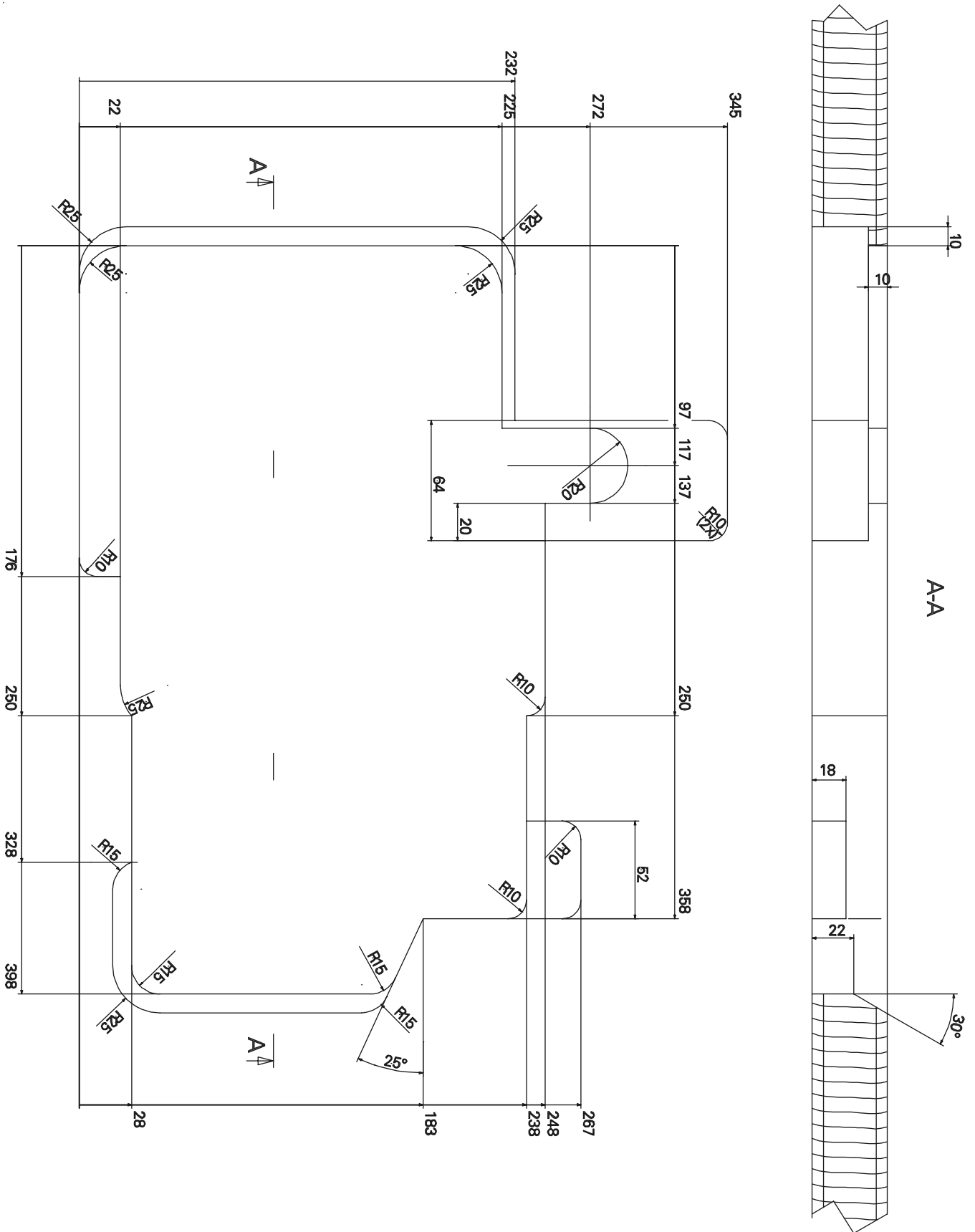

# Mounting and commissioning the machine

## 8.01.07 Mounting the table top



The diagram shows assembly level with the table top. If the table top is to be mounted in a lowered position, the machine support bracket is delivered with the table top.

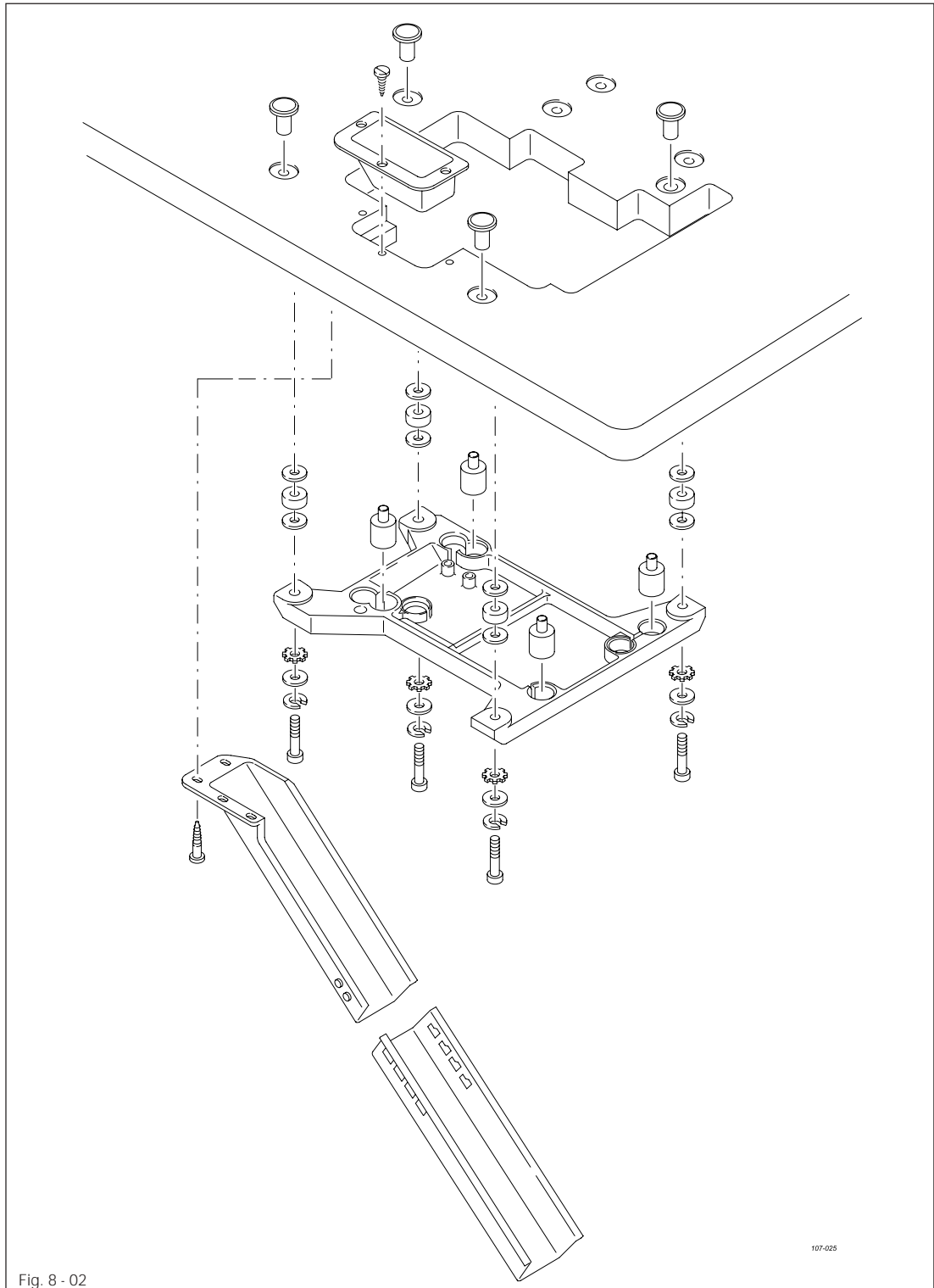

Fig. 8 - 02

107-025

- Drill holes in the table top as shown in the drawing.
- Mount the table top as shown in the above diagram.

## 8.01.08 Tightening the V-belt

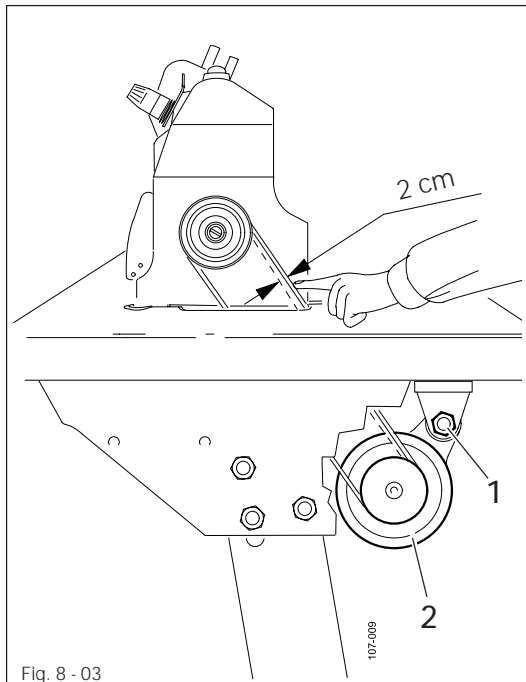

Fig. 8 - 03

- Loosen nut 1.
- By swinging the motor 2, tighten the V-belt accordingly.
- Tighten nut 1.



Fig. 8-03 shows a Quick-motor. When using a different motor, follow the instructions in the motor manual.

## 8.01.09 Fitting the top belt guard

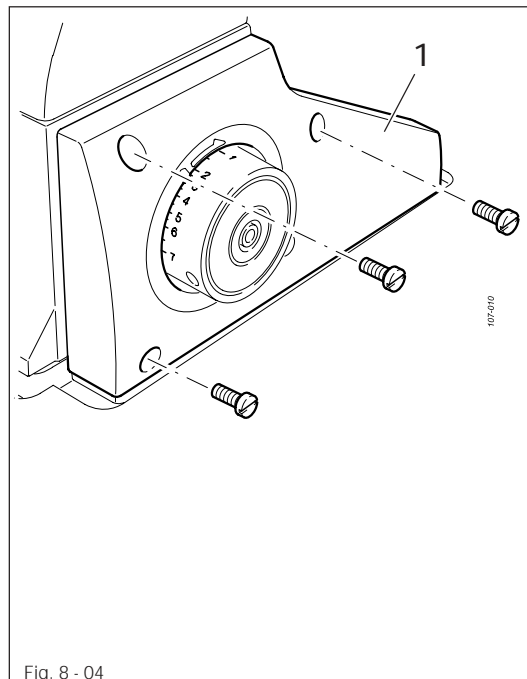
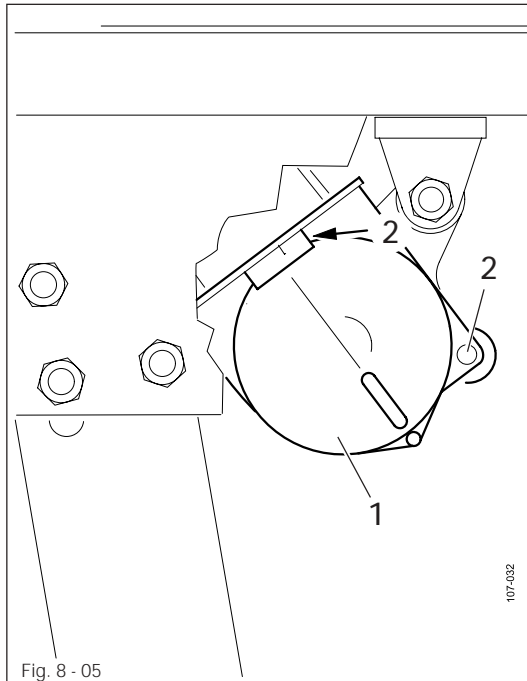

Fig. 8 - 04

- Attach belt guard 1 to the machine case with three screws.

# Mounting and commissioning the machine

## 8.01.10 Fitting the bottom belt guard.



- The belt guard 1 must be located to allow free movement of the motor pulley and the drive belt.
- Tighten screws 2.



Fig. 8-05 shows a Quick-motor. When using a different motor, follow the instructions in the motor manual.

## 8.01.11 Chain for securing the pedal

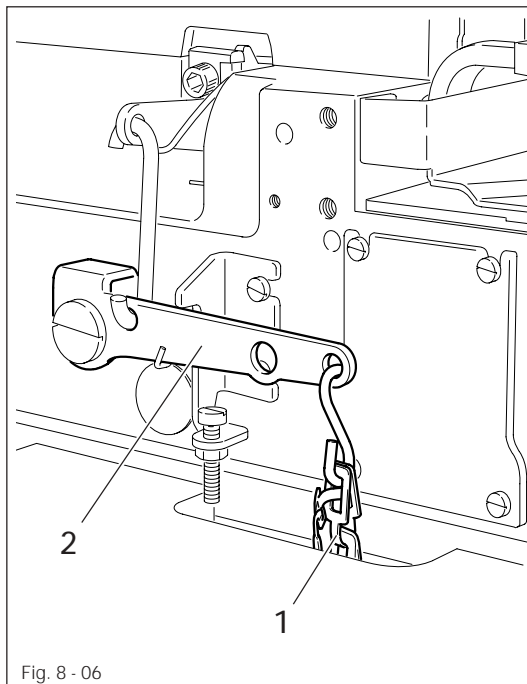

- Secure chain 1 for raising the sewing foot to lever 2 and to the right pedal.

## 8.01.12 Mounting the reel stand

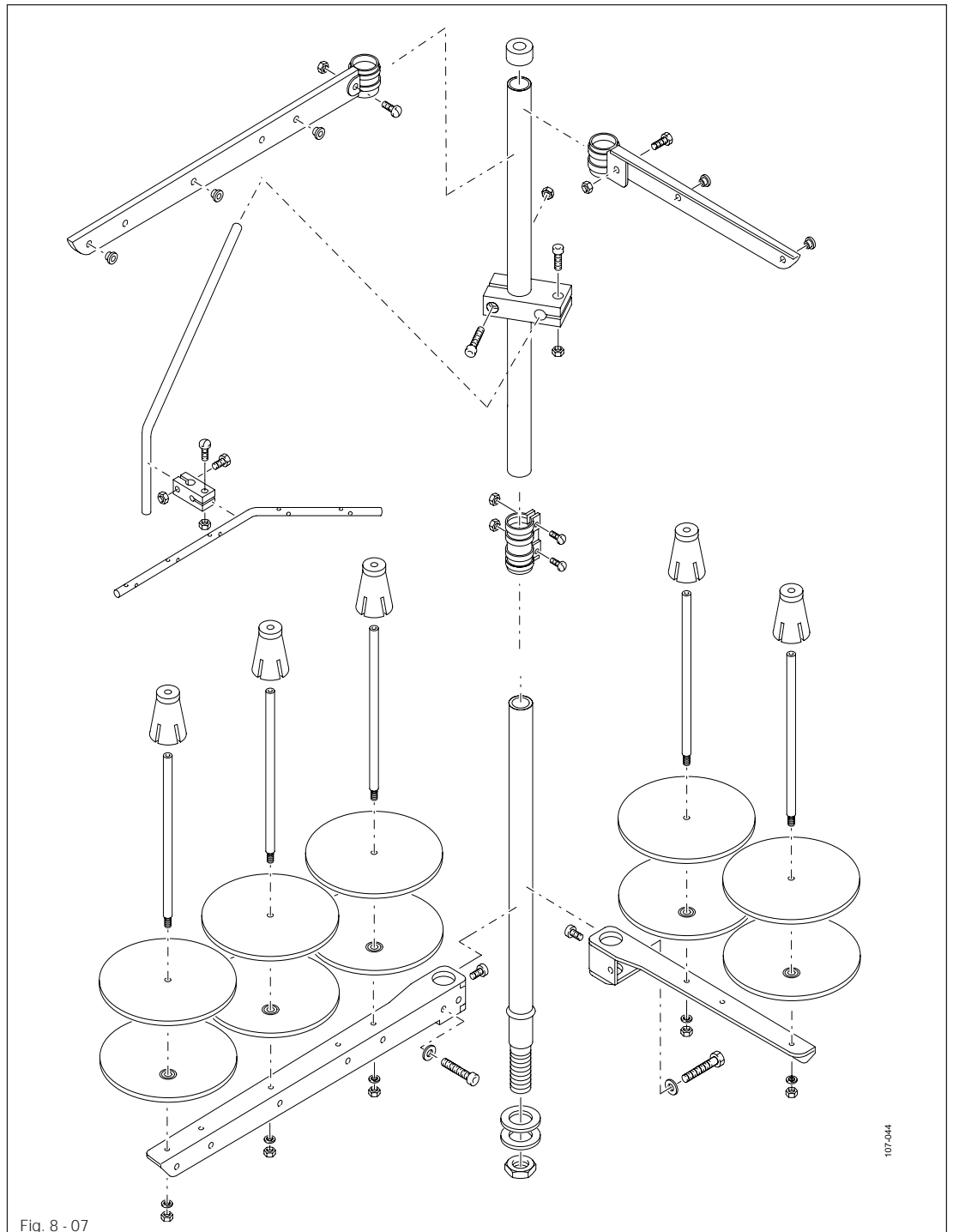

- Mount the reel stand as shown in **Fig. 8-07**.
- Afterwards insert the stand in the hole in the table top and attach it with the nuts provided.

## 8.02 Commissioning

- Check the machine, especially the electric wires, for any damage.
- Clean the machine thoroughly and then oil it, see **Chapter 10 Care and Maintenance**.
- Have specialists check, whether the machine's motor can be used with the existing mains voltage, and whether it is connected properly in the terminal box. If there are any discrepancies, do **not** operate the machine.
- When the machine is running, the balance wheel should turn away from the operator.

## 8.03 Switching the machine on/off

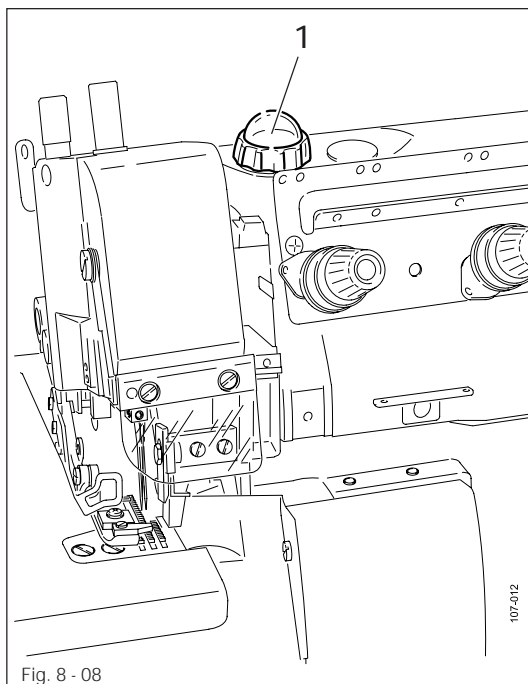

- Switch the machine on, see **Chapter 7.01 Main switch**.
- Carry out a test run, making sure that oil can be seen in inspection glass 1.

9 Preparation



All regulations and instructions in this Instruction Manual are to be observed!  
Special attention is to be paid to the safety regulations!



All preparation work is only to be carried out by appropriately trained personnel.  
Before all preparation work, the machine is to be separated from the electricity supply by removing the plug from the mains or switching off the On/Off switch!

9.01 Inserting the needle

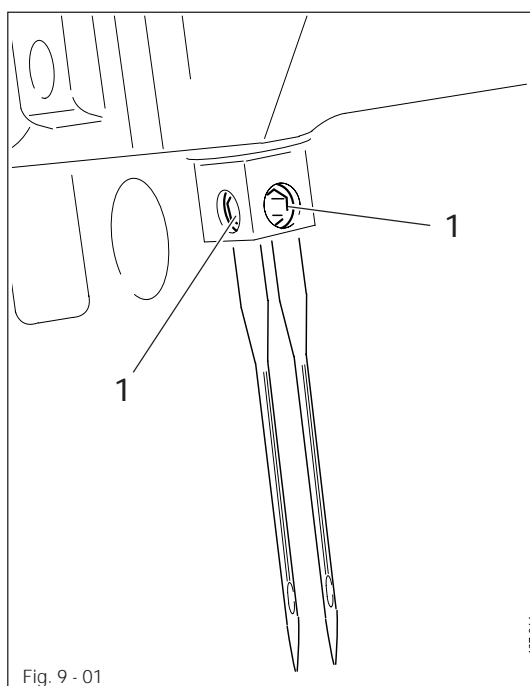

Switch off the machine!  
Danger of injury due to unintentional starting of the machine!



Only use needles from the system intended for the machine, see **Chapter 3 Specifications**.

- By turning the balance wheel, bring the needle bar to its t.d.c.
- Loosen screw 1.
- Insert the needle as far as possible.
- The long needle groove must be facing forwards.
- Tighten screw 1.

9.02 Threading the needle thread



Switch off the machine!  
Danger of injury if the machine starts accidentally!

- Thread the needle thread as shown in the corresponding diagram (see next page).
- Adjust the relevant needle thread tension by turning milled nuts 1.

9.02.01 Threading diagram for the PFAFF 5704

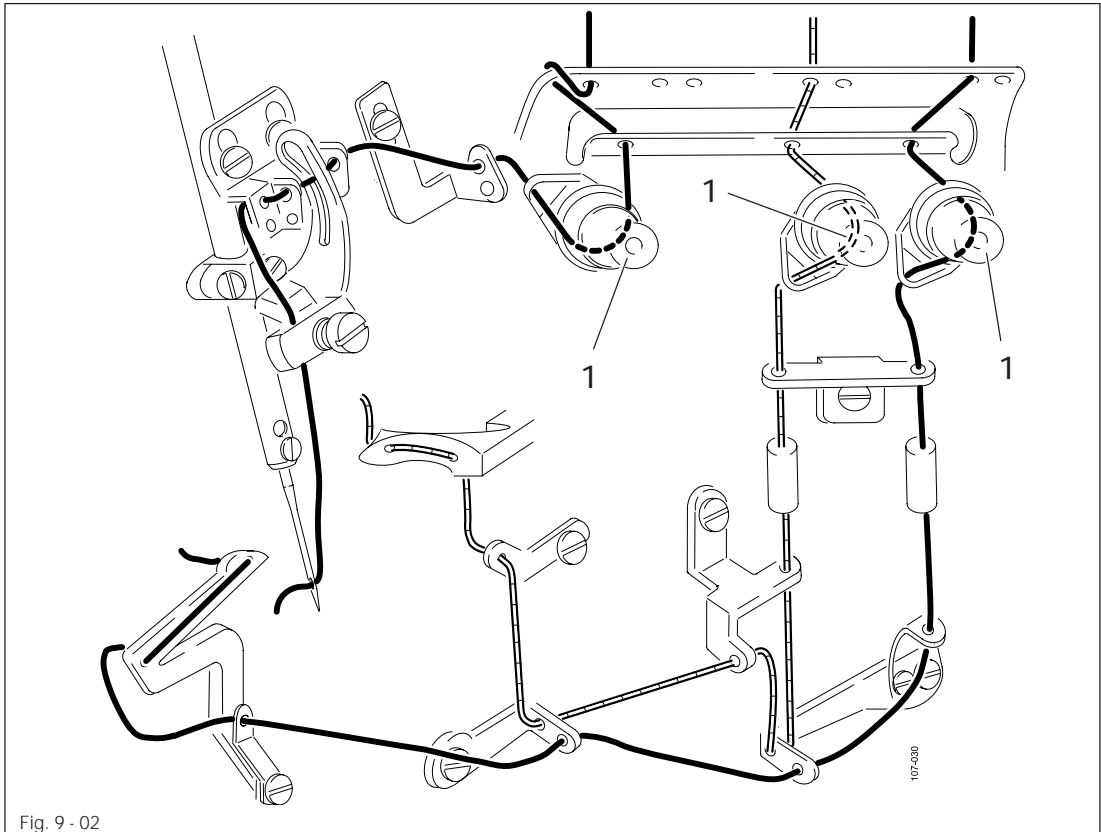

9.02.02 Threading diagram for the PFAFF 5714

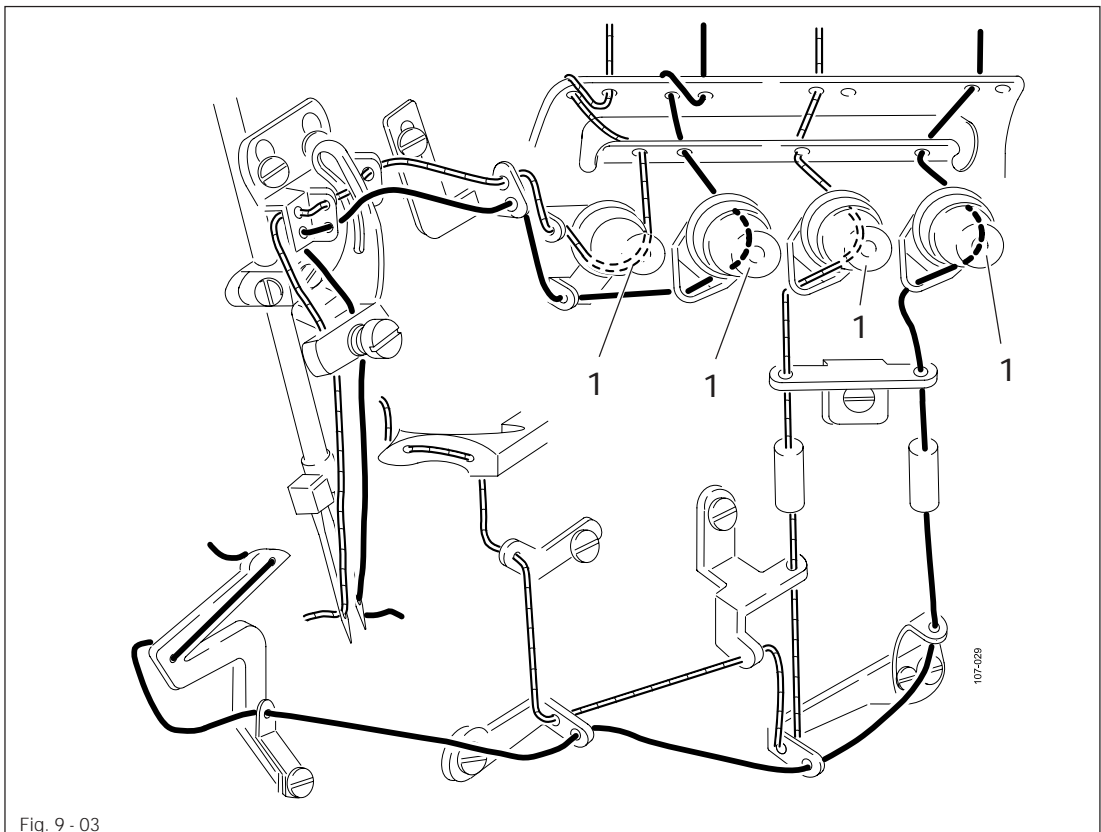



9.02.03 Threading diagram for the PFAFF 5716

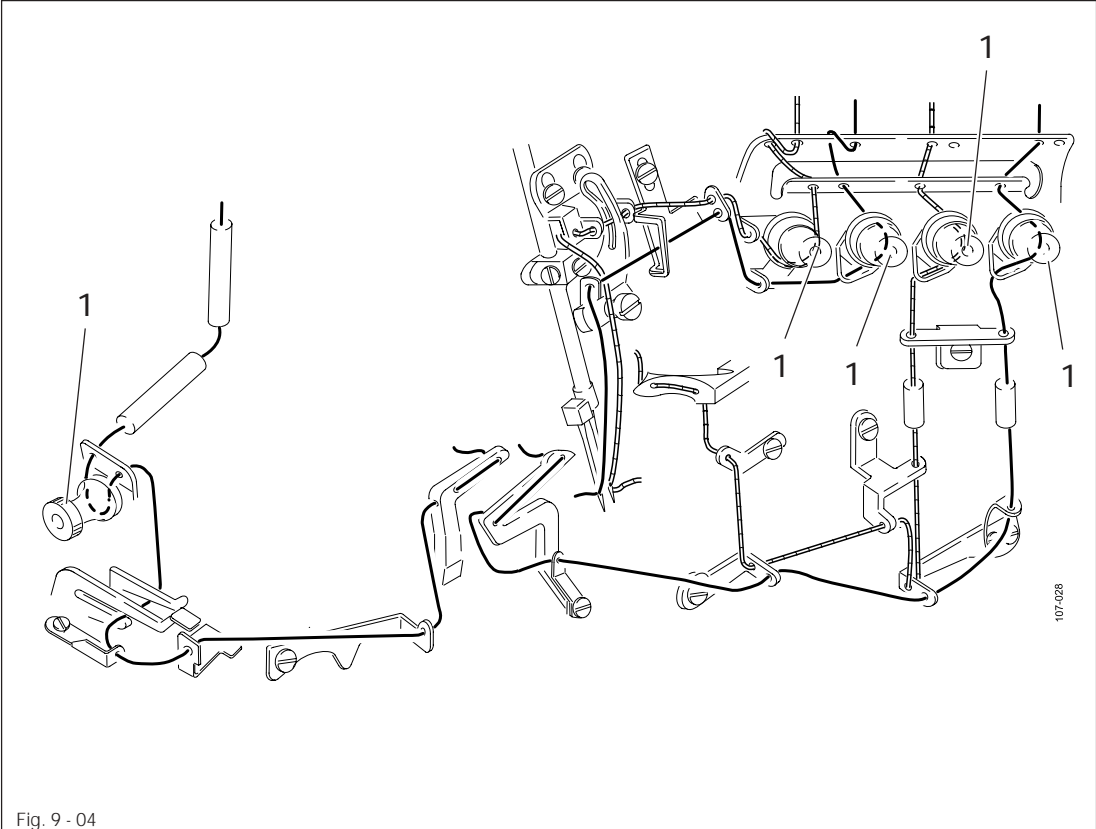

Fig. 9 - 04

9.02.04 Threading diagram for the PFAFF 5742

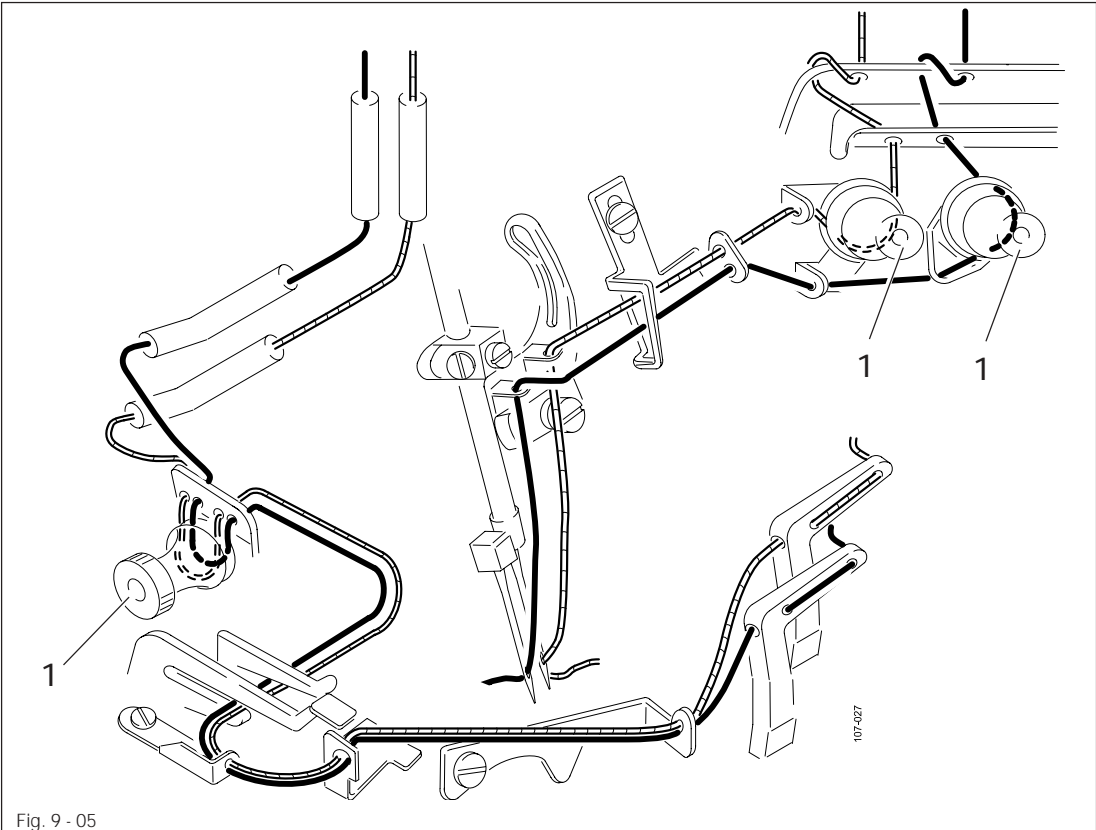
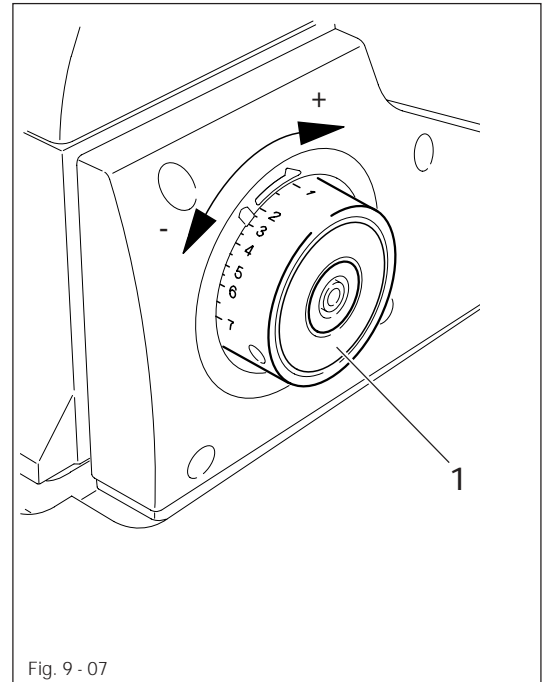
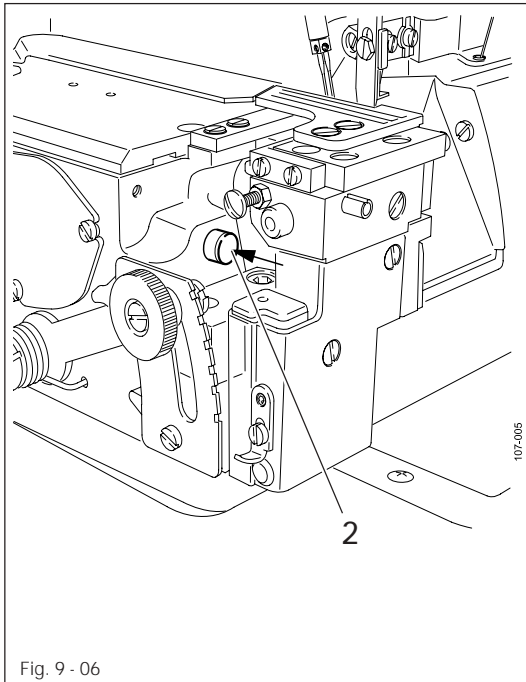

Fig. 9 - 05

## 9.03 Adjusting the stitch length



- Press down stop button 2 and set the required stitch length on balance wheel 1.

## 9.04 Adjusting the fullness

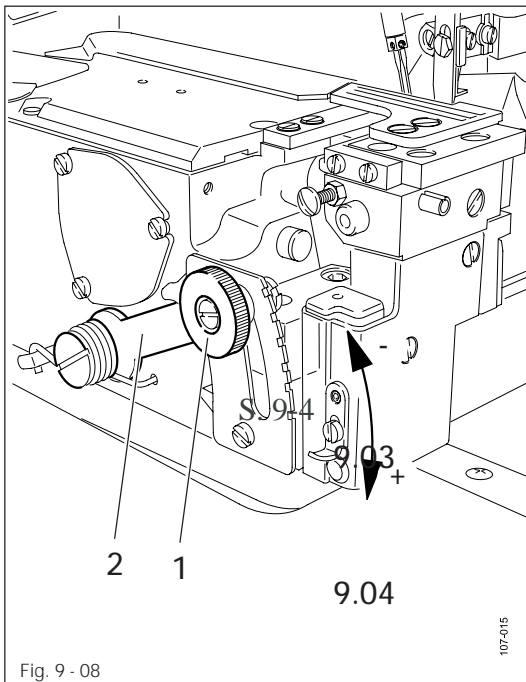

- Loosen screw 1.
- Adjust lever 2 according to the required fullness.
- Retighten screw 1.

Top setting = stretch  
 Bottom setting = gather

9.05 Adjusting the sewing foot pressure

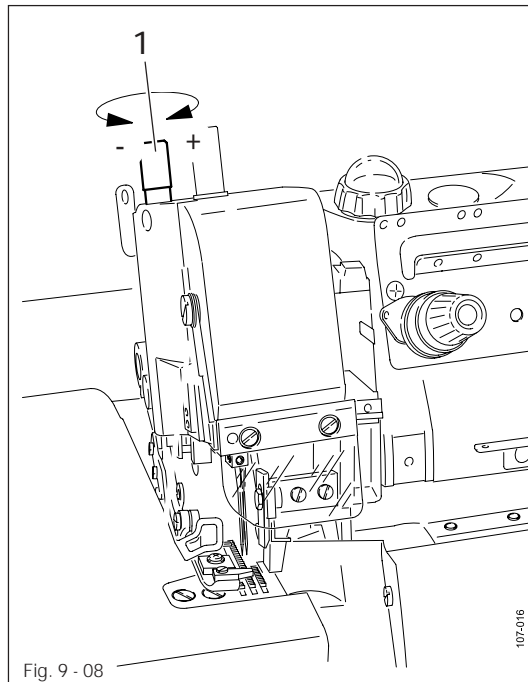

The sewing foot pressure must be set so that the workpiece is fed reliably.

- Set the appropriate sewing foot pressure with screw 1.

## 10 Care and maintenance

### 10.01 Maintenance intervals

Clean the machine .....	once a day, more often when in continuous operation
Clean the hook compartment .....	once a day, more often when in continuous operation
Check the oil level .....	daily
Change the oil .....	4 weeks after commissioning, then every six months
Oil the thread lubrication .....	as required
Oil the machine .....	during commissioning and after long downtimes
Change the knife .....	as required



These maintenance intervals are calculated for the average running time of a single shift operation. If the machine is operated more than this, shorter intervals are recommended.

### 10.02 Cleaning the machine

The cleaning cycle required for the machine depends on following factors:

- Single or several shift operation
- Amount of dust resulting from the workpiece

It is therefore only possible to stipulate the best possible cleaning instructions for each individual case.



For all cleaning work the machine must be disconnected from the mains by switching off the on/off switch or by disconnecting the mains plug!  
Danger of injury if the machine starts accidentally!



To avoid breakdowns, the following cleaning work is recommended for single shift operation:

- Clean hook compartment and needle area several times a day.
- Clean the entire machine at least once a day.

## 10.03 Cleaning the hook compartment

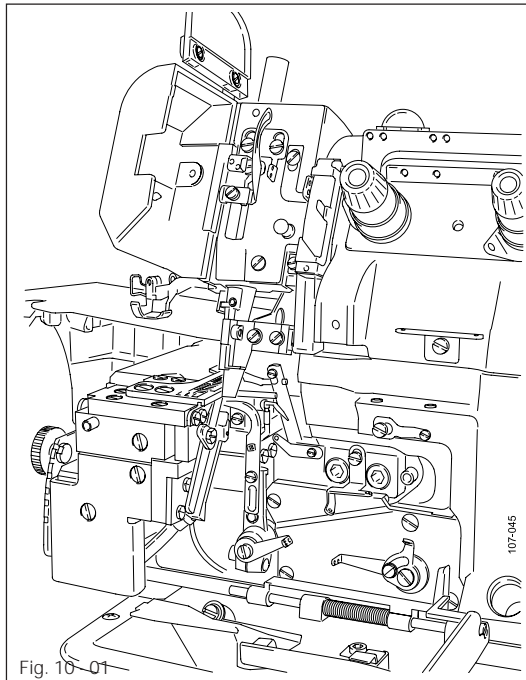

Switch off the machine!  
Danger of injury if the machine is started accidentally!

- Open the hook compartment cover.
- Clean the hook compartment.
- Close the cover.

## 10.04 Checking the oil level

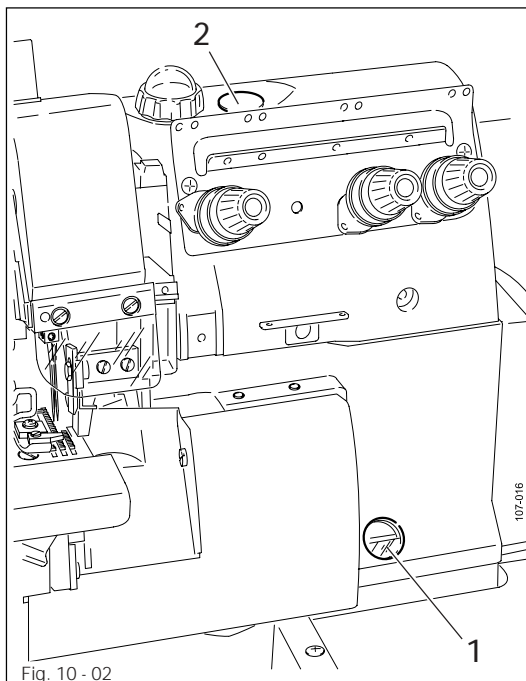

- When the machine is at a standstill, check whether the oil level in inspection glass 1 is between both markings.
- If necessary, remove plug 2 and pour in oil to the top marking.
- Replace plug 2.



Only use oil with a mean viscosity of 22.0 mm<sup>2</sup>/s at 40°C and a density of 0.865 g/cm<sup>3</sup> at 15°C.

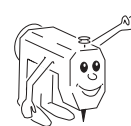

We recommend PFAFF sewing machine oil, part no. 280-1-120 144.

## 10.05 Changing the oil

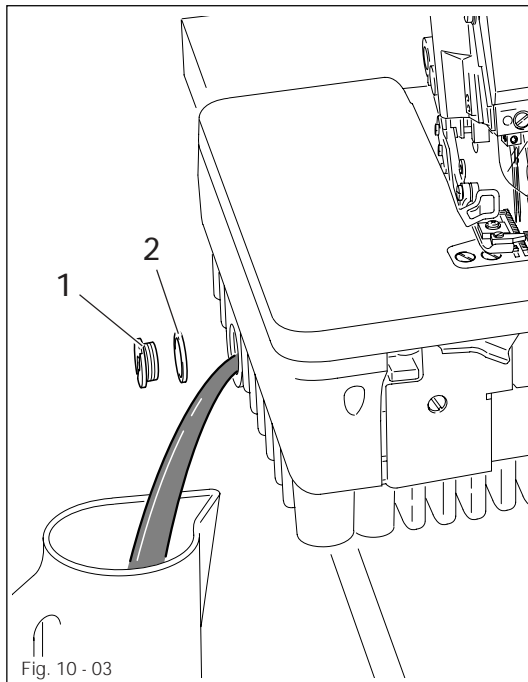

Fig. 10 - 03

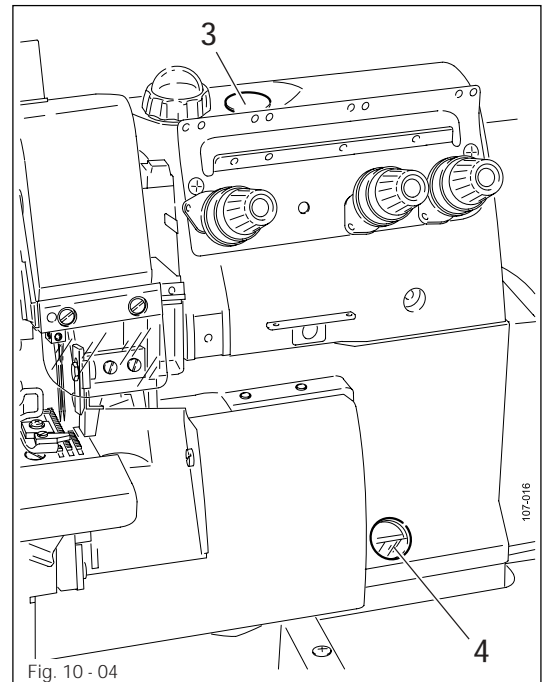

Fig. 10 - 04



Switch off the machine!  
Danger of injury if the machine starts accidentally!



The oil must not get into the sewer system! Danger of damage to the environment!

- Place a suitable vessel in position and remove screw 1.
- Let the oil drain off completely.
- Retighten screw 1 with a new sealing ring 2.
- Remove inspection glass 3 and pour in fresh oil up to the top marking of inspection glass 4.
- Screw inspection glass 3 back into place.
- Carry out a test run and check whether the oil in inspection glass 3 is visible.



Only use oil with a mean viscosity of 22.0 mm<sup>2</sup>/s at 40°C and a density of 0.865 g/cm<sup>3</sup> at 15°C.

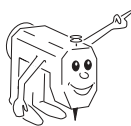

We recommend  
PFAFF sewing machine oil, part no. 280-1-120 144.

10.06 Oiling the thread lubrication

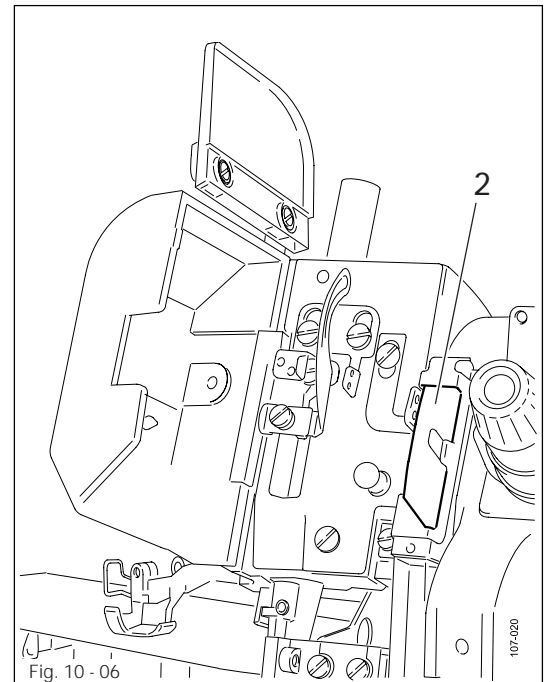
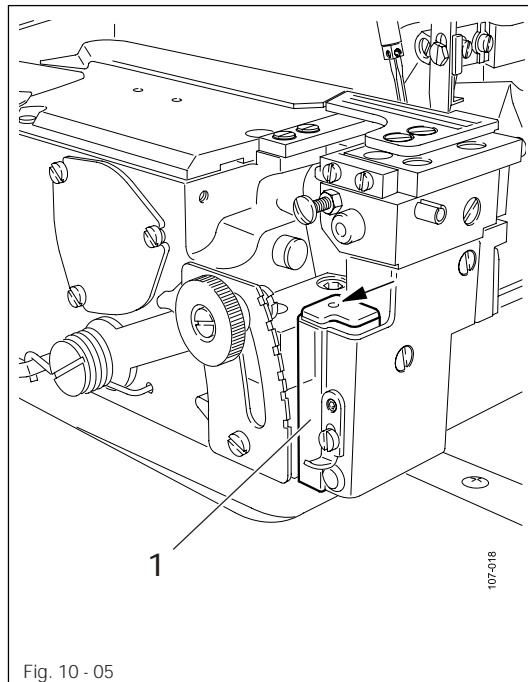

Switch off the machine!  
Danger of injury if the machine starts accidentally!

- There must always be oil in oil tank 1 and felt pad 2.
- When required, fill oil into oil tank 1 or soak felt pad 2 with oil.

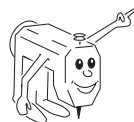

We recommend PFAFF thread lubricating oil, part no. 280-1-120 217.

### 10.07 Oiling the machine

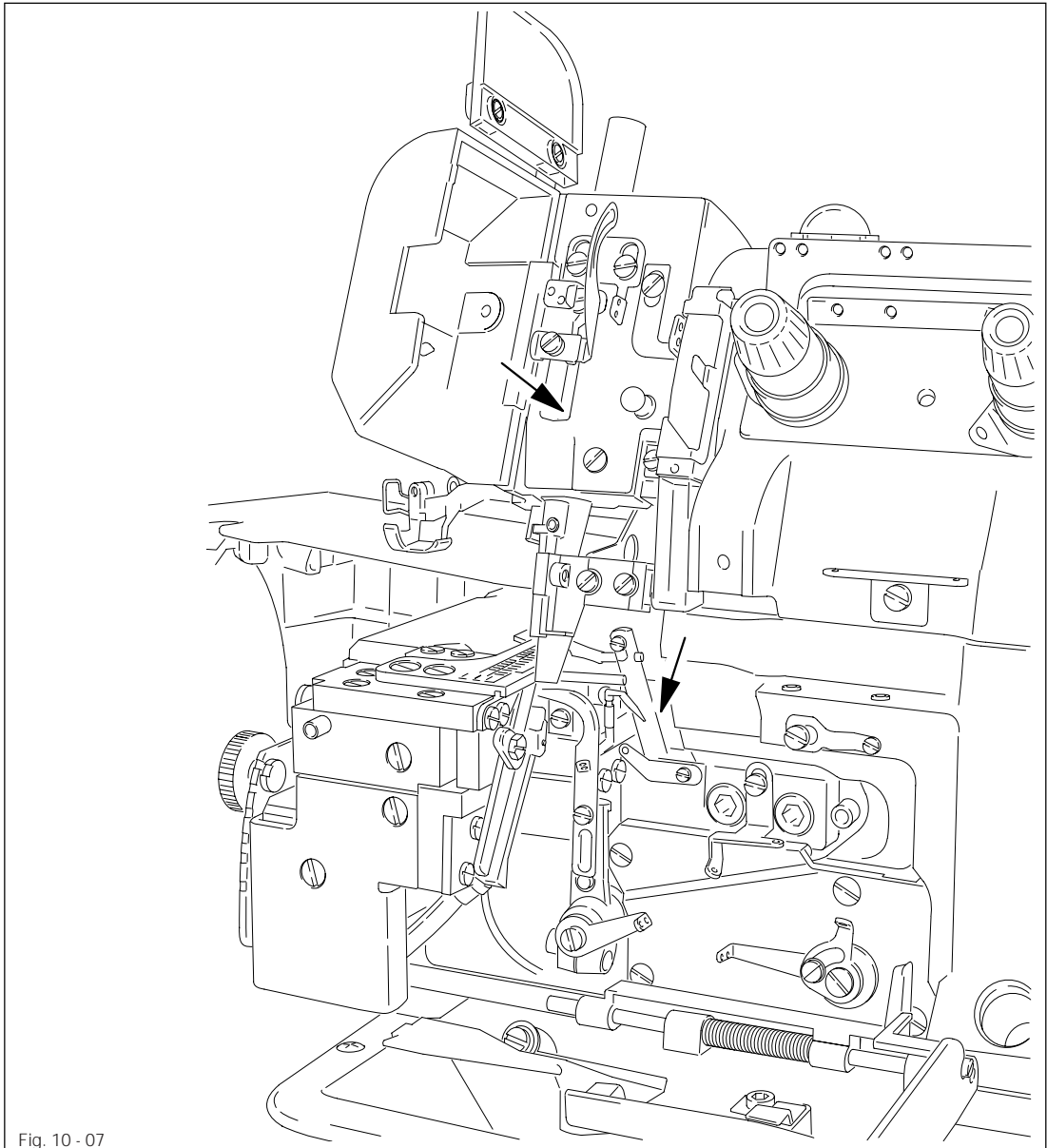

Switch off the machine!  
Danger of injury if the machine starts accidentally!

- Before commissioning and before operation after long downtimes, a few extra drops of oil should be applied to the needle bar and hook bar (see arrow).



Only use oil with a mean viscosity of 22.0 mm<sup>2</sup>/s at 40°C and a density of 0.865 g/cm<sup>3</sup> at 15°C.

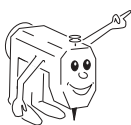

We recommend  
PFAFF sewing machine oil, part no. 280-1-120 144.



10.08 Changing the knife

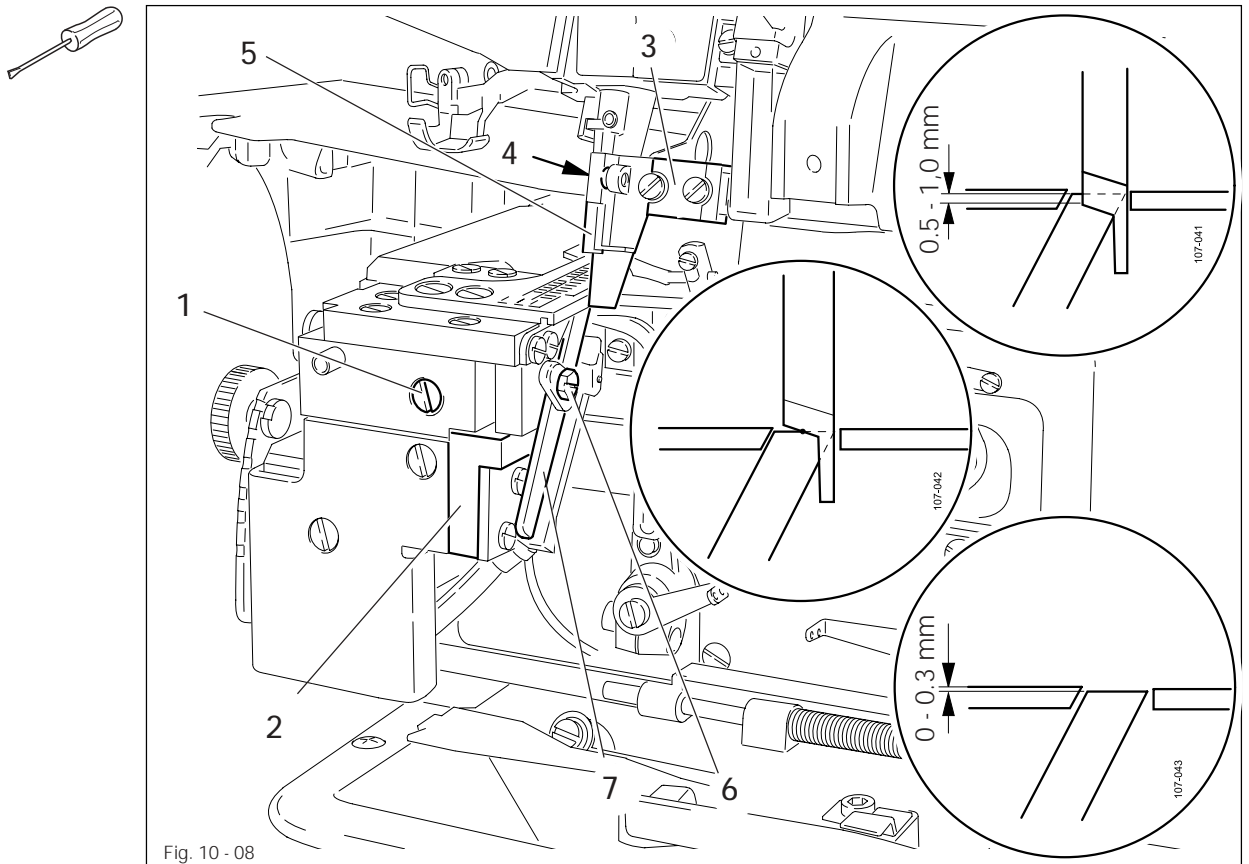

Fig. 10 - 08



Switch off the machine!  
 Danger of injury if the machine starts accidentally!

Preparation

- Loosen screw 1, move knife holder 2 as far as possible to the left and slightly tighten screw 1.

Changing the top knife

- Using the balance wheel, position knife holder 3 at t.d.c., unscrew screw 4 and remove knife 5.
- Insert a new knife and slightly tighten screw 4.

Changing the bottom knife

- Unscrew screw 6 and remove knife 7.
- Insert new knife and slightly tighten screw 6.

Adjustment

The knives 5 and 7 should be positioned so that

- the blade of the top knife 5 and of the bottom knife 6 overlap by 0.5 – 1.0 mm.
- the bottom knife 7 is 0.0 -0.3 mm below the needle plate and
- the knives 5 and 7 cross each other at their central points.
- Position knives 5 and 7 accordingly and tighten screws 4 and 6.
- Adjust the cutting pressure with knife holder 2 and tighten screw 1.

## 11 Adjustment



Please observe all notes from **Chapter 1 Safety** of the instruction manual! In particular care must be taken to see that all protective devices are refitted properly after adjustment, see **Chapter 1.06 Danger warnings** of the instruction manual!

The machine must be disconnected from the electrical power supply.

### 11.01 Notes on adjustment

All adjustments may only be carried out by qualified personnel. Machine covers, which are removed for control and adjustment work, must be replaced before the renewed operation of the machine.

### 11.02 Tools, gauges and other accessories

- 1 set of screwdrivers with blade widths from 2 to 10 mm
- 1 set of spanners with jaw widths from 7 to 14 mm
- 1 set of Allen keys from 1.5 to 6 mm
- 1 metal ruler, part no. 08-880 218-00

### 11.03 Settings on the PFAFF 5704

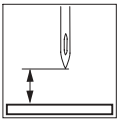
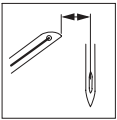
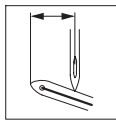
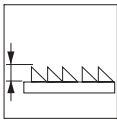
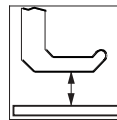
Subclass	 Needle bar height [mm]	 Lower looper to needle clearance [mm]	 Upper looper to needle clearance [mm]	 Height of bottom feed dog [mm]	 Fabric clearance [mm]	
5704-01	10,1	4,2	5,1	0,9 - 1,1	5,5	
5704-16S2	10,1	4,2	5,1	0,5 - 3,8	5,5	
5704-17A	10,1	4,2	5,1	0,5 - 3,8	5,5	
5704-180	10,1	4,2	5,1	0,5 - 3,8	3,5	

11.04 Settings on the PFAFF 5714

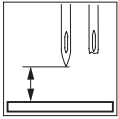
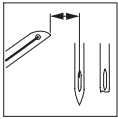
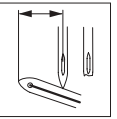
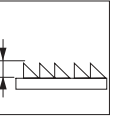
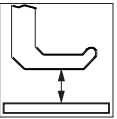
Subclass	 Needle bar height [mm]	 Lower looper to needle clearance [mm]	 Upper looper to needle clearance [mm]	 Height of bottom feed dog [mm]	 Fabric clearance [mm]	
5714-...	10,4	4,2	5,8	0,9 - 1,1	5,5	

11.05 Settings on the PFAFF 5716

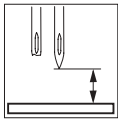
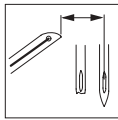
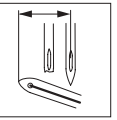
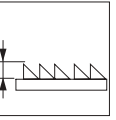
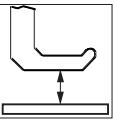
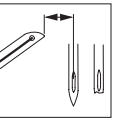
Subclass	 Needle bar height [mm]	 Lower looper to needle clearance [mm]	 Upper looper to needle clearance [mm]	 Height of bottom feed dog [mm]	 Fabric clearance [mm]	 Chainstitch looper to needle clearance [mm]
5716-38A	10,6	3,9	5,1	0,9 - 1,1	5,5	1,5
5716-70A	12,0	3,4	5,1	0,9 - 1,1	5,5	1,5
5716-86A	10,6	3,9	5,1	0,9 - 1,1	5,5	1,5

11.06 Settings on the PFAFF 5742

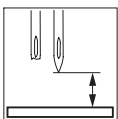
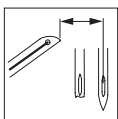
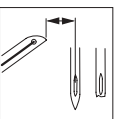
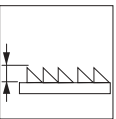
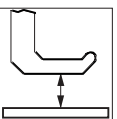
Subclass	 Needle bar height [mm]	 Chainstitch looper to right needle clearance [mm]	 Chainstitch looper to left needle clearance [mm]	 Height of bottom feed dog [mm]	 Fabric clearance [mm]	
5742-02-250	8,7	1,7	1,7	0,9 - 1,1	3,5	

This is a list of the most important wearing parts.

A detailed parts list for the complete machine is included with the accessories.

In case of loss the parts list can be downloaded from the internet address

[WWW.pfaff-industrial.com/de/service/download/index.php3](http://WWW.pfaff-industrial.com/de/service/download/index.php3). As an alternative to the internet download the parts lists can also be ordered in book form

under part no. 296-12-18 606.

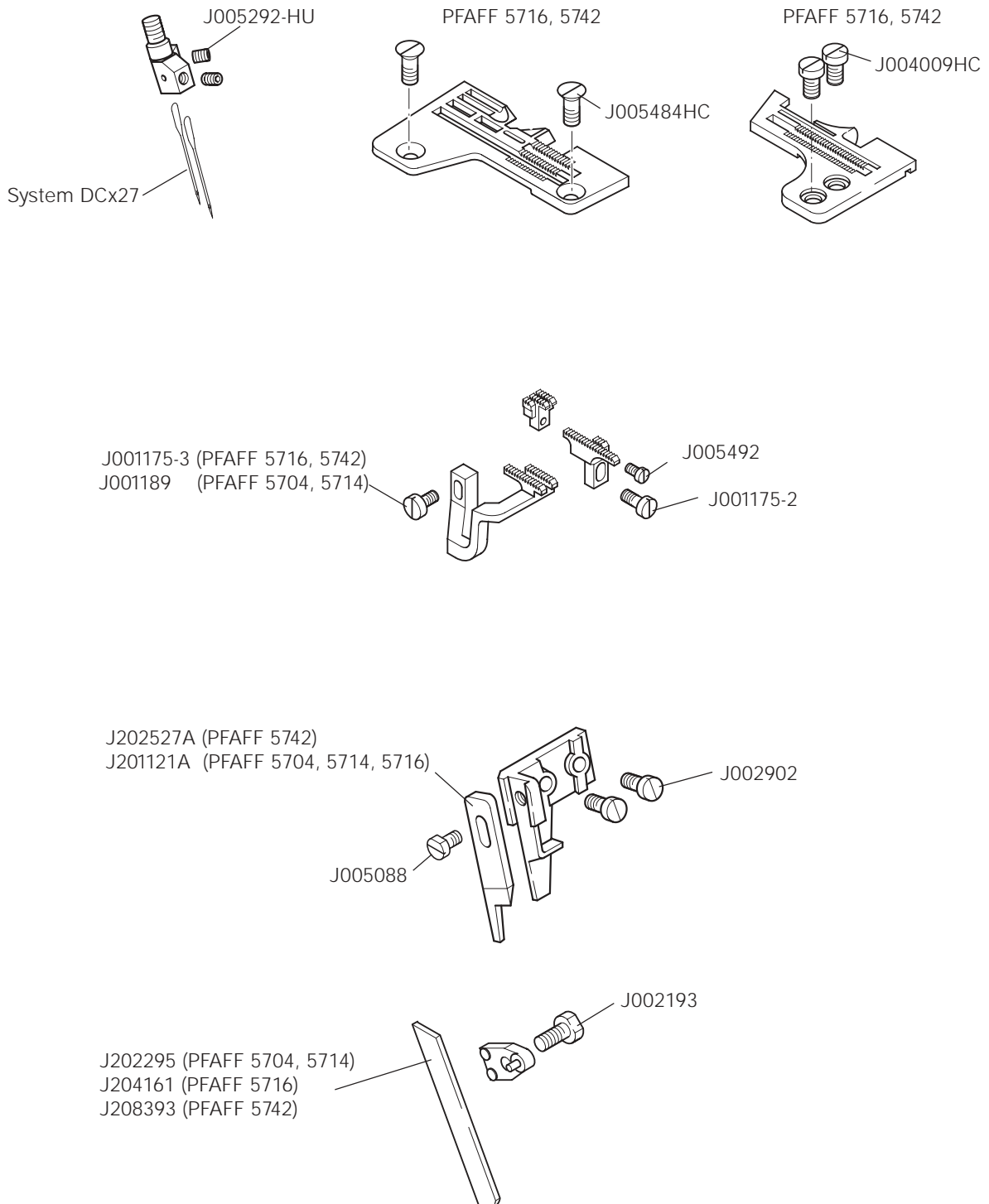

J204062 (PFAFF 5704-01, -16S2, -17, -180)  
J204949 (PFAFF 5714-13)  
J209733 (PFAFF 5714-181)  
J204702 (PFAFF 5716-38A, -70A)  
J204703 (PFAFF 5716-86A)

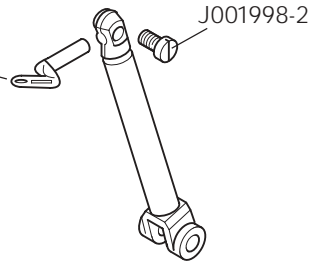

J204072 (PFAFF 5704, 5714, 5716)

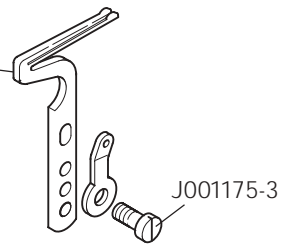

J209685 (PFAFF 5716-38A, -70A, PFAFF 5742)  
J2096851-HC (PFAFF 5716-86A)

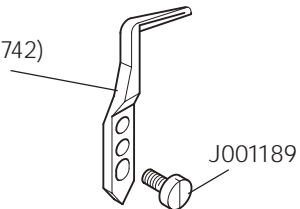

J209729 (PFAFF 5742)

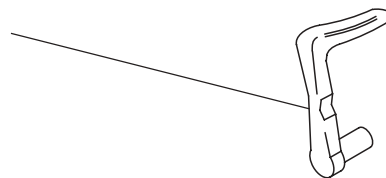

# PFAFF

## PFAFF Industrie Maschinen AG

Postfach 3020  
D-67653 Kaiserslautern

Königstr. 154  
D-67655 Kaiserslautern

Telefon: (0631) 200-0  
Telefax: (0631) 17202  
E-Mail: [info@pfaff-industrial.com](mailto:info@pfaff-industrial.com)