

**SINGER**  
**281-30**

# SINGER

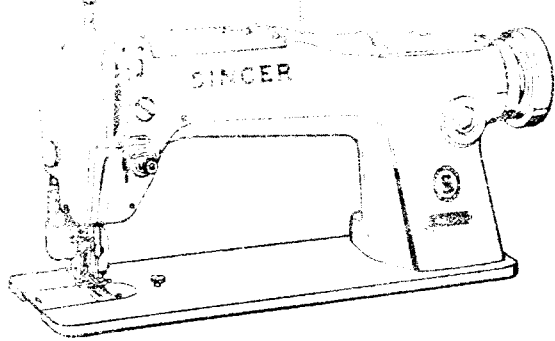

## TEMPORARY PARTS LIST 281-30 ~~281-20~~ BASIC MACHINE PARTS

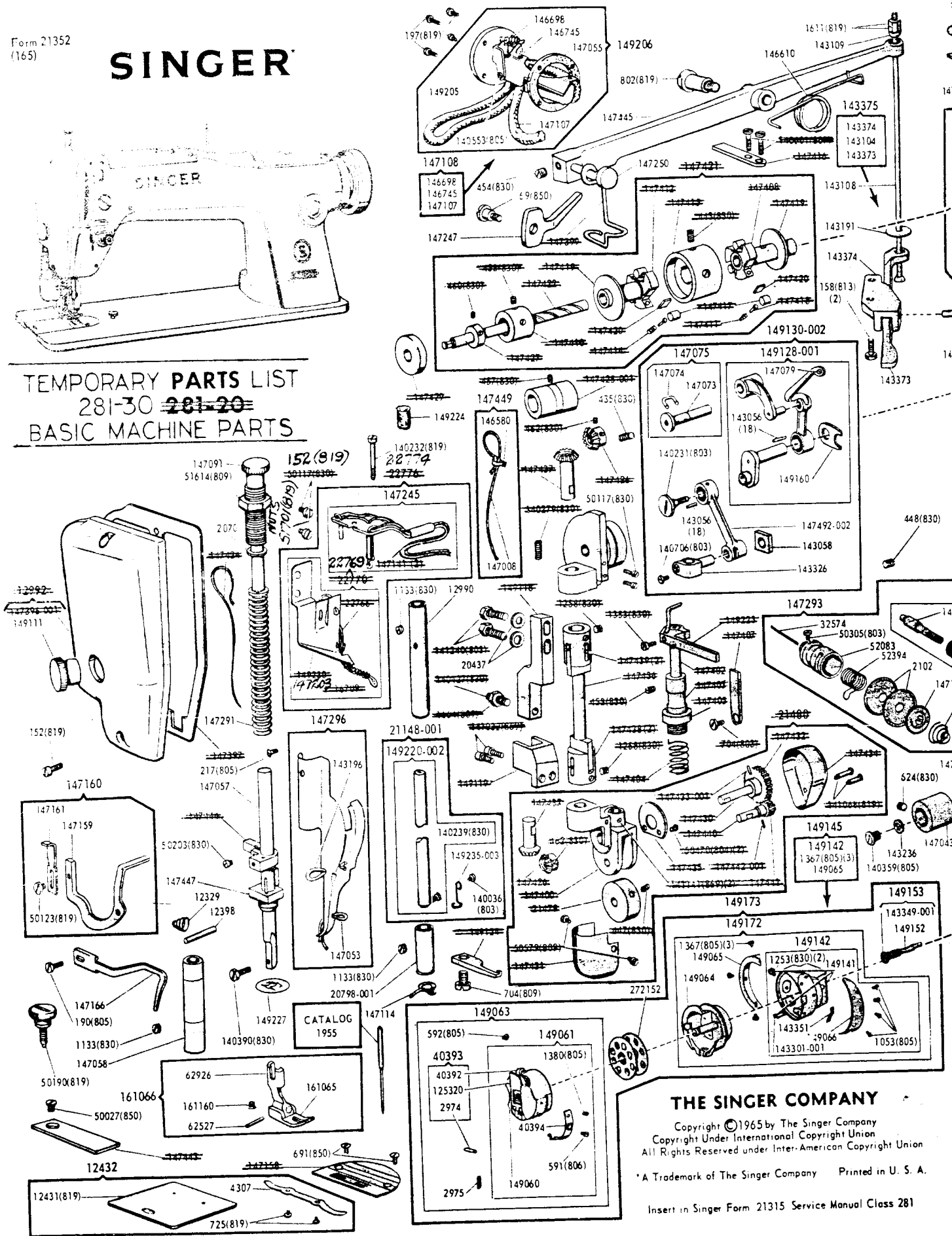

**THE SINGER COMPANY**  
Copyright ©1965 by The Singer Company  
Copyright Under International Copyright Union  
All Rights Reserved under Inter-American Copyright Union  
A Trademark of The Singer Company Printed in U. S. A.  
Insert in Singer Form 21315 Service Manual Class 281

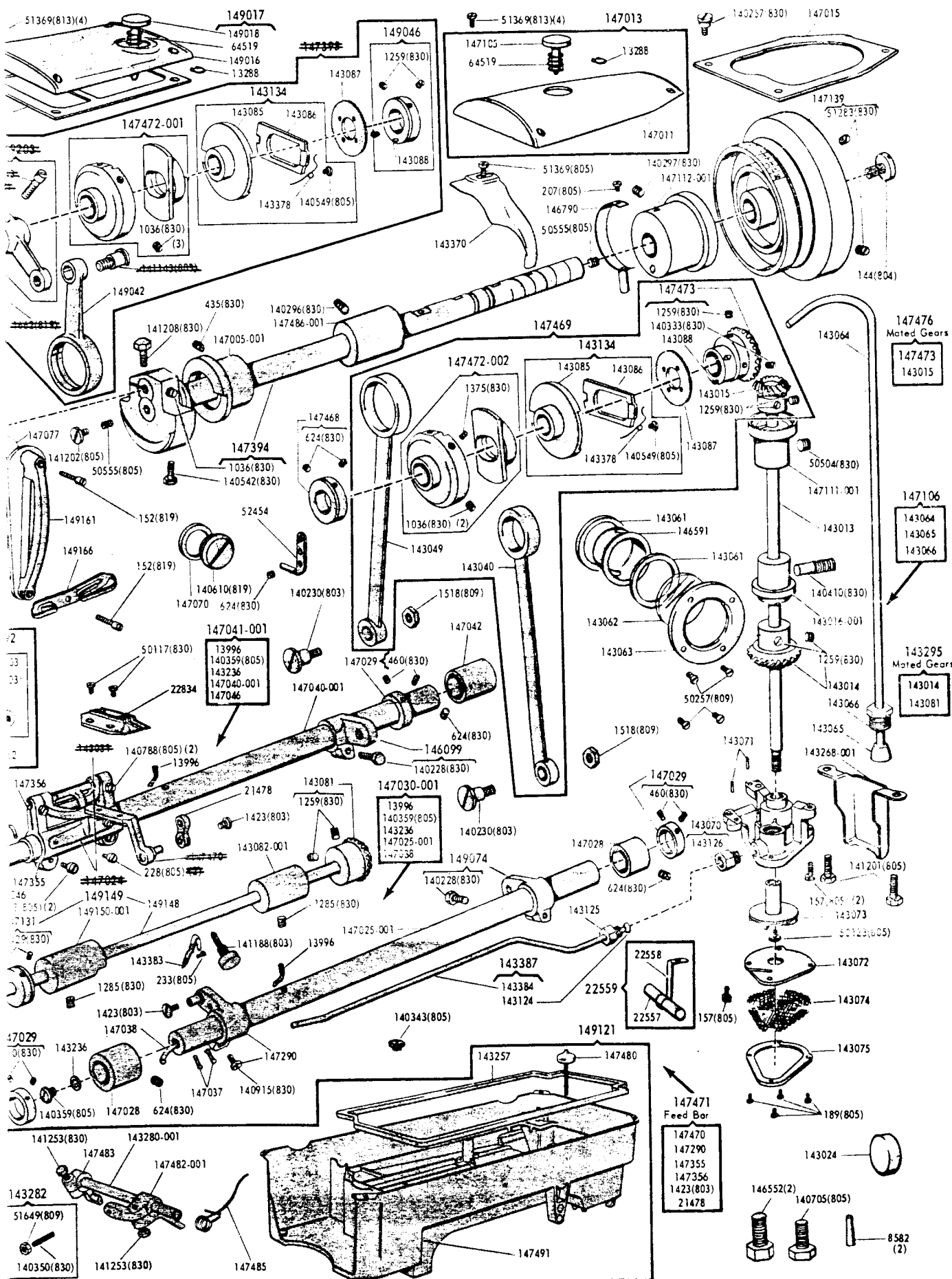

281-30  
NUMERICAL LIST OF PARTS FOR ~~281-30~~ MACHINE

NUMBER	DESCRIPTION	NUMBER	DESCRIPTION	NUMBER	DESCRIPTION	NUMBER	DESCRIPTION
69(850)	Presser Bar Lifter Hinge Screw	624(830)	Arm Shaft (horizontal) Thrust Collar Set Screw(2)	12329	Tension Releasing Lever Spring	50117(8)	
144(804)	Arm Shaft (horizontal) Screw (back)	691(850)	Throat Plate Screw(2)	12398	Tension Releasing Lever Hinge Pin	50123(8)	
152(819)	Thread Take-up Lever Guard and Thread Eyelet and Thread Guard Screw (front of arm)	704(809)	Rotating Hook Bobbin Case Holder Position Bracket Screw	12431(819)	Bed Slide	50123(8)	
152(819)	Face Plate Screw(2)	<del>704(809)</del>	Feed Roll Bracket Shaft Guide Bracket Holder Screw	12432	Bed Slide complete, Nos. 4367, 12431(819) and two 725-819)	50190(8)	
152(819)	Thread Take-up Lever Guard Screw	725(819)	Bed Slide Spring Screw(2)	12990	Needle Bar Bushing (upper)	50203(8)	
157(805)	Oil Pump (centrifugal) Body Screw(2)	802(819)	Presser Bar and Feed Roll Lifting Lever Hinge Screw	<del>12990</del>	Face Plate 147296-001 with 149111	50257(8)	
157(805)	Magnet Retaining Clamp and Oil Pump (centrifugal) Body Screw	1036(830)	Thread Take-up Crank Set Screw	12997	Feed Roll (rubber covered) with 447(830)	50305(8)	
158(813)	Bell Crank Bracket Screw(2)	1036(830)	Feed Eccentric Body Set Screw(2)	13288	Note: No. 12997 is furnished on order only	50429(8)	
158(805)	Feed Bar Carrier Clamping Screw(2)	1036(830)	Feed Roll Eccentric Set Screw(3)	13288	Arm Top Cover (front) Stitch Regulator Plunger Spring Stop Ring	50504(8)	
189(805)	Oil Pump (centrifugal) Screen Frame Screw(4)	1053(805)	Rotating Hook Thread Guard Screw(4)	13288	Arm Top Cover (back) Stitch Regulator Plunger Stop Ring	50555(8)	
190(805)	Slack Thread Regulator Screw	1133(830)	Needle Bar Bushing (upper) Set Screw	13300	Presser Bar (adjustable) complete, Nos. 14392, 14393 and 14119(869)	50555(8)	
197(819)	Oil Removing Wick (head end) Hinge Plate and Cover Screw(4)	1133(805)	Presser Bar Bushing (lower) Set Screw	13996	Note: No. 13300 is furnished on order only	51265(8)	
207(805)	Arm Shaft (horizontal) Flanged Bushing (back) Oil Sump Tube Holder Screw	1133(830)	Needle Bar Bushing (lower) Set Screw	13996	Feed Lifting Rock Shaft Oil Wick	51369(8)	
217(805)	Thread Take-up Lever Oil Guard Screw	1253(830)	Rotating Hook Set Screw(2)	14392	Feed Rock Shaft Oil Wick	51369(8)	
228(805)	Feed Bar Carrier Oil Wick Holder Screw(2)	<del>1336(830)</del>	Feed Roll Driving Shaft (upright) Driving Collar Set Screw(4)	14392	Presser Bar	51369(8)	
233(805)	Rotating Hook Oil Flow Regulating Thumb Screw Spring Screw	1259(830)	Arm Shaft (upright) Bevel Gear (lower) Set Screw(2)	14393	Note: No. 14392 is furnished on order only	51649(8)	
435(830)	Thread Take-up Link Hinge Stud Set Screw	1259(830)	Arm Shaft (upright) Bevel Gear (upper) Set Screw(2)	14393	Presser Foot Seat	51649(8)	
435(830)	Arm Shaft (horizontal) Flanged Bushing (front) Set Screw	1259(830)	Feed Roll Feed Regulator Locking Slide Ratchet Wheel Retaining Collar Set Screw(2)	16709	Note: No. 14393 furnished on order only	51649(8)	
<del>443(830)</del>	Feed Roll Clutch Body Set Screw(2)	1259(830)	Feed Lifting Eccentric Set Screw	20437	Arm Side Shield Wick Spring Holder	52083(8)	
<del>447(830)</del>	Feed Roll Set Screw	1259(830)	Rotating Hook Shaft Bevel Gear Set Screw(2)	20798-001	Feed Roll Guide Bar Screw Washer(2)	52083(8)	
448(830)	Thread Take-up Spring Regulator Set Screw	1285(830)	Rotating Hook Shaft Bushing (back) Set Screw	21148-001	Needle Bar Bushing (lower)	52394(8)	
<del>453(830)</del>	Feed Roll Bracket Shaft Bushing Set Screw	1285(830)	Rotating Hook Shaft Bushing (front) Set Screw	21148-001	Needle Bar (hollow) complete, Nos. 140036(803), 149220-002 and 149235-003	52454(8)	
453(830)	Feed Roll Clutch (bracket) Bushing Set Screw(2)	<del>1336(830)</del>	Feed Roll Bracket Shaft Guide Bracket Clamping Screw	21478	Feed Bar Connecting Link	62527(8)	
454(830)	Presser Bar and Feed Roll Lifting Lever Pin Set Screw	1367(805)	Rotating Hook Section Screw(3)	<del>21478</del>	Feed Roll (25 Pitch Diamond Knurl) with 447(830)	62926(8)	
<del>454(830)</del>	Feed Roll Clutch Shaft Arm Bushing (rear) Set Screw	1375(830)	Feed Eccentric Body Position Screw	21478	Note: No. 21479 is furnished as regular to machine	64519(8)	
460(830)	Feed Roll Clutch Shaft Collar Set Screw(2)	1380(805)	Rotating Hook Bobbin Case Tension Spring Screw	21478	Feed Roll Bracket complete, Nos. 21479, 147400, 147426, 147430, 147431, 147432, 147433-001, 147434, 147435, 147437, 147440, 147441, 147442-001 and two each 50470(804) 50579(209) and 141068(819)	64519(8)	
460(830)	Feed Rock Shaft Collar Set Screw(2)	1423(803)	Feed Bar Connecting Link Cap Screw(2)	22557	Magnet (for removing iron particles from oil)	125320(8)	
<del>460(830)</del>	Feed Lifting Rock Shaft Collar Set Screw(4)	1518(809)	Feed Lifting Rock Shaft Connecting Rod Hinge Screw Nut	22557	Magnet Retaining Clamp	140036(8)	
<del>460(830)</del>	Feed Roll Driving Shaft (horizontal) Bevel Gear Set Screw(2)	1518(809)	Feed Rock Shaft Connecting Rod Hinge Screw Nut	22558	Magnet Retaining Clamp	14023(8)	
462(830)	Feed Roll Clutch Shaft Bevel Gear Set Screw(2)	1560(803)	Tension Regulating Thumb Nut	22559	Magnet Retaining Clamp 22558 with 22557	14023(8)	
591(806)	Rotating Hook Bobbin Case Tension Regulating Screw	1560(803)	Tension Regulating Thumb Nut Lock Nut	22766	Arm Side Shield Wick (16 in. long)	14023(8)	
592(805)	Rotating Hook Bobbin Case Latch Stop Screw	1611(819)	Presser Bar and Feed Roll Lifting Lever Connecting Rod Nut	<del>22766</del>	Arm Side Shield complete, Nos. 16709, 22766 and 149230	14025(8)	
624(830)	Thread Retainer Set Screw	1611(819)	Presser Bar and Feed Roll Lifting Lever Connecting Rod Nut Lock Nut	22834	Arm Side Shield and Oil Wick Holder, Nos. 22770 and 147245	14025(8)	
624(830)	Feed Rock Shaft Bushing (back) Set Screw	<del>1663(819)</del>	Feed Roll Eccentric Connecting Rod Hinge Screw Nut	22834	Feed Dog (20 teeth to the inch), for use with 147158 and 161066	14025(8)	
624(830)	Feed Lifting Rock Shaft Bushing (back) Set Screw	<del>1663(819)</del>	Feed Roll Guide Bar Adjusting Screw Nut	22837	Feed Roll (32 rows of spiked teeth, 4 teeth to a row) with 447(830)	14025(8)	
624(830)	Feed Rock Shaft Bushing (front) Set Screw	<del>1663(819)</del>	Presser Bar Spring Washer	32574	Note: No. 22837 is furnished on order only	14033(8)	
624(830)	Feed Lifting Rock Shaft Bushing (front) Set Screw	2070	Tension Disc(2)	40392	Tension Releasing Pin	14034(8)	
624(830)	Feed Lifting Rock Shaft Bushing (front) Set Screw	2102	Rotating Hook Bobbin Case Latch Lever Fulcrum Pin	40393	Rotating Hook Bobbin Case Latch	14035(8)	
624(830)	Feed Lifting Rock Shaft Bushing (front) Set Screw	2974	Rotating Hook Bobbin Case Latch Spring	40393	Rotating Hook Bobbin Case Latch Hinge Nos. 2974, 40392 and 125320	14035(8)	
624(830)	Feed Lifting Rock Shaft Bushing (front) Set Screw	2975	Rotating Hook Bobbin Case Latch Spring	40394	Rotating Hook Bobbin Case Tension Spring	14035(8)	
624(830)	Feed Lifting Rock Shaft Bushing (front) Set Screw	4307	Bed Slide Spring	50027(850)	Feed Roll Plate Screw	14035(8)	
624(830)	Feed Lifting Rock Shaft Bushing (front) Set Screw	8582	Arm Dowel Pin(2)	<del>50027(850)</del>	Arm Side Shield Screw(2)	14035(8)	

281-30  
Numerical List of Parts for 281-28 Machine

DESCRIPTION	NUMBER	DESCRIPTION	NUMBER	DESCRIPTION
Bed Dog Screw(2)	140390(830)	Presser Foot Screw	143015	Arm Shaft (upright)
Oil Pump (centrifugal)	140410(830)	Arm Shaft (upright)		Bevel Gear (upper)
Impeller Locking Screw		Bushing (lower) Set Screw		left hand spiral with two 1259(830)
Impeller Releasing Lever	<del>140457(830)</del>	Feed Roll Guide Bar		Note: To ensure proper functioning of Gears No. 143015 will not be supplied
Adjustable Screw		Adjusting Screw		separately to Agencies, but will be substituted by Pair of Gears No. 147476
Slide Thumb Screw	140542(830)	Needle Bar Crank Position Screw	143016-001	Arm Shaft (upright)
Presser Bar Guide		Stitch Regulator Locking Slide Spring Screw		Bushing (lower)
Clamping Screw	140549(805)	Feed Roll Feed Regulator Locking Slide Spring Screw		Bed Hole Plug
Oil Flow Window Cap Screw(4)		Oil Removing Wick (head end) Holder	143024	Bed Hole Plug
Extension Stud Set Screw	140549(805)	Body Hinge Screw	<del>143024</del>	Feed Bar Carrier Oil Wick
Rotating Hook Shaft Oil Ring Set Screw(2)		Feed Roll Clutch Position Bracket Screw(2)	143040	Feed Lifting Rock
Feed Roll Clutch Shaft Clamping Crank Clamping Screw	140553(805)	Arm Top Cover (back) Stitch Regulator Plunger Hole Plug Screw (for plugging the Plunger Hole when the Plunger is removed to prevent tampering with the Stitch Set)	143049	Shaft Connecting Rod
Feed Roll Driving Shaft (horizontal) Spur Gear	<del>140601(805)</del>	Arm Top Cover (front) Stitch Regulator Plunger Hole Plug Screw (for plugging the Plunger Hole when the Plunger is removed to prevent tampering with the Stitch Set)	143056	Feed Rock Shaft
Feed Roll Shaft Spur Gear Cover Plate Screw(2)	140607(819)	Arm Oil Plug Screw	143056	Connecting Rod
Arm Shaft (upright) Bushing (upper) Set Screw		Thread Take-up Crank Clamping Screw Hole Plug Screw	143058	Needle Bar Connecting Link Roller Bearing(18)
Arm Shaft (horizontal) Plug Screw(2)	140607(819)	Needle Bar Connecting Stud Slide Block	143058	Thread Take-up Lever Roller Bearing(18)
Feed Roll Driving Shaft (horizontal) Bevel Gear		Oil Flow Body Gasket(2)	143061	Needle Bar Connecting Stud Slide Block
Clamping Screw(2)		Oil Flow Window	143062	Oil Flow Body
Machine Pulley Set Screw(2)		Oil Flow Window Cap Oil Pipe	143063	Gasket(2)
Arm Top Cover (front) Screw(4)		Oil Pipe Clamping Sleeve	143064	Oil Flow Window
Oil Lead Screw		Oil Pipe Clamping Sleeve Nut	143065	Oil Pipe
Arm Top Cover (back) Screw(4)		Oil Pump (centrifugal) Body with 143126	143066	Oil Pipe Clamping Sleeve Nut
Thumb Screw Lock Nut	140610(819)	Oil Pump (centrifugal) Body Position Pin(2)	143070	Oil Pump (centrifugal)
Knee Lifter Rock Shaft Crank Adjusting Screw Lock Nut	140610(819)	Oil Pump (centrifugal) Cover	143071	Body with 143126
Thread Take-up Spring Regulator with 1205(803)	140705(805)	Oil Pump (centrifugal) Impeller	143072	Oil Pump (centrifugal)
Thread Take-up Spring Thread Retainer	140706(803)	Oil Pump (centrifugal) Screen	143073	Cover
Presser Foot Hinge Pin	140788(805)	Oil Pump (centrifugal) Screen Frame	143074	Oil Pump (centrifugal)
Presser Foot Shank	140873(803)	Rotating Hook Shaft Bevel Gear (left hand spiral) with two 1259(830)	143075	Impeller
Arm Top Cover (front) Stitch Regulator Plunger Spring	140915(830)	Feed Lifting Rock Shaft Crank (front) Clamping Screw	143081	Oil Pump (centrifugal)
Arm Top Cover (back) Stitch Regulator Plunger Spring	<del>141030(805)</del>	Feed Roll Guide Bracket Screw(2)		Screen
Rotating Hook Bobbin Case Latch Lever	<del>141068(819)</del>	Feed Roll Driving Shaft (horizontal) Spur Gear and Feed Roll Shaft Spur Gear Cover Screw(2)		Screen Frame
Needle Bar Thread Guard Screw	<del>141143(805)</del>	Feed Roll Eccentric Connecting Rod Hinge Screw		Rotating Hook Shaft
Feed Lifting Rock Shaft Crank (back) Clamping Screw	141188(803)	Rotating Hook Oil Flow Regulating Thumb Screw		Bevel Gear (left hand spiral) with two 1259(830)
Feed Rock Shaft Crank Clamping Screw	141190(869)	Presser Foot Seat Adjusting Screw	143082-001	Note: To ensure proper functioning of Gears No. 143081 will not be supplied separately to Agencies but will be substituted by Pair of Gears No. 143295
Feed Lifting Rock Shaft Connecting Rod Hinge Screw		Note: No. 141190(869) is furnished on order only		Rotating Hook Shaft Bushing (back)
Feed Rock Shaft Connecting Rod Hinge Screw	141201(805)	Arm and Bed Leg (back) Screw(2)	143085	Feed Roll-Feed Regulator
Needle Bar Connecting Link Cap Screw	141202(805)	Arm Shaft (horizontal) Screw Plug (front)	143085	Stitch Regulator
Oil Wick Holder Screw			143086	Feed Roll Feed Regulator Locking Slide
Needle Set Screw	141208(830)	Thread Take-up Crank Clamping Screw	143086	Stitch Regulator Locking Slide
Feed Eccentric Stop Screw (7 stitch)	<del>141240(805)</del>	Feed Roll Guide Bar Screw(2)	143087	Stitch Regulator Locking Slide
Feed Eccentric Stop Screw (5-1/2 stitch)			143087	Stitch Regulator Locking Slide Ratchet Wheel
Feed Roll Clutch Shaft Arm Bushing (front) Set Screw			143088	Stitch Regulator Locking Slide Ratchet Wheel
Arm Shaft (horizontal) Bushing (center) Set Screw	141253(830)	Knee Lifter Rock Shaft Crank Clamping Screw	143088	Stitch Regulator Locking Slide Ratchet Wheel Pin
Arm Shaft (horizontal) Flanged Bushing (back) Set Screw			143104	Stitch Ratchet Wheel Pin
Feed Lifting Eccentric Position Screw	141253(830)	Knee Lifter Rock Shaft Stop Dog Clamping Screw	143108	Bell Crank Hinge Pin
Machine and Machine Base Oil Reservoir	143013	Arm Shaft (upright)		Presser Bar and Feed Roll Lifting Lever
Screw Hole Plug Screw	143014	Arm Shaft (upright) Bevel Gear (lower) right hand spiral with two 1259(830)	143109	Connecting Rod
Knee Lifter Rock Shaft Crank Adjusting Screw		Note: To ensure proper functioning of Gears No. 143014 will not be supplied separately to Agencies, but will be substituted by Pair of Gears No. 143295	143124	Presser Bar and Feed Roll Lifting Lever
Feed Rock Shaft Oil Screw Plug			143125	Connecting Rod Swivel
Feed Lifting Rock Shaft Oil Screw Plug			143126	Oil Pipe Clamping Sleeve
			143134	Oil Pipe Clamping Sleeve Nut
				Oil Pipe Clamping Sleeve Nut Adaptor
				Feed Roll Feed Regulator 143085 with 140549(805), 143086 and 143378

# SINGER

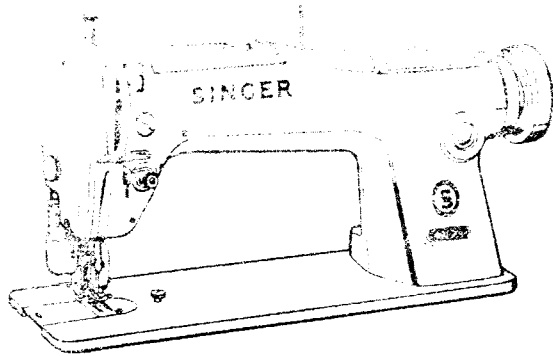

## TEMPORARY PARTS LIST 281-30 ~~281-20~~ BASIC MACHINE PARTS

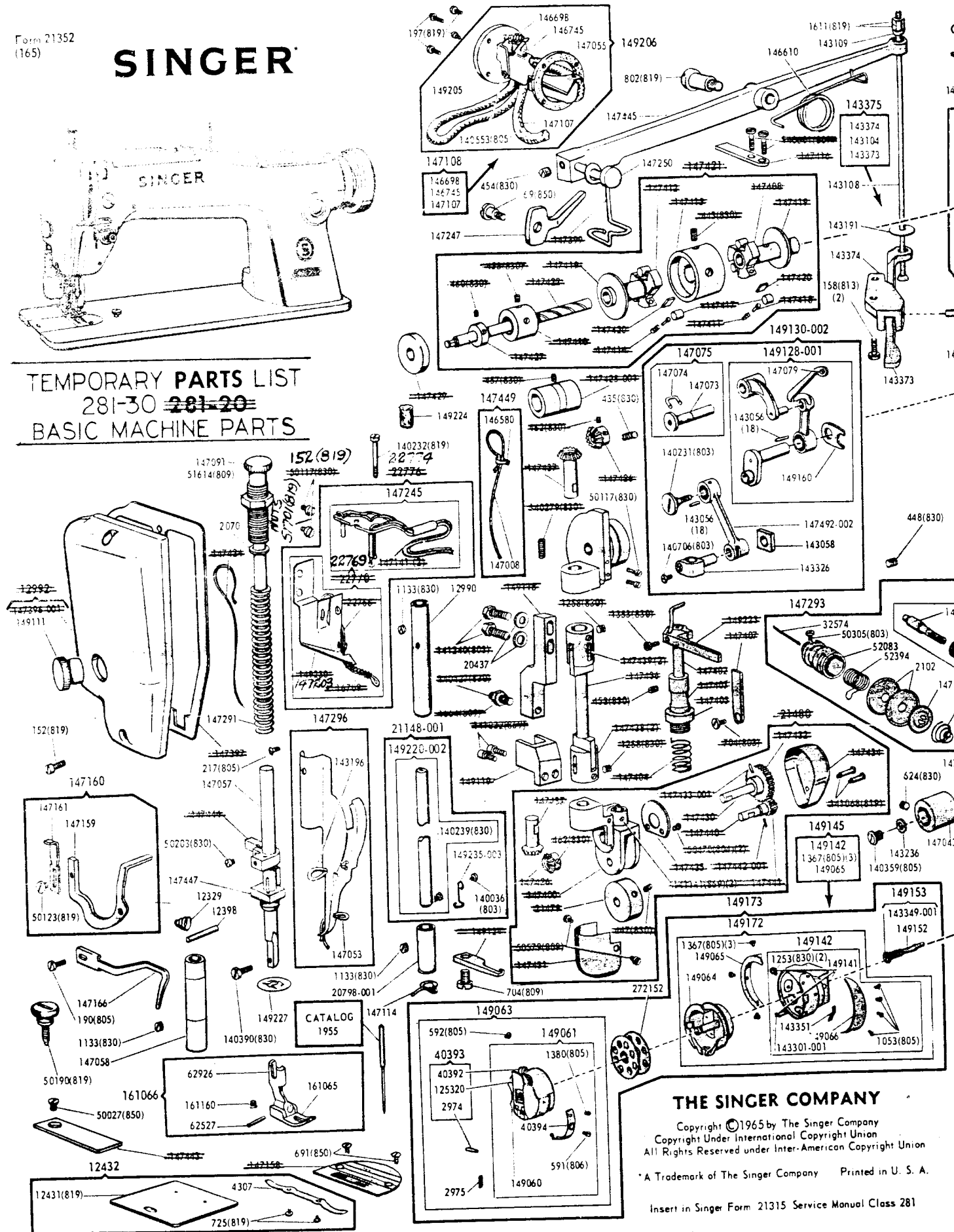

**THE SINGER COMPANY**  
Copyright ©1965 by The Singer Company  
Copyright Under International Copyright Union  
All Rights Reserved under Inter-American Copyright Union  
\* A Trademark of The Singer Company Printed in U. S. A.  
Insert in Singer Form 21315 Service Manual Class 281

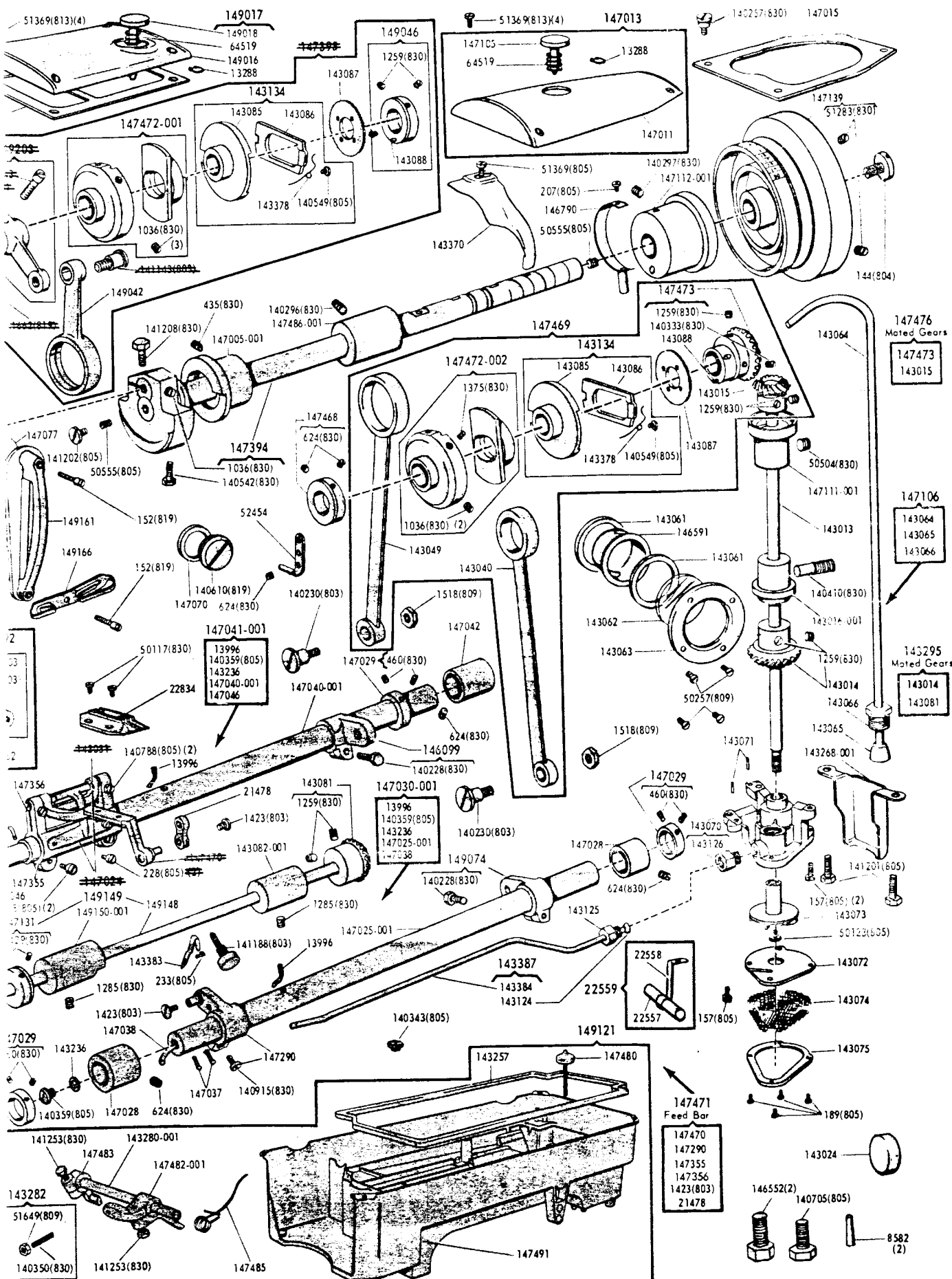

281-30  
Numerical List of Parts for ~~281-20~~ Machine

DESCRIPTION	NUMBER	DESCRIPTION	NUMBER	DESCRIPTION
Feed Roll Clutch (drive) Member Spring(3)	147472-002	Feed Eccentric	149145	Rotating Hook (Air Cooled) 149142 with 149065 and three 1367(805)
Feed Roll Clutch Body with two 443(830)	147473	Feed Lifting Eccentric and Arm Shaft (horizontal) Bevel Gear, right hand spiral with 1259(830), 140333(830) and 143088	149148	Rotating Hook Shaft with 149153
Feed Roll Clutch Position Bracket		Note: To ensure proper functioning of Gears, No. 147473 will not be supplied separately to Agencies, but will be substituted by Pair of Gears No. 147476	149149	Rotating Hook Shaft 149148 with 147131
Feed Roll Clutch Rolled(6)			149150-001	Rotating Hook Shaft Bushing (front)
Feed Roll Clutch Roller Plunger(6)			149152	Rotating Hook Shaft Oil Filter Wick
Feed Roll Clutch Washer(2)			149153	Rotating Hook Shaft Oil Filter complete, Nos. 143349-001 and 147152
Feed Roll Clutch Wearing Plate(6)	147476	Pair of Gears for Upper Shaft Nos. 143015 and 145473	149160	Thread Take-up Crank Wearing Plate
Feed Roll Clutch and Shaft complete, Nos. 147408, 147410, 147412, 147415, 147422, 147427 two 147419, three each 147411, 147414 and six each 147417, 147418 and 147420	147480	Knee Lifter Bell Crank Plunger	149161	Thread Take-up Lever Guard
	147482-001	Knee Lifter Rock Shaft Crank with 141253(830) and 143282	149166	Thread Eyelet and Thread Guard (front of arm)
	147483	Knee Lifter Rock Shaft Stop Dog with 141253(830)	149172	Rotating Hook (Air Cooled) 149142 with 149064, 149065 and three 1367(805)
Feed Roll Clutch Shaft	147485	Knee Lifter Rock Shaft Spring	149173	Rotating Hook (Air Cooled) 149172 with 149063 and 149153
Feed Roll Clutch Shaft Arm Bushing (front)	147486-001	Arm Shaft (horizontal) Bushing (center)		
Oil Wick with 146580	147491	Machine Base and Oil Reservoir		
Feed Roll Clutch Shaft Arm Bushing (rear)				
Feed Roll Clutch Shaft Bevel Gear with two 462(830)	147492-002	Needle Bar Connecting Link		
Feed Roll Driving Shaft (horizontal) Bevel Gear with two 462(830)	149016	Arm Top Cover (front)	<del>149203</del>	Feed Roll Clutch Shaft Driving Crank with 50443(830)
Feed Roll Clutch Shaft Collar with two 460(830)	149017	Arm Top Cover (front) with Stitch Regulator Plunger complete, Nos. 13288, 64519, 149016 and 149018	149205	Oil Removing Wick (head end) Hinge Plate and Cover
Feed Roll Clutch Shaft Oil Retainer (felt)	149018	Arm Top Cover (front) Stitch Regulator Plunger	149206	Oil Removing Wick (head end) Holder Body complete, Nos. 140553(805), 146698, 146745, 147055, 147107 and 149205
Feed Roll Driving Shaft (horizontal)	149042	Feed Roll Eccentric Connecting Rod		
Feed Roll Driving Shaft (horizontal) Bevel Gear Cover	149046	Feed Roll Feed Regulator Lacking Slide Ratchet Wheel Retaining Collar with 143088 and two 1259(830)	149220-002	Needle Bar (hollow) with 140239(830)
Feed Roll Driving Shaft (horizontal) Spur Gear			<del>149222</del>	Feed Roll Bracket Shaft Guide Bracket with 1353(830)
Feed Roll Driving Shaft (horizontal) Spur Gear Pin (1/2 in. long)	149060	Rotating Hook Bobbin Case	149224	Oil Wick Holder Plug (felt)
Feed Roll Driving Shaft (horizontal) Spur Gear and Feed Roll Shaft Spur Gear Cover	149061	Rotating Hook Bobbin Case 149060 with 591(806), 1380(805) and 40394	149227	Presser Bar Bushing (lower) Washer
Feed Roll Driving Shaft (horizontal) Spur Gear and Feed Roll Shaft Spur Gear Cover Plate	149063	Rotating Hook Bobbin Case complete, Nos. 592(805), 2974, 2975, 40392, 125320 and 149061	<del>149230</del>	Arm Side Shield
Feed Roll Driving Shaft (upright)	149064	Rotating Hook Bobbin Case Holder	149235-003	Needle Bar Thread Guard
Feed Roll Driving Shaft (upright) Bevel Gear (upper) and (lower)	149065	Rotating Hook Section	161065	Presser Foot Plate
Feed Roll Driving Shaft (upright) Driving Collar with two 1258(830)(2)	149066	Rotating Hook Thread Guard	161066	Presser Foot (spring hinged) complete, Nos. 62527, 62926, 161065 and 161160, for use with 22834 and 147158
Feed Roll Driving Shaft (upright) Hinge Pin (3/4 in. long)(2)	149074	Feed Lifting Rock Shaft Crank (back) with 140228(830)	161160	Presser Foot Spring
Feed Roll Shaft	149111	Face Plate Plug (for plugging the Presser Bar adjustment hole)	272152	Rotating Hook Bobbin Needle Cat. No. 1955 (Size No. 16)
Feed Roll Shaft Spur Gear	<del>149113</del>	Feed Roll Guide Bar	---	
Feed Roll Shaft Spur Gear Pin (3/8 in. long)	<del>149114</del>	Feed Roll Guide Bracket		
Feed Roll Plate	149121	Machine Base and Oil Reservoir with Knee Lifter Rock Shaft, Nos. 143257, 143280-001, 147480, 147482-001, 147483, 147485 and 147491		
Presser Bar Guide Bracket with 50203(830)	<del>149123</del>	Rotating Hook Bobbin Case Holder Position Bracket		
Presser Bar and Feed Roll Lifting Lever with 454(830)	149128-001	Thread Take-up Crank with Thread Take-up Lever with 149160 and eighteen 143056		
Presser Bar Lifting Bracket	149130-002	Thread Take-up Crank and Thread Take-up Lever complete		
Feed Roll Bracket Shaft Oil Retaining Wick 147008 with 146580				
Arm Shaft (horizontal) Thrust Collar with two 624(830)	149141	Rotating Hook (Air Cooled) with 143301-001 and two 1253(830)		
Combination of Feed and Stitch Regulator Parts, Nos. 143015, 143040, 143049, 143087, 143134, 147472-002 and 147473	149142	Rotating Hook (Air Cooled) 149141 with 143351, 149066 and four 1053(805)		
Feed Bar				
Feed Bar 147470 with 21478, 147290, 147355, 147356 and two 1423(803)				
Feed Roll Eccentric				



281-30  
Numerical List of Parts for ~~281-30~~ Machine

NUMBER	DESCRIPTION	NUMBER	DESCRIPTION	NUMBER	DESCRIPTION	NUMBER	DESCRIPTION
143124	Stitch Reg. Lever 143285 with 143549(803), 143066 and 143376	147025-001	Feed Lifting Rock Shaft	147141	Oil Wick, 11 in. long for oiling Take-up Lever, Take-up Lever Link, Needle Bar Connecting Link and Thread Take-up Lever Link Hinge Bearing(2)		
143191	Presser Bar and Feed Roll Lifting Lever Connecting Rod Oil Mist Retaining Disc (felt)	147028	Feed Lifting Rock Shaft Bushing (front)	147151	Tension Releasing Disc		
143196	Needle Bar Oil Wick	147028	Feed Lifting Rock Shaft Bushing (back)	147152	Tension Spring		
143246	Feed Lifting Rock Shaft Oil Seal Plug Washer (felt)	147029	Feed Lifting Rock Shaft Collar with two 460(830)(2)	<del>147156</del>	Throat Plate (large needle hole) for use with 22634 and 161066		
143256	Feed Roll Shaft Oil Screw Plug Washer (fiber)	147029	Feed Rock Shaft Collar with two 460(830)	147159	Tension Releasing Lever Body		
143260	Arm Top Cover (back) Spool Pin with Spool Rear, 3-1/2 in. long	147030-001	Feed Lifting Rock Shaft 147025-001 with 13996, 147038 and suitable length of No. 1229 White Lighter Wicking	147160	Tension Releasing Lever Body (adjustable) 147159 with 50123(819) and 147161		
143257	Machine Base and Oil Reservoir Gasket (cork)	147037	Feed Lifting Rock Shaft Oil Wick (short)(2)	147161	Tension Releasing Lever Segment		
143260-001	Bed Leg (back)	147038	Feed Lifting Rock Shaft Oil Wick (long)	147166	Slack Thread Regulator		
143260-001	Knee Lifter Rock Shaft	147040-001	Feed Rock Shaft	147206	Arm Top Cover (front) Gasket		
143282	Knee Lifter Rock Shaft Crank Adjusting Screw 140350(803) with 51649(809)	147041-001	Feed Rock Shaft 147040-001 with 13996, 147046 and suitable length of No. 1229 White Lighter Wicking	147245	Oil Wick Holder with two 147141		
143295	Pair of Gears for Lower Shaft, Nos. 143014 and 143051	147042	Feed Rock Shaft Bushing (back)	147247	Presser Bar Lifter		
143301-001	Rotating Hook Oil Wick (felt)	147043	Feed Rock Shaft Bushing (front)	147250	Presser Bar and Feed Roll Lifting Lever Pin		
143326	Needle Bar Connecting Stud with 140706(803)	147045	Feed Rock Shaft Oil Wick (short)	147290	Feed Lifting Rock Shaft Crank (front) with 140915(830)		
143349-001	Rotating Hook Shaft Oil Filter Wick Holder	147046	Feed Rock Shaft Oil Wick (long)	147291	Presser Bar Spring		
143351	Rotating Hook Wiper (leather)	147050-001	No. 216 B. Connecting Link 147492-002 with 143326	147292	Tension Stud 140873(803) with two 1560(803)		
143370	Oil Lead	147053	Needle Bar Connecting Stud Oil Wick	147293	Tension complete, Nos. 32574, 52083, 52394, 147151, 147152, 147292 and two 2102		
143373	Bell Crank	147055	Oil Removing Wick (head end) Hinge Plate and Cover Gasket	147296	Thread Take-up Lever Oil Guard with 143196 and 147053		
143374	Bell Crank Bushing	147057	Presser Bar (hollow)	147355	Feed Bar Carrier with two each 158(805) and 140788(805)		
143375	Bell Crank Complete, Nos. 143104, 143373 and 143374	147058	Presser Bar Bushing (lower)	147356	Feed Bar Hinge Pin (eccentric)		
143378	Feed Roll Feed Regulator Locking Slide Spring	147070	Thread Take-up Crank Clamping Screw Hole Plug Gasket	147394	Arm Shaft (horizontal) with 1036(830) and 140542(830)		
143378	Stitch Regulator Locking Slide Spring	147073	Thread Take-up Lever Link Hinge Stud	<del>147395</del>	Combination of Feed Roll Feed Parts, Nos. <del>140387</del> , 143087, 143134, 147472-001, 149042, 149046 and 149203		
143383	Rotating Hook Oil Flow Regulating Throat Screw Spring	147074	Thread Take-up Lever Link Hinge Stud Oil Wick	<del>147396-001</del>	Face Plate		
143384	Oil Pipe for oiling Rotating Hook Shaft (front) Bearing	147075	Thread Take-up Lever Link Hinge Stud 147073 with 147074	<del>147397</del>	Face Plate Gasket		
143387	Oil Pipe 143384 with 143124 for oiling Rotating Hook Shaft Front Bearing	147077	Thread Take-up Lever Guard Gasket	<del>147398-001</del>	Feed Roll (48 teeth) with 447(830)		
146099	Feed Roll Shaft Crank with 140228(830)	147079	Thread Take-up Lever Thread Eyelet Bushing Pressure Regulating Thumb Screw and Presser Bar Guide	<del>147399-001</del>	Feed Roll (32 teeth) with 447(830)		
146552	Arm Screw (front end intermediate)(2)	147091	Arm Top Cover (back) Stitch Regulator Plunger	<del>147400-001</del>	Feed Roll (48 teeth) with 447(830)		
<del>146580</del>	Feed Roll Bracket Shaft Oil Retaining Wick Clip	147105	Oil Pipe complete from Oil Pump to Arm Shaft (horizontal) Center Bearing, Nos. 143064, 143065 and 143066	<del>147401</del>	Feed Roll Bracket with two 141141(869)		
146560	Feed Roll Clutch Shaft Arm Bushing (front) Oil Wick Clip	147106	Oil Removing Wick (head end)	<del>147402</del>	Feed Roll Bracket Shaft	147	
146591	Oil Flow Body	147107	Oil Removing Wick (head end) Holder Body	<del>147403</del>	Feed Roll Bracket Shaft Bushing	147	
146610	Presser Bar and Feed Roll Lifting Lever Spring	147108	Oil Removing Wick (head end) Holder Body 146745 with 146698 and 147107	<del>147404</del>	Pressure Spring	147	
146698	Oil Removing Wick (head end) Holder Body Spring	147111-001	Arm Shaft (upright) Bushing (upper)	<del>147405</del>	Feed Roll Bracket Pressure Spring	147	
146745	Oil Removing Wick (head end) Holder Body	147112-001	Arm Shaft (horizontal) Flanged Bushing (back)	<del>147406</del>	Pressure Spring Adjusting Nut	147	
146790	Arm Shaft (horizontal) Flanged Bushing (back) Oil Sump Tube	147114	Needle Bar Bushing (lower) Thread Eyelet	<del>147407</del>	Feed Roll Bracket Shaft Guide Bracket Holder	147	
147005-001	Arm Shaft (horizontal) Flanged Bushing (front)	147131	Rotating Hook Shaft Oil Retaining Collar with two 50429(830)	<del>147408</del>	Feed Roll Clutch (brake)		
147008	Feed Roll Bracket Shaft Oil Retaining Wick	147139	Machine Pulley small rim diameter (disc power) "V" belt groove 2.9 in. diam., with two 51283(830)	<del>147409</del>	Feed Roll Clutch (brake) Bushing with two 453(830)		
147011	Arm Top Cover (back) for 147013			<del>147410</del>	Feed Roll Clutch (brake) Member Spring(3)		
147013	Arm Top Cover (back) with Stitch Regulator Plunger complete, Nos. 13288, 64519, 147011 and 147105			<del>147411</del>	Feed Roll Clutch (drive)	147	
147015	Arm Top Cover (back) Gasket			<del>147412</del>			
<del>147017</del>	Feed Bar Carrier Oil Wick Holder with 143031			<del>147413</del>			