

Yamato[®]

Instruction Manual


HIGH SPEED FLAT BED INTERLOCK STITCH MACHINE
WITH RIGHT HAND FABRIC TRIMMER AND METERING DEVICE

**VF2429G, S, VF2529G, S
VF2439-1, VF2539-1**


This instruction manual includes adjustments differed from VF2400.

Before using your machine mentioned above, please read both of the instruction manuals and understand the contents well. After reading the instruction manual, please keep it in a location where it is easily accessible to the operator.

CONTENTS

Safety instructions	i
1. Sewing speed	1
2. Installation	2
2.1 Supporting board (Semi-submerged type)	2
2.2 Table cutting diagram (Semi-submerged type)	3
2.3 Control panel (only for VF2429G, S, VF2529G, S)	4
2.4 Wiring (only for VF2429G, S, VF2529G, S)	5
2.5 Connecting power cords (only for VF2429G, S, VF2529G, S)	6
2.6 Changing voltage (only for VF2429G, S, VF2529G, S)	6
2.7 Precautions (only for VF2429G, S, VF2529G, S)	6
3. Proper operation	7
 3.1 Threading	7
3.2 Setting elastic tape	8
3.3 When not using metering device (only for VF2429S and VF2529S)	8
3.4 Feeding amount of elastic lace (only for VF2439-1, VF2539-1)	9
3.5 Designations and functions of control panel (only for VF2429G, S, VF2529G, S)	10
4. Adjustments	15
4.1 Chip guard and presser foot tape guide	15
4.2 Tape guide	16
4.3 Pressure of elastic feed roller	17
4.4 Maintenance of metering device	17
4.5 Trimming width	18
4.6 Trimming mechanism	19
4.6.1 Installing and removing lower knife	19
4.6.2 Installing and removing upper knife	19
4.6.3 Engagement of upper and lower knives	20
4.6.4 Sharpening knives	20
5. Specifications	21

Attention

- ◇ This instruction manual is designed mainly for technicians, but it is advisable that also operators read the instructions with  mark to use the machine properly.
- ◇ The numbers in lower left corners of figures are figure numbers. We use them in texts as needed for your reference.

Attention

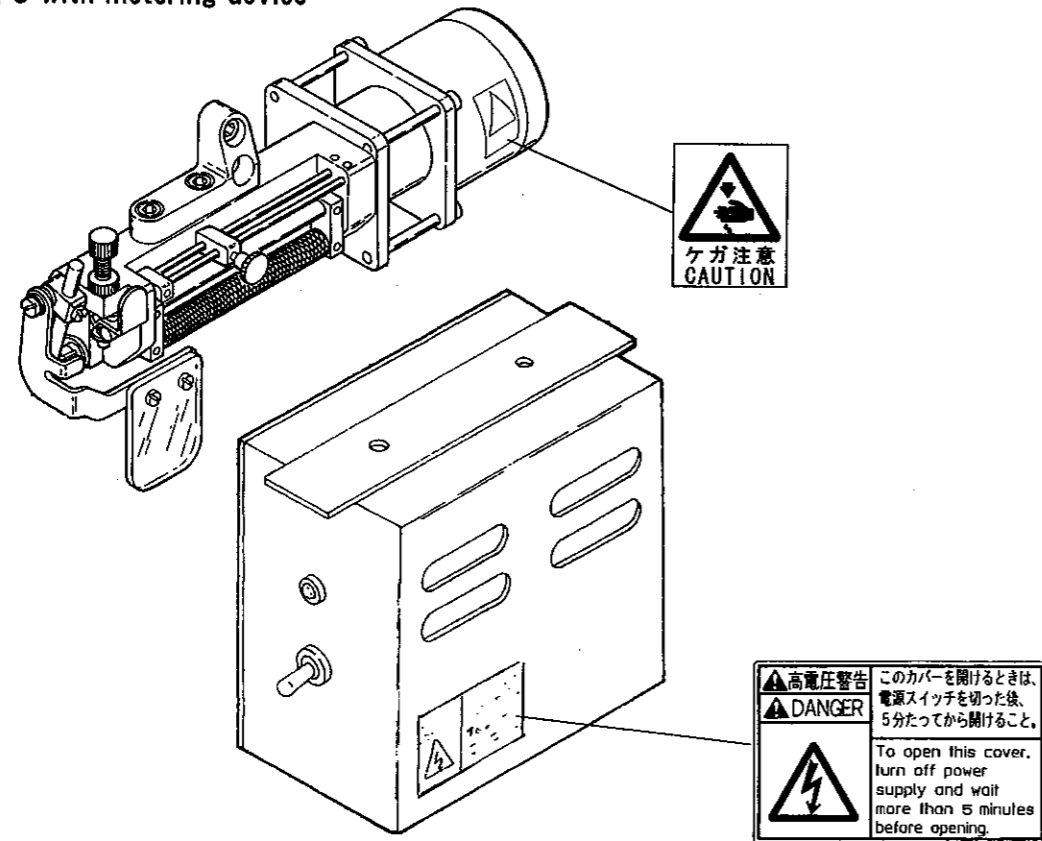


Safety instructions

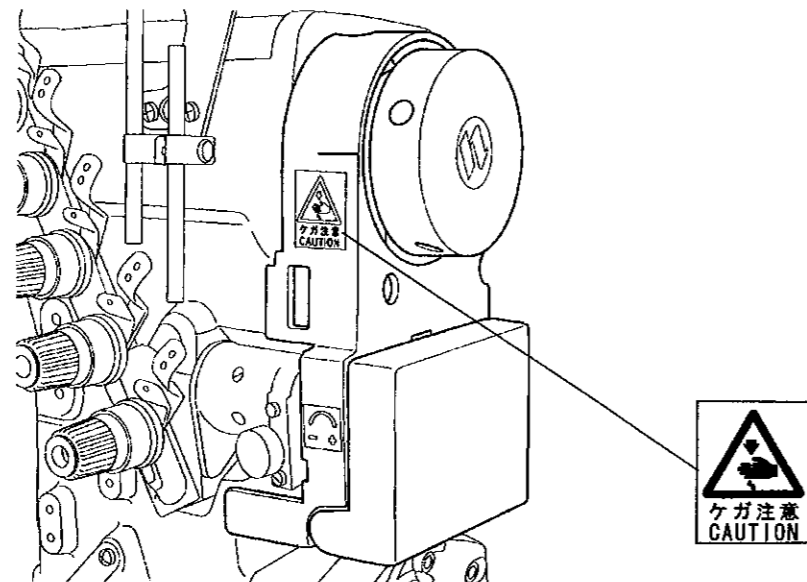


Warning label on sewing machine

VF2429G, S with metering device



VF2439-1 with metering device



1. Sewing speed

Maximum sewing speed is 5000 rpm and standard speed is 4500 rpm.

Run a new machine at 4300 rpm during the first 200 hours (for about one month) so that the machine can offer a long service life in good condition.

2.3 Control panel (only for VF2429G, S, VF2529G, S)

Install the control panel to the machine table through a setting hole ($\phi 16$) after drilling it. (See Fig. 5)

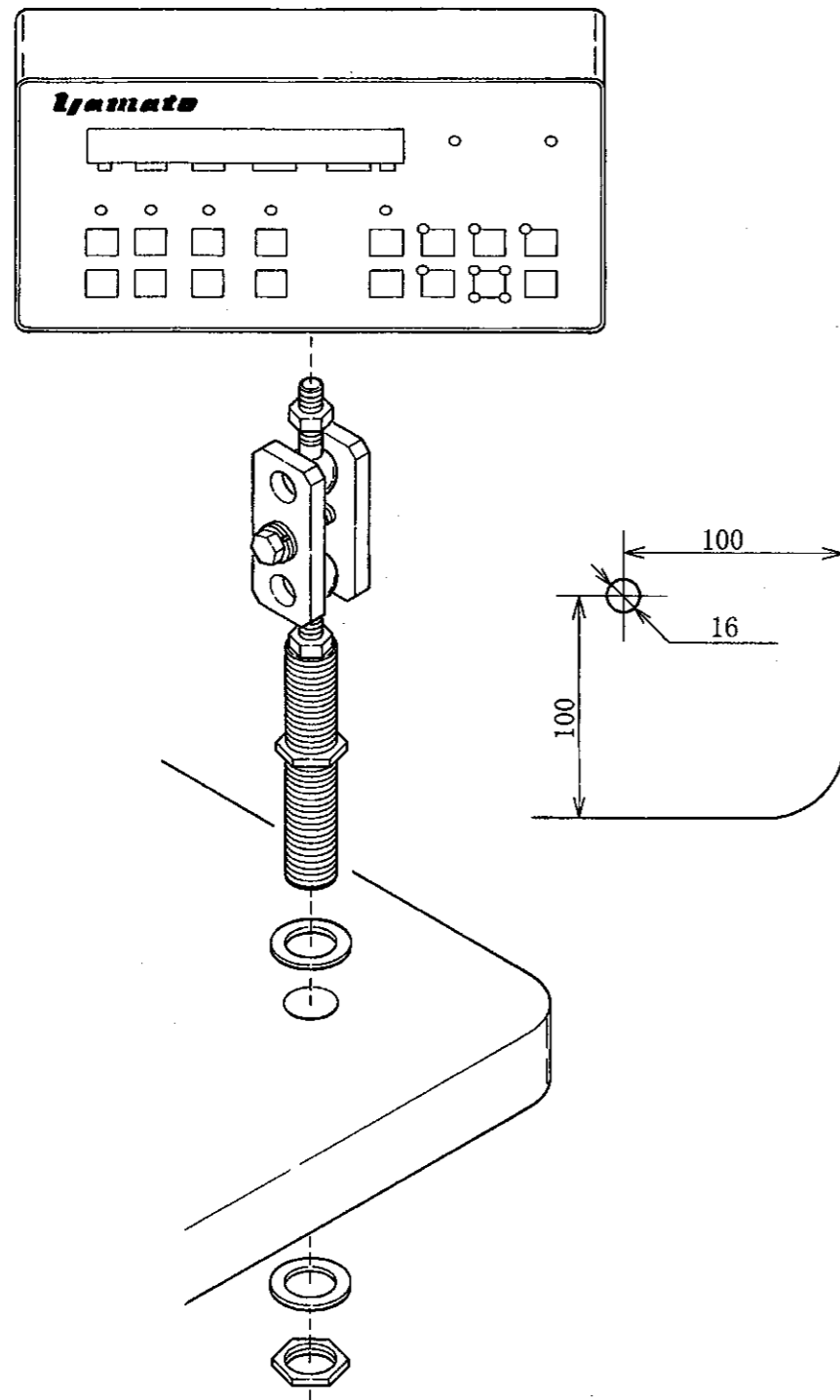


Fig. 5

2.4 Wiring (only for VF2429G, S, VF2529G, S)

WARNING

Turn the power switch OFF before operating.

Connect each connector to the corresponding connector.

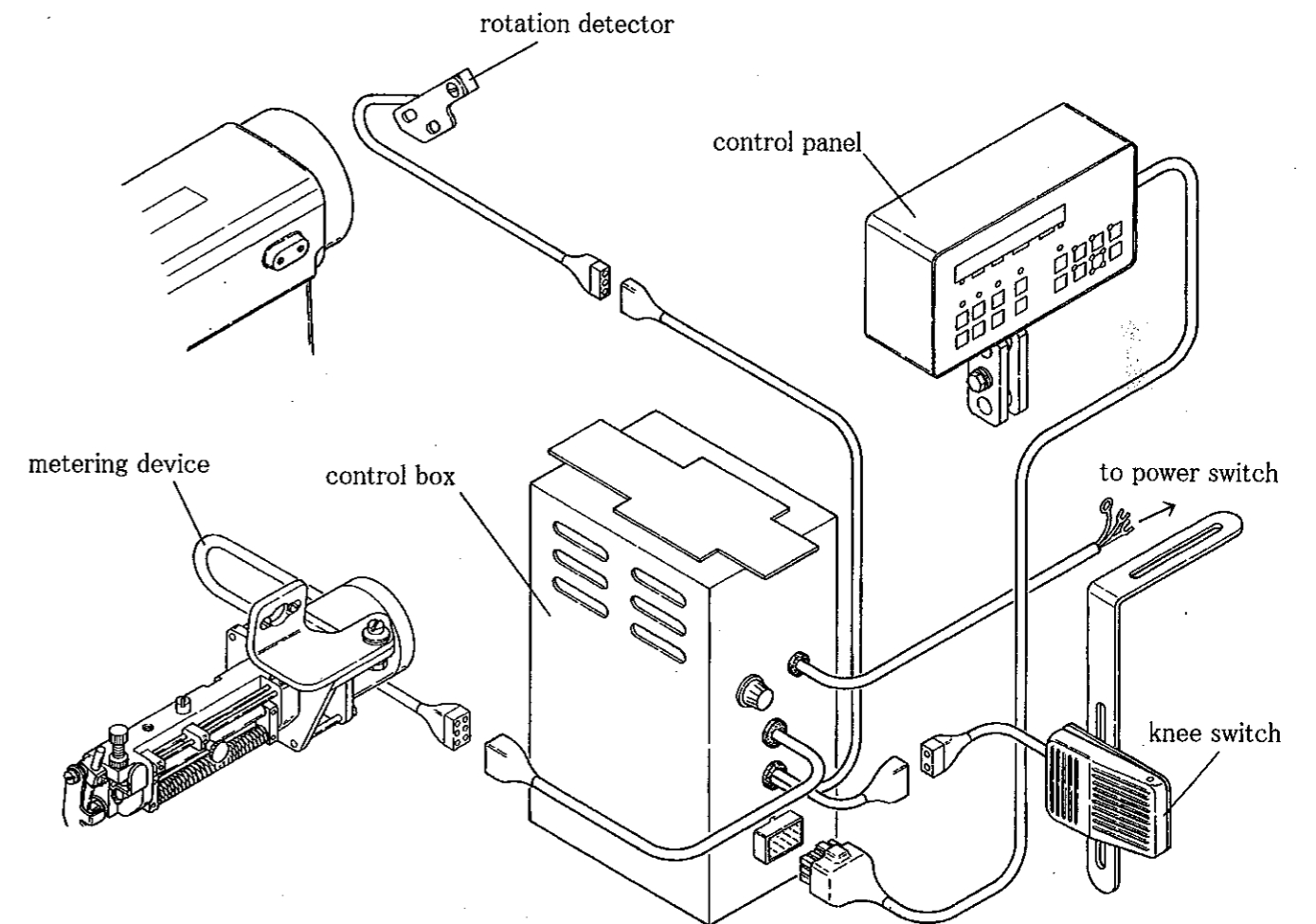


Fig. 6

2. Installation

2.5 Connecting power cords (only for VF2429G, S, VF2529G, S)

WARNING

Unplug the power cord from outlet before operating.

Connect red and black cords of power cord to the motor side terminals of the power switch.

Connect the green cord used for the earth to the same screw used for the earth of the motor.

(See Fig. 7)

Note: Connect the cords to the motor side terminals in the power switch.

CAUTION

Touching the cords to moving parts can cause breakage. Fix them to the legs of the table without breaking.

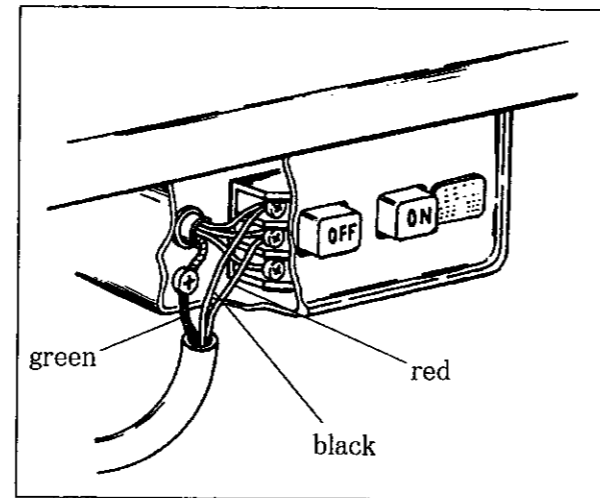


Fig. 7

2.6 Changing voltage (only for VF2429G, S, VF2529G, S)

WARNING

Unplug the power cord from outlet and then operate after five minutes and more.

Applicable voltages are indicated on the control box.

- Change the pin into the transformer terminal depending on the voltage to be used.
- Change the fuse depending on its voltage referring to Table 2.

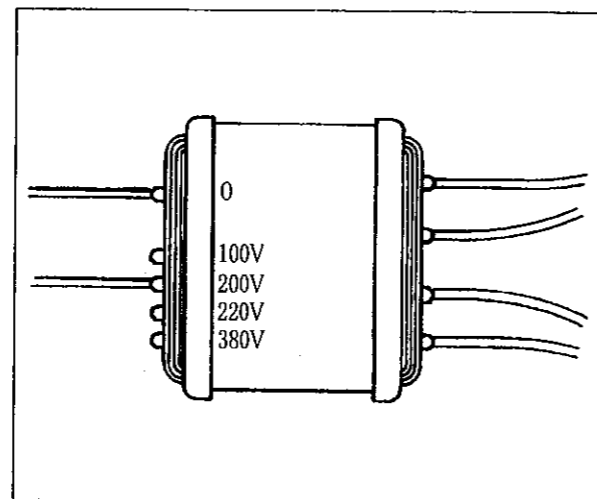


Fig. 8

2.7 Precautions (only for VF2429G, S, VF2529G, S)

Use applicable fuse specified on the control box.

The same diameter of a glass tube cannot be always used for the same capacity of ampere.

Check the ampere to be used. (See Table 2)

CAUTION

If used over specified capacity of fuse, it can cause serious trouble.

power voltage	capacity of fuse
100V	4A
200V	2A
220V	2A
380V	1A

Table 2

3. Proper operation

3.1 Threading

WARNING

Before operating, ALWAYS turn the motor switch OFF and check that the motor has already stopped.

Set the needle thread retainer disc to the needle clamp on this machine.

Thread through the needles as shown in Fig. 9.

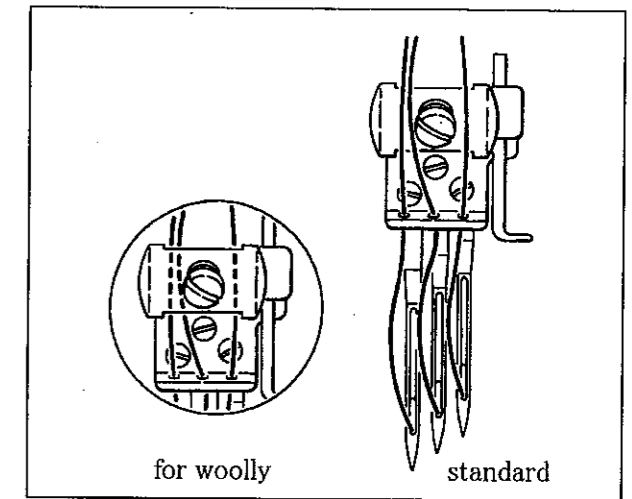


Fig. 9

3.2 Setting elastic tape

Set a tape correctly referring to Fig. 10.
 Pressing the roller lever ① will make a clearance between the rollers.
 Pull a tape through the bottom of the presser foot ②.

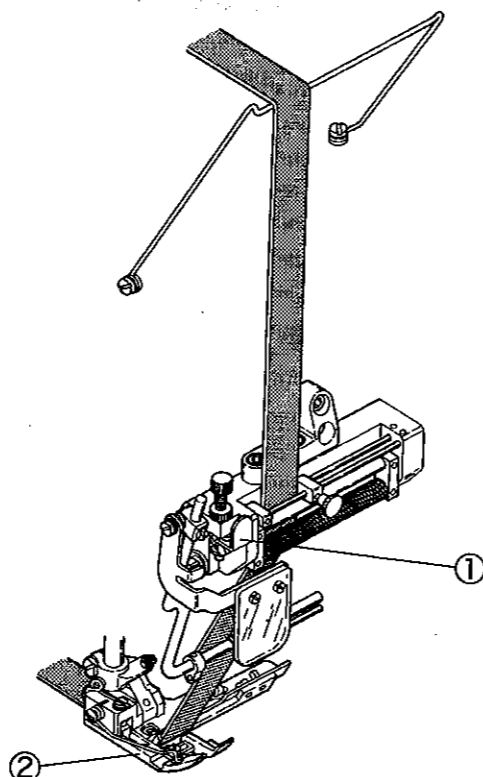


Fig. 10

3.3 When not using metering device (only for VF2429S and VF2529S)

Pull the left end toward you and turn it to the right to see around the needle drop easily.

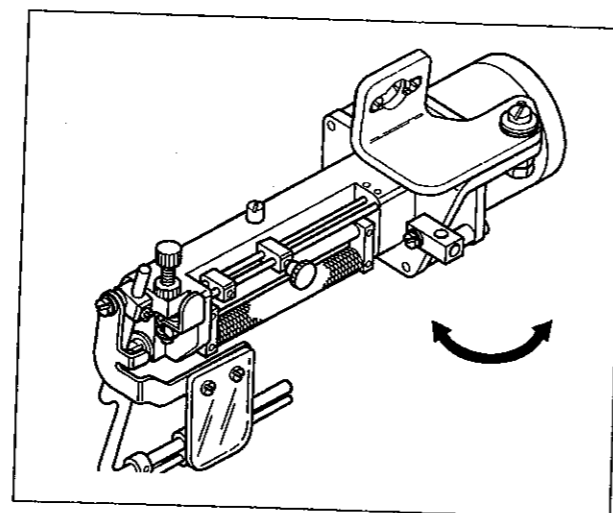


Fig. 11

3.4 Feeding amount of elastic tape (only for VF2439-1, VF2539-1)

Loosen the nut ① and adjust feeding amount while checking the pointer ② and the graduations of the clutch lever ③ as below.

- To increase feeding amount, turn the adjusting screw ④ clockwise and move the pointer ② in the direction "L".
- To decrease feeding amount, turn the adjusting screw ④ counterclockwise and move the pointer ② in the direction "S".

Note: After tightening the nut ①, turn the adjusting screw ④ clockwise to tighten it securely without play.

If required feeding amount cannot be obtained, loosen the screw ⑤ and adjust it as below.

- To decrease feeding amount, turn the adjusting screw ⑥ clockwise.
- To increase feeding amount, turn the adjusting screw ⑥ counterclockwise.

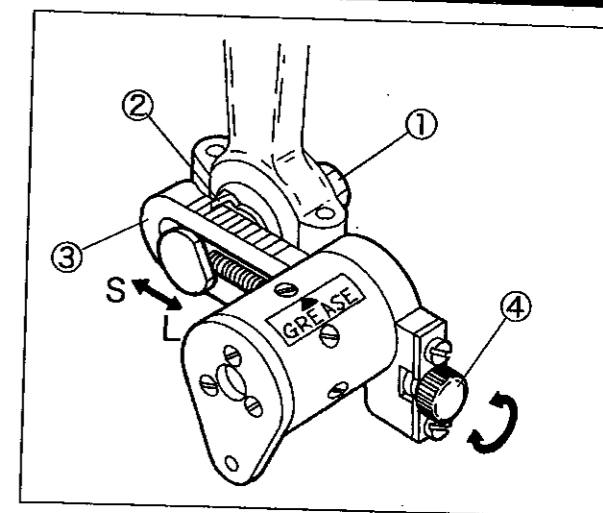


Fig. 12

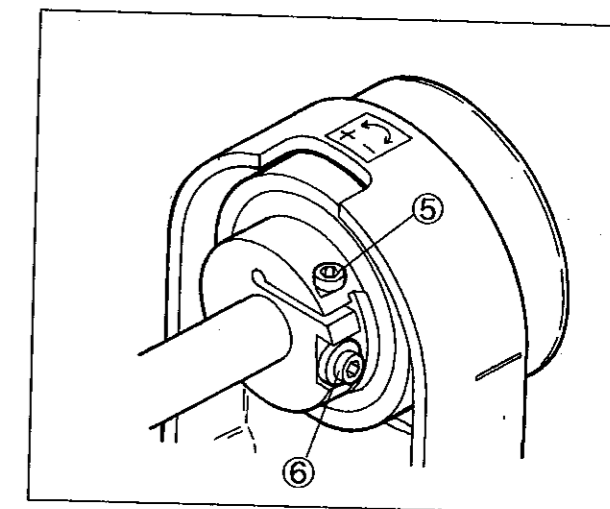
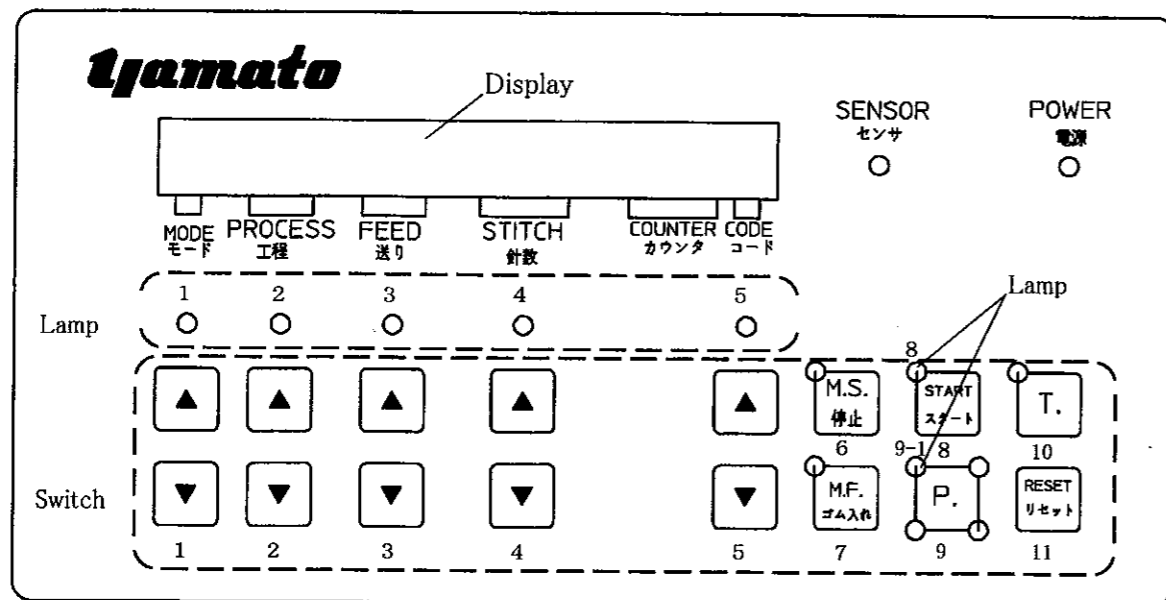


Fig. 13

3.5 Designations and functions of control panel (only for VF2429G,S, VF2529G, S)

This model has modes A - Z and each mode can be subdivided into 20 processes.

Set one mode corresponding one piece of fabric and one process depending on the tension amount of a tape on its fabric.



3.5.1 Details of control panel

(1) Display

Numbers and alphabets are displayed to show the current control condition.

(2) Lamp (1, 2, 3, 4, and 5)

The switch under the lit lamp can be functioned.

(3) Switch

For the following switches, pressing ▲ increases the value and pressing ▼ decreases it.

☆ Switch 1 (Mode)

Select the mode A - Z.

☆ Switch 2 (Process)

Set the process 1 - 20. Feeding amount, stitch number, and the code in the process are displayed.

☆ Switch 3 (Feeding)

Set the feeding amount. Keep pressing it will increase or decrease the value automatically.

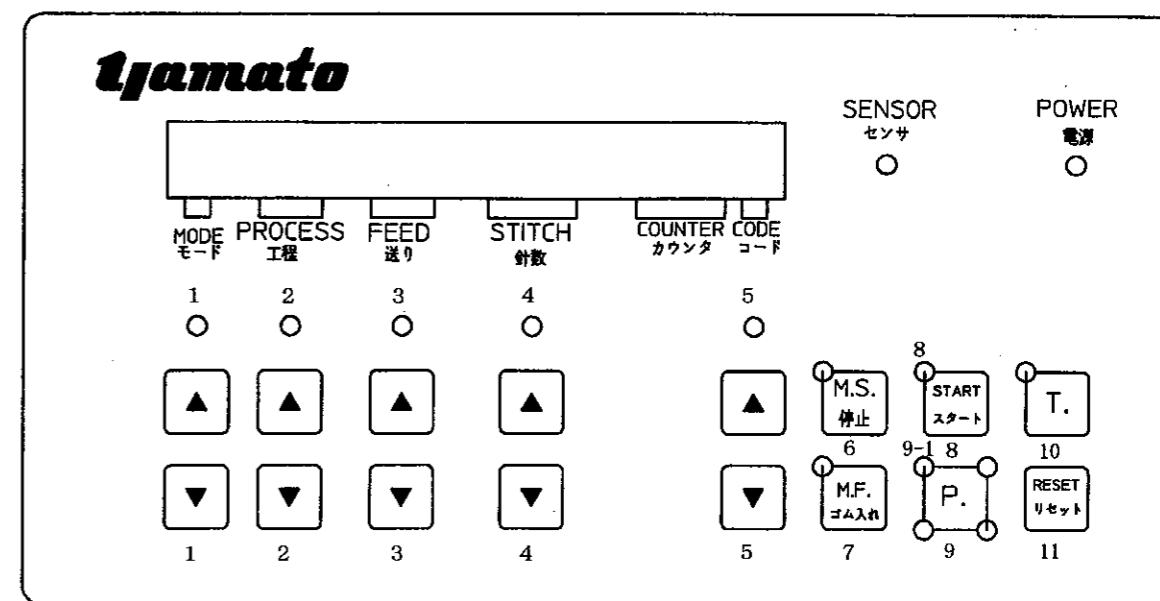
☆ Switch 4 (Stitch number)

Set the stitch number. Keep pressing it will increase or decrease the value automatically.

What is process? What is mode?

Process: to sew a fabric under preset conditions (feeding, stitch number)

Mode: to sew a part of fabric with some combined processes.



☆ Switch 5 (Code)

Set the code to proceed the program.

Select the code depending on the function.

Code A: Press the knee switch to shift the next process.

Code B: After sewing preset stitch number, the sewing shifts to the next process automatically.

It shows which number of stitch at the process on the counter display during sewing.

Code C: Return to 1st Process.

Be sure to set Code C when 3rd Process for Process 2 fabrics and when 7th Process for Process 6 fabrics.

☆ Switch 6, 7

Not used.

☆ Switch 8 (Start)

Pressing this switch will light Lamp 8. (Also When the power switch turns on, it will light.)

Only in this state, sew the fabrics and change the feeding amount.

☆ Switch 9 (P.)

When the machine stops, pressing this switch will light Lamp 9-1.

Only in this state, change mode, process, feeding amount, stitch number, and code.

☆ Switch 10

Not used.

☆ Switch 11 (Reset)

When the machine stops, pressing this switch will return to 1st Process.

(4) Sensor lamp

Not used.

(5) Power lamp

This lamp lights when the power turns on.

3. Proper operation

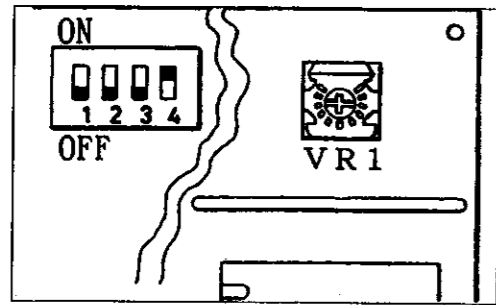
3.5.2 Feeding amount

Table 3 shows feeding tape length of stepping motor (mm/stitch) when setting feeding amount from "00" to "99".

Adjust the feeding amount by Switch "S1" in the control box.

OFF: to adjust standard feeding tape length

ON: to adjust feeding tape length shorter



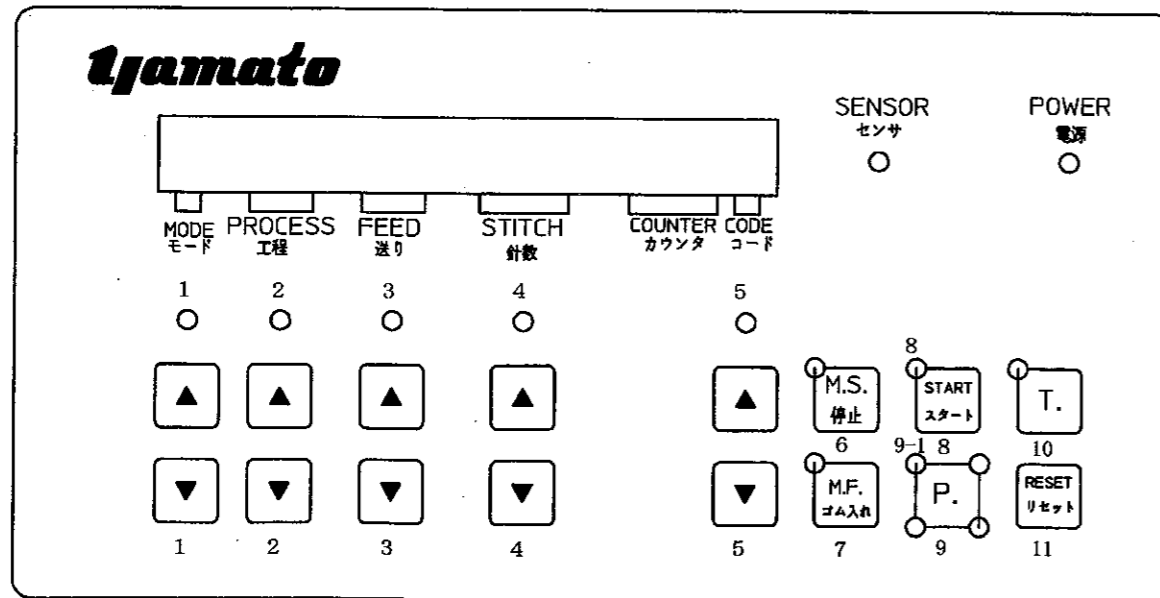
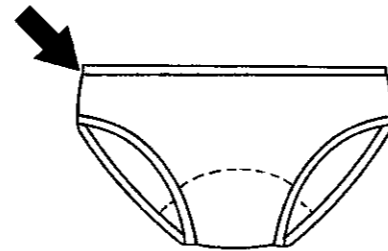
Feeding amount	Feeding length (mm)	
	S1 : OFF	S1 : ON
00	1.00	0.36
20	1.63	1.00
40	2.26	1.63
60	2.89	2.26
80	3.52	2.89

Table 3

3.5.3 Example of application

(Ex. 1) When sewing waist at one process, program by the keys as below.

The machine has been adjusted the same at shipment as shown in the right.



Display

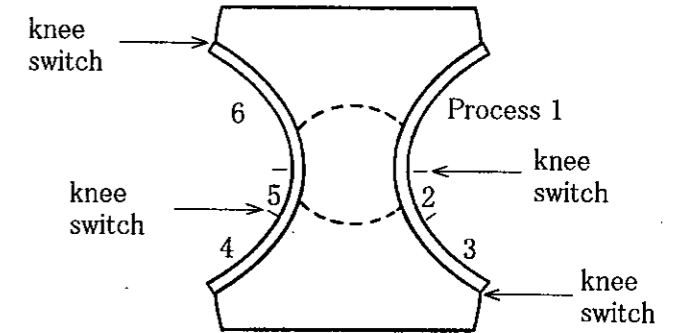
1. Set the process to "1" by reset switch (Switch 11).
2. Set it the programming state by Switch 9.
3. Set the code to "A" by Switch 5.
4. Set it the starting state by Switch 8.
5. Set the proper feeding amount to "30" by Switch 3 while sewing.
6. Finished.

* After that, place a fabric and start sewing.

A 01 30 000 000 A
A 01 30 000 A
A 01 30 000 A
A 01 30 000 000 A
A 01 30 000 000 A

3. Proper operation

(Ex. 2) When sewing both of the leg parts, make it flat in Processes 1, 3, 4, and 6 and gathering in Processes 2 and 5. Set the stitch number by setting code B in Processes 2 and 5. (Set the feeding amount and the stitch number to the standard value respectively.)



Programming set

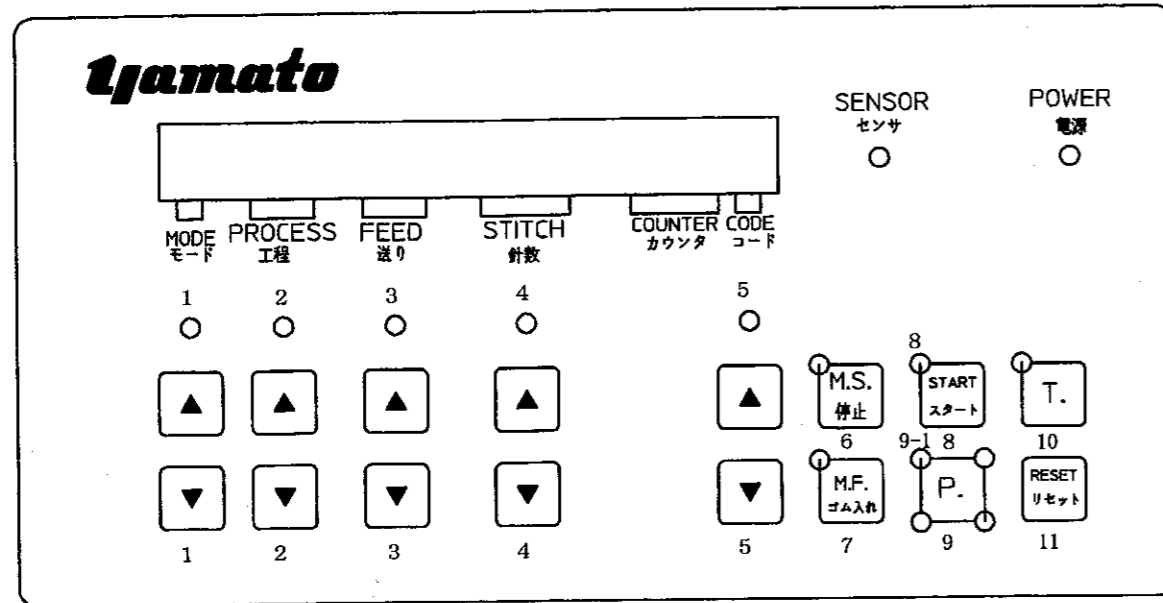
1. Set the process to "1" by Switch 11.
2. Set it the programming state by Switch 9.
3. Set the mode to "B" by Switch 1.
4. Set the feeding amount to "30" by Switch 3.
5. Set the code to "A" by Switch 5.
6. Set the process to "2" by Switch 2.
7. Set the feeding amount to "05" by Switch 3.
8. Set the stitch number to "050" by Switch 4.
9. Set the code to "B" by Switch 5.
10. Set the process to "3" by Switch 2.
11. Set the feeding amount to "31" by Switch 3.
12. Set the code to "A" by Switch 5.
13. Set the process to "4" by Switch 2.
14. Set the feeding amount to "35" by Switch 3.
15. Set the code to "A" by Switch 5.
16. Set the process to "5" by Switch 2.
17. Set the feeding amount to "04" by Switch 3.
18. Set the stitch number to "050" by Switch 4.
19. Set the code to "B" by Switch 5.
20. Set the process to "6" by Switch 2.
21. Set the feeding amount to "34" by Switch 3.
22. Set the code to "A" by Switch 5.
23. Set the process to "7" by Switch 2.
24. Set the code to "C" by Switch 5.

* All programs have been input completely.

Display

A 01 30 000 000 A
A 01 30 000 A
B 01 00 000 A
B 01 30 000 A
B 01 30 000 A
B 02 00 000 A
B 02 05 000 A
B 02 05 050 A
B 02 05 050 B
B 03 00 000 A
B 03 31 000 A
B 03 31 000 A
B 04 00 000 A
B 04 35 000 A
B 04 35 000 A
B 05 00 000 A
B 05 04 000 A
B 05 04 050 A
B 05 04 050 B
B 06 00 000 A
B 06 34 000 A
B 06 34 000 A
B 07 00 000 A
B 07 00 000 C

3. Proper operation



Sewing procedures

- Set the process to "1" by Switch 2.
- Set the starting state by Switch 7.
- Place a fabric and sew in Process 1.
Set the proper feeding amount to "29" by Switch 3 while sewing.
- Shift to Process 2 by pressing the knee switch.
Set the proper feeding amount to "05" by Switch 3 while sewing.
- After count up, it shifts to Process 3 automatically.
- Set the proper feeding amount to "35" by Switch 3 while sewing.
- Shift to Process 4 by pressing the knee switch.
- Set the proper feeding amount to "37" by Switch 3 while sewing.
- Shift to Process 5 by pressing the knee switch.
- After count up, it shifts to Process 6 automatically.
- Set the proper feeding amount to "32" by Switch 3 while sewing.
- Press the knee switch to finish the sewing.
- Check that the stitch number is proper.
If not, re-set proper value.

Display

B	01	30	000	A	
B	01	30	000	A	
B	01	30	000	000	A
B	01	29	000	000	A
B	02	05	050	000	B
B	03	31	000	000	A
B	03	35	000	000	A
B	04	35	000	000	A
B	04	37	000	000	A
B	05	04	050	000	B
B	06	34	000	000	A
B	06	32	000	000	A
B	01	29	000	000	A

4. Adjustments

WARNING

Before adjusting, ALWAYS turn the motor switch OFF and check that the motor has already stopped.

4.1 Chip guard and presser foot tape guide

VF2429G, S, VF2529G,S

Loosen the screw② to adjust the presser foot tape guide① right or left depending on the needle distance and a part to be sewn on a tape.

Set the chip guard③ depending on a trimming width.

Loosen the screw④ to set it near the upper knife as closely as possible.

VF2439-1, VF2539-1

Adjust the lace guide(left)⑤ right or left depending on the needle distance and a part to be sewn on a tape.

Set the lace guide(right)⑥ depending on a tape width.

Loosen the screws⑦⑧ to adjust them.

Set the chip guard⑨ depending on a trimming width.

Loosen the screw⑩ to set it near the upper knife as closely as possible.

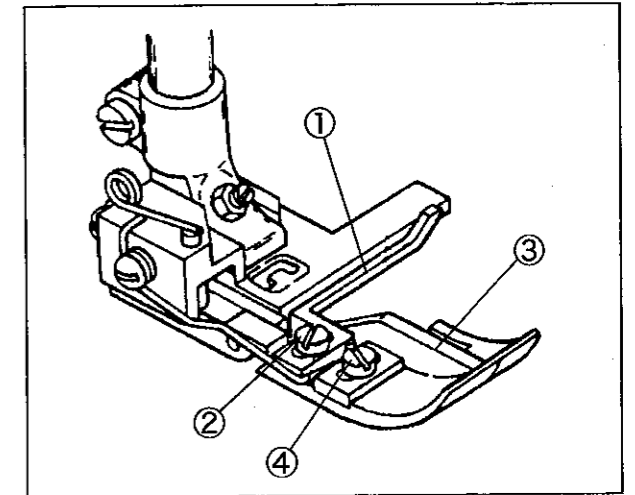


Fig. 14

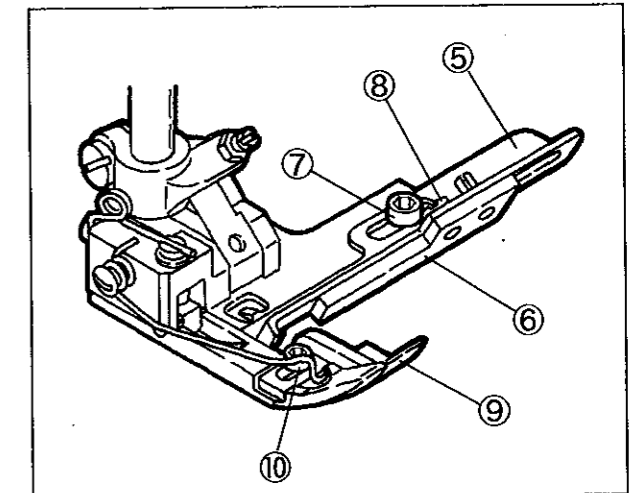


Fig. 15

WARNING

Before adjusting, ALWAYS turn the motor switch OFF and check that the motor has already stopped.

4.2 Tape guide

- (1) Set the tape guide bar(long)① to a low position enough for sewing.
- (2) Set the inside of the tape guide, c. set② along "A" on the presser foot tape guide③ or the lace guide(left)⑤. Set the tape guide④ to guide a tape smoothly depending on a tape width.
- (3) After positioning the tape guide bar(long)①, loosen the screw⑥ to position the tape guide stopper⑦. It prevents the needle bar from touching the tape guide, c. set② and makes the position of the tape guide bar(long)①.

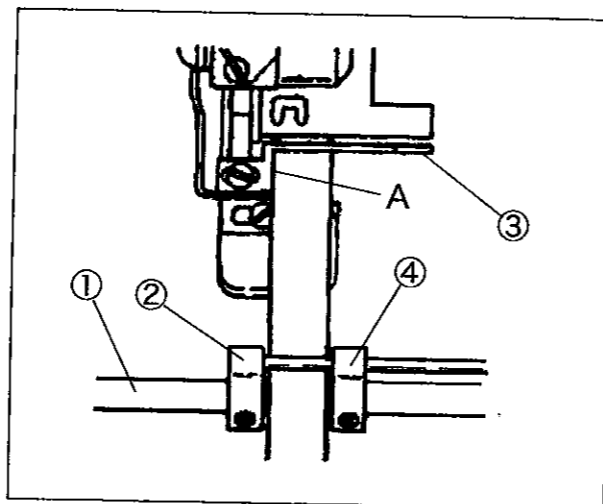


Fig. 16 VF2429G, S, VF2529G, S

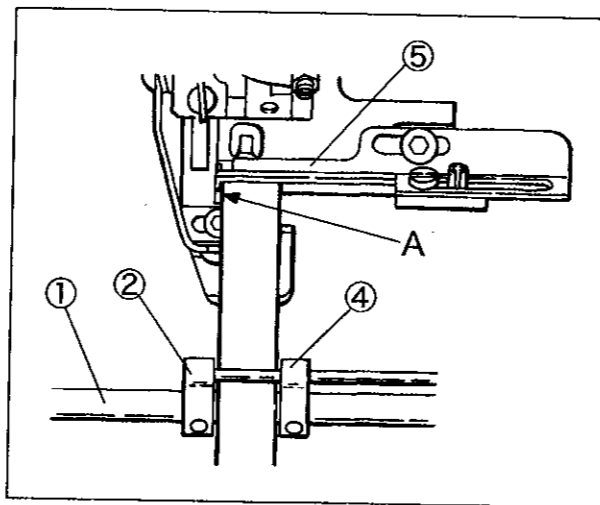
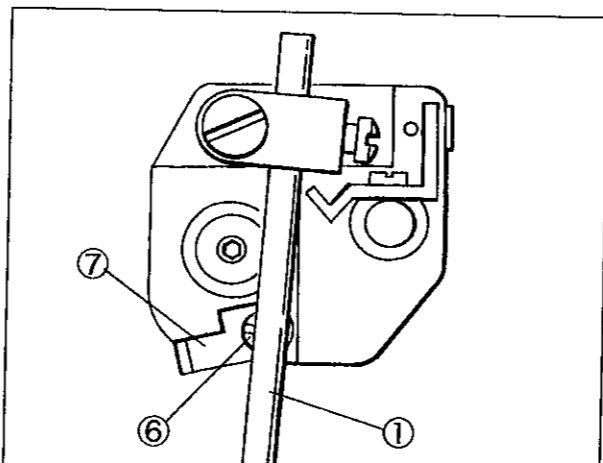


Fig. 17 VF2439-1, VF2539-1

**WARNING**

Before adjusting, ALWAYS turn the motor switch OFF and check that the motor has already stopped.

4.3 Pressure of elastic feed roller

To adjust the pressure of elastic tape with tension roller (small)①, loosen the lock nut② and turn the adjusting screw③.

- To increase the pressure, turn the adjusting screw③ clockwise.
 - To decrease the pressure, turn it counterclockwise.
- Keep the pressure as low as possible.
Too tight or loose pressure can cause uneven feeding of a tape.

REFERENCE

Too much change in tension of a tape from the bobbin may occur uneven sewing finish size even if the tension roller(large) feeds an elastic tape correctly. An automatic elastic feeder "AEF-31" can feed an elastic tape smoothly and constant sewing finish can be obtained.

4.4 Maintenance of metering device**Replacement and repair:**

Improper installation of the metering device can cause improper feeding of an elastic tape, skip stitch, needle breakage, bad sewing performance and others.

Carefully install the device as following points:

- (1) Check that the roller shaft turns smoothly after setting it. Loosen the screws④ and⑤ and make interlining to adjust it. (only for VF2439-1, VF2539-1)
- (2) Set the tension roller(small)① to turn smoothly like a top. Improper turning of it can cause irregular feeding of a tape.
- (3) Set the tension link⑥ and its shaft to turn smoothly.
- (4) Set the tension spring pressure of the tension roller (small)① as low as possible so that it can follow the rotation.

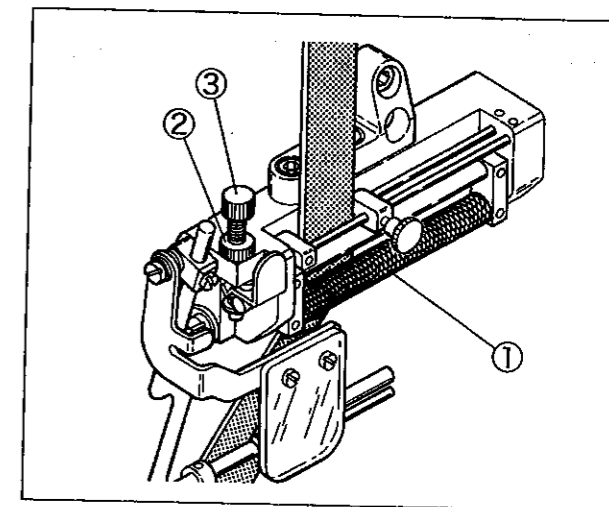
Lubrication:

Fig. 19

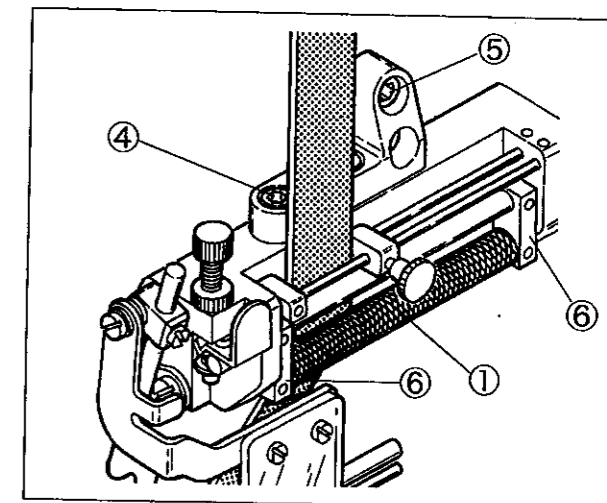
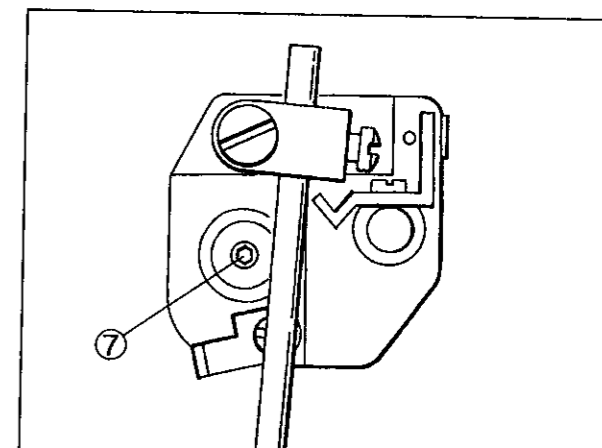


Fig. 20



WARNING

Before adjusting, ALWAYS turn the motor switch OFF and check that the motor has already stopped.

4.5 Trimming width

Open the side cover and loosen the screw ①. Then, the upper and lower knife holders move right and left at the same time.

Tighten the screw ① after adjusting the position.

(Supply a few drops of oil into the oil hole ② if needed.)

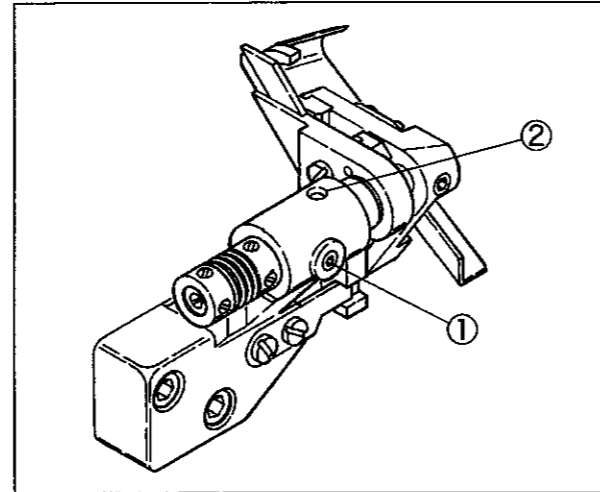


Fig. 22

WARNING

Before adjusting, ALWAYS turn the motor switch OFF and check that the motor has already stopped.

4.6 Trimming mechanism**4.6.1 Installing and removing lower knife****Removing lower knife:**

- (1) Loosen the screws ① of the collar(right).
- (2) Push the collar(left)② to the right to make the clearance between the upper and lower knives.
- (3) Tighten the screws ① slightly.
- (4) Loosen the screw ③ of the lower knife clamp and pull it out the lower knife ④.

Installing lower knife:

- (1) Position the lower knife ④ tip even with the top of the stitch plate and tighten the screw ③ securely.
- (2) Loosen the screws ①. (The upper knife engages with the lower knife by the spring.)
- (3) Put a thread between the upper and lower knives to check the sharpness of them while turning the pulley manually.
- (4) Tighten the screws ① securely.
- (5) Recheck the sharpness of the knives.

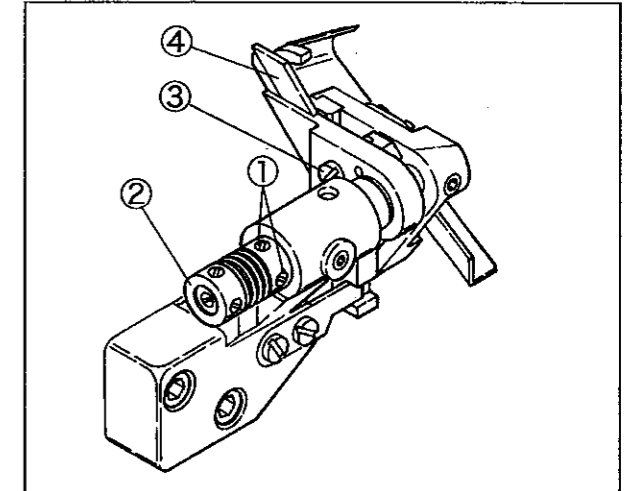


Fig. 23

4.6.2 Installing and removing upper knife**Removing upper knife:**

- (1) Loosen the screws ①.
- (2) Push the collar(left)② to the right to make the clearance between the upper and lower knives.
- (3) Tighten the screws ① slightly.
- (4) Loosen the screw ⑤ to remove the upper knife ⑥.

Installing upper knife:

- (1) Install the upper knife ⑥ with the screw ⑤.
- (2) Loosen the screws ①. (The upper knife engages with the lower knife by the spring.)
- (3) Put a thread between the upper and lower knives to check the sharpness of them while turning the pulley manually.
- (4) Tighten the screws ① securely.
- (5) Recheck the sharpness of the knives.

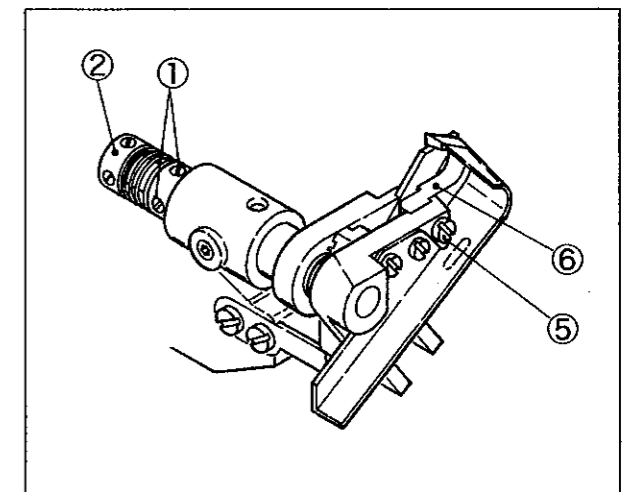


Fig. 24

